

FOR CROSS SECTION DETAILS, SEE GEO MEDIA ENGINEERING ALBION DYKE REPORT, DWG# G1221-3

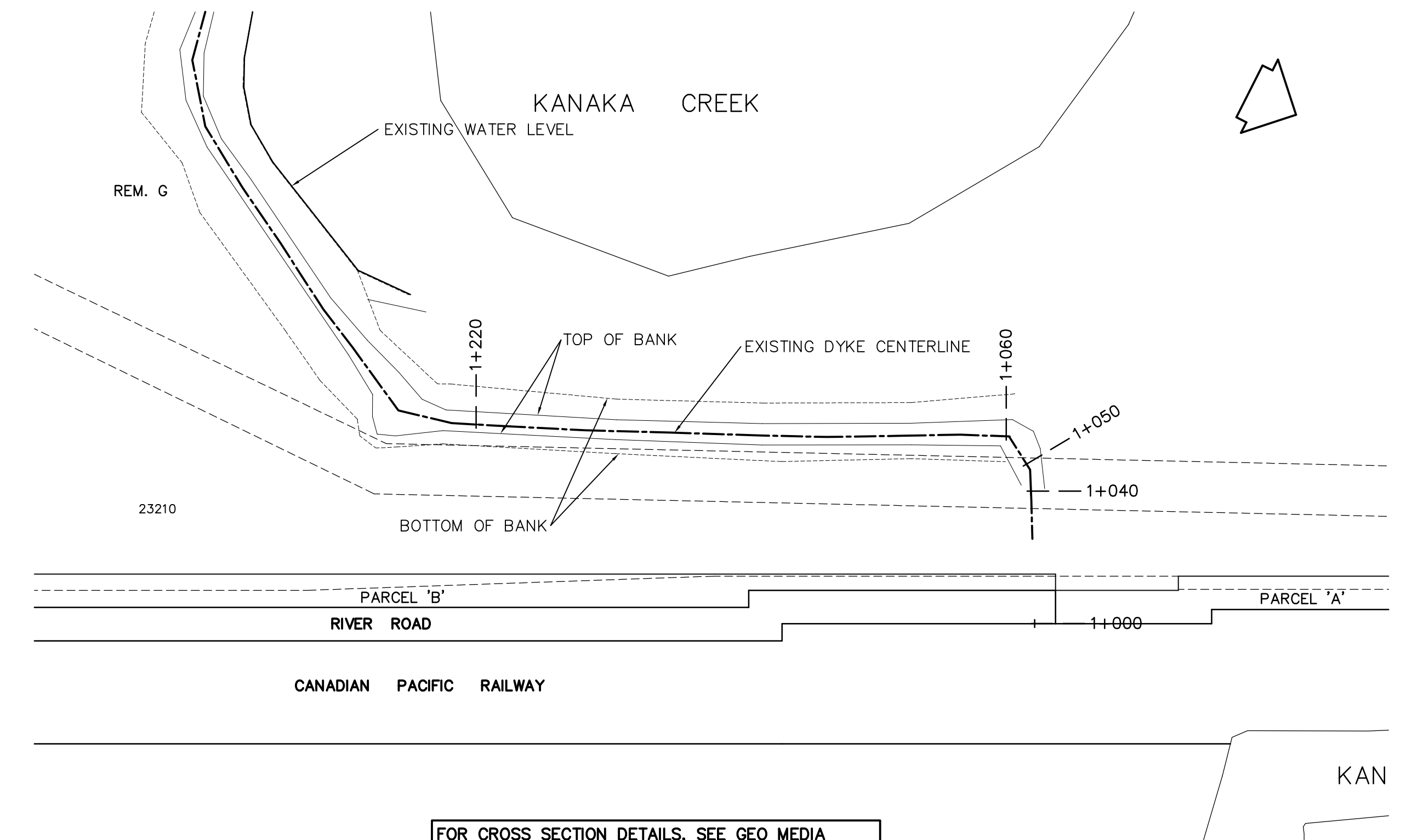

FOR CROSS SECTION DETAILS, SEE GEO MEDIA ENGINEERING ALBION DYKE REPORT, DWG# G1221-3

ALBION DYKE 2007-2

No.	DATE	REVISION	BY

BENCHMARK
 CONTROL MONUMENT: 84H0033
 LOCATION: INTERSECTION OF LOUGHEED HIGHWAY & HANEY BYPASS
 ELEVATION: 7.990m
 VERTICAL DATUM: NAD83 CSRS

- EXISTING PROPOSED
- STORM SEWER
- SANITARY SEWER
- GAS
- WATER
- U.G. LIGHTING
- U.G. HYDRO
- U.G. TELEPHONE
- MANHOLE
- CATCH BASIN
- WATER OR GAS VALVE

- DITCH
- UTILITY POLE / ANCHOR
- FIRE HYDRANT
- IRON PIN
- BASEMENT ELEV.
- EDGE OF PAVEMENT
- FENCE
- SIDEWALK
- SURVEY MONUMENT
- SAN. INSPECTION CHAMBER
- STREET LIGHT

- EDGE OF GRAVEL
- SLOPE
- SHRUB
- HEDGE
- TREE
- BUILDING

DRAWN P.M.
 DESIGNED XX
 CHECKED XX
 APPROVED
 SCALES
 HORZ. 1:2500
 VERT. 1:50

SEAL

CORPORATION OF THE DISTRICT OF MAPLE RIDGE
 ENGINEERING DEPARTMENT

ALBION DYKE

KANAKA CREEK (TAMARACK LANE - 190m SOUTH)
 KANAKA CREEK (60m W/O RIVER RD.-FRASER RIVER)

DATE: NOVEMBER 2007
 SHEET: 1 of 4
 DWG. No.:

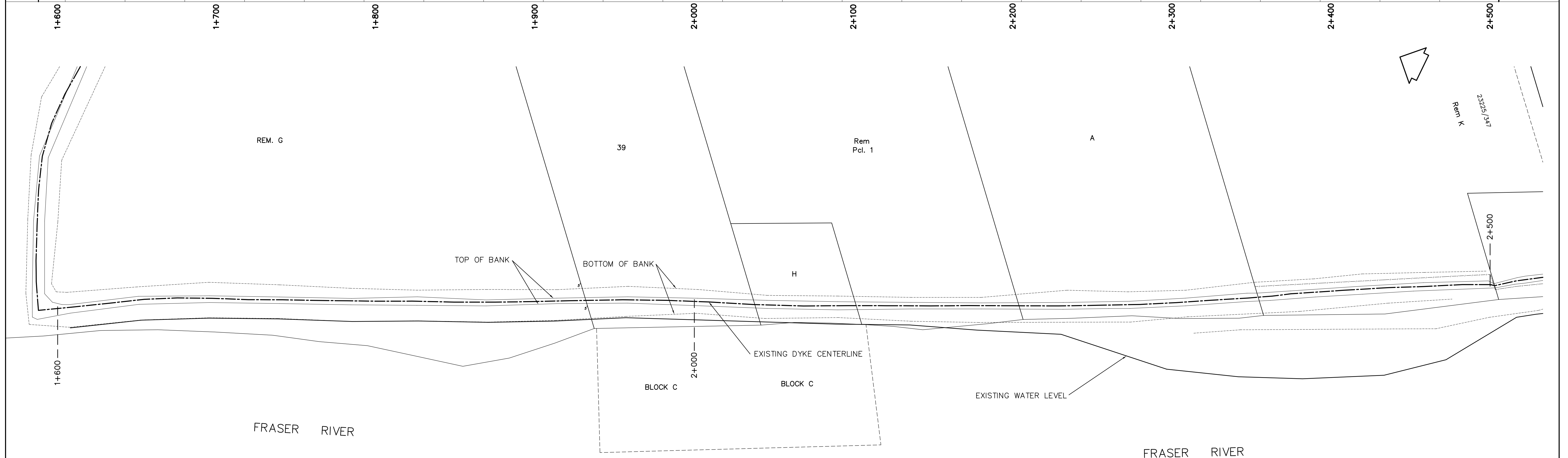
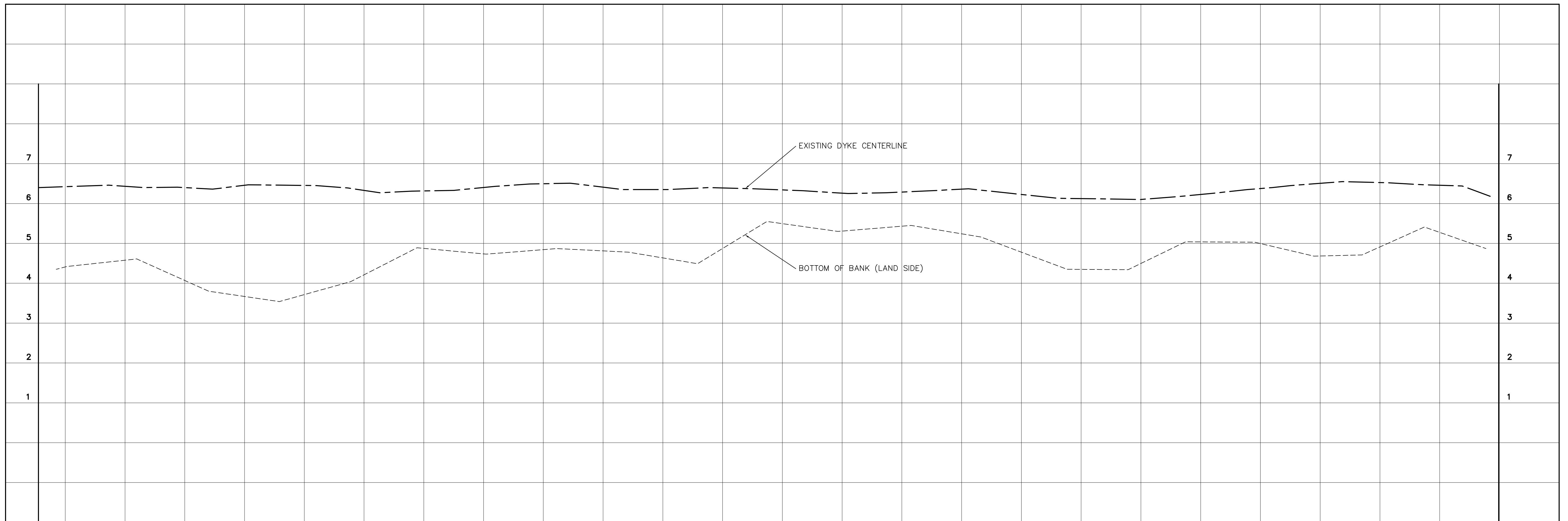

FOR CROSS SECTION DETAILS, SEE GEO MEDIA
ENGINEERING ALBION DYKE REPORT, DWG# G1221-3

ALBION DYKE 2007-1

No.	DATE	REVISION	BY

BENCHMARK
CONTROL MONUMENT: 84H0033
LOCATION: INTERSECTION OF
LOUGHEED HIGHWAY &
HANEY BYPASS

ELEVATION: 7.990m
VERTICAL DATUM: NAD83 CSRS

- EXISTING EXISTING
- PROPOSED PROPOSED
- STORM SEWER STM
- SANITARY SEWER SAN
- GAS GAS
- WATER W/M
- U.G. LIGHTING S/L
- U.G. HYDRANT HYD
- U.G. TELEPHONE TEL
- MANHOLE X
- CATCH BASIN X
- WATER OR GAS VALVE X

- DITCH DITCH
- UTILITY POLE / ANCHOR U
- FIRE HYDRANT F
- IRON PIN I.P.
- BASEMENT ELEV. B.E.
- EDGE OF PAVEMENT E.P.
- FENCE F
- SIDEWALK S
- SURVEY MONUMENT Δ
- SAN. INSPECTION CHAMBER S.I.C.
- STREET LIGHT S.L.

- EDGE OF GRAVEL E.G.
- SLOPE S
- TOP T
- TOE TOE
- SHRUB SHRUB
- HEDGE H
- TREE DECIDUOUS
- CONIFEROUS
- BUILDING BUILDING

DRAWN	P.M.
DESIGNED	XX
CHECKED	XX
APPROVED	
SCALES	
HORIZ.	1:2500
VERT.	1:50

SEAL

CORPORATION OF THE DISTRICT OF MAPLE RIDGE
ENGINEERING DEPARTMENT

ALBION DYKE
FRASER RIVER
60m N/O - 880m N/O MCKAY AVENUE

DATE	NOVEMBER 2007
SHEET	2 OF 4
DWG. No.	

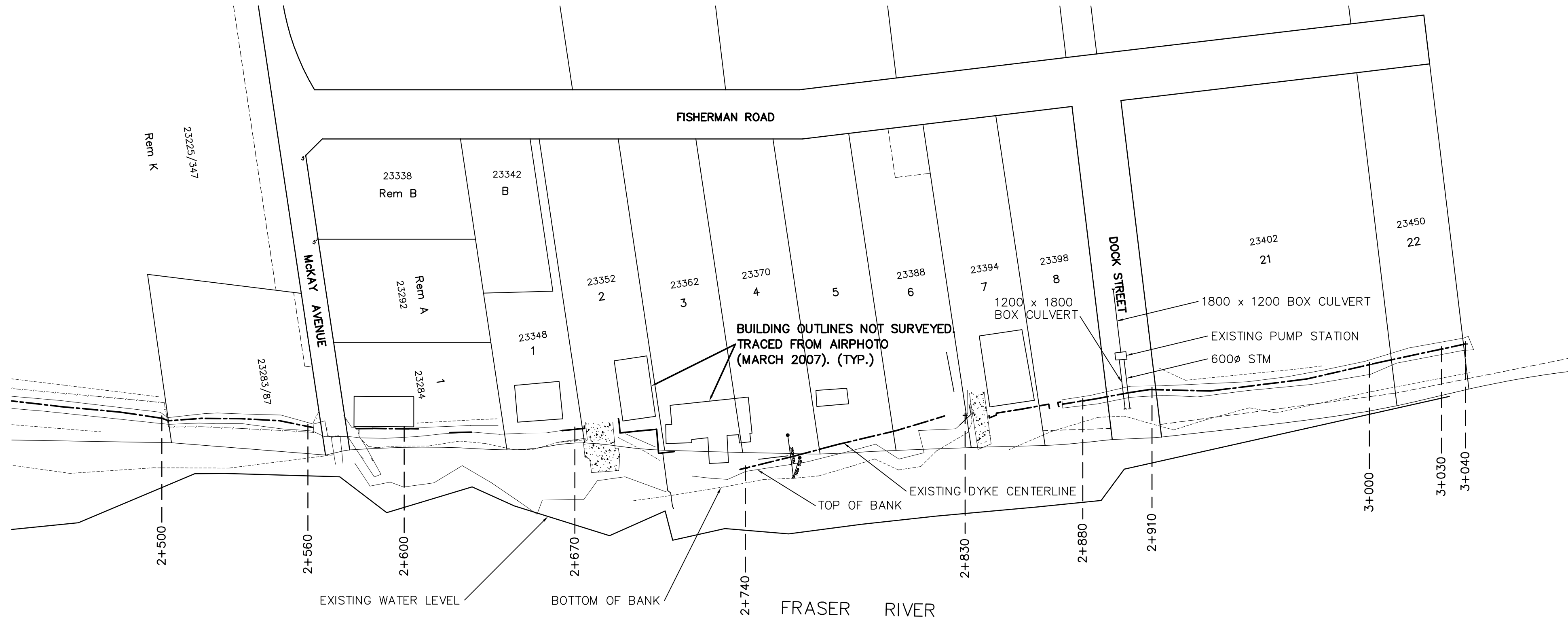
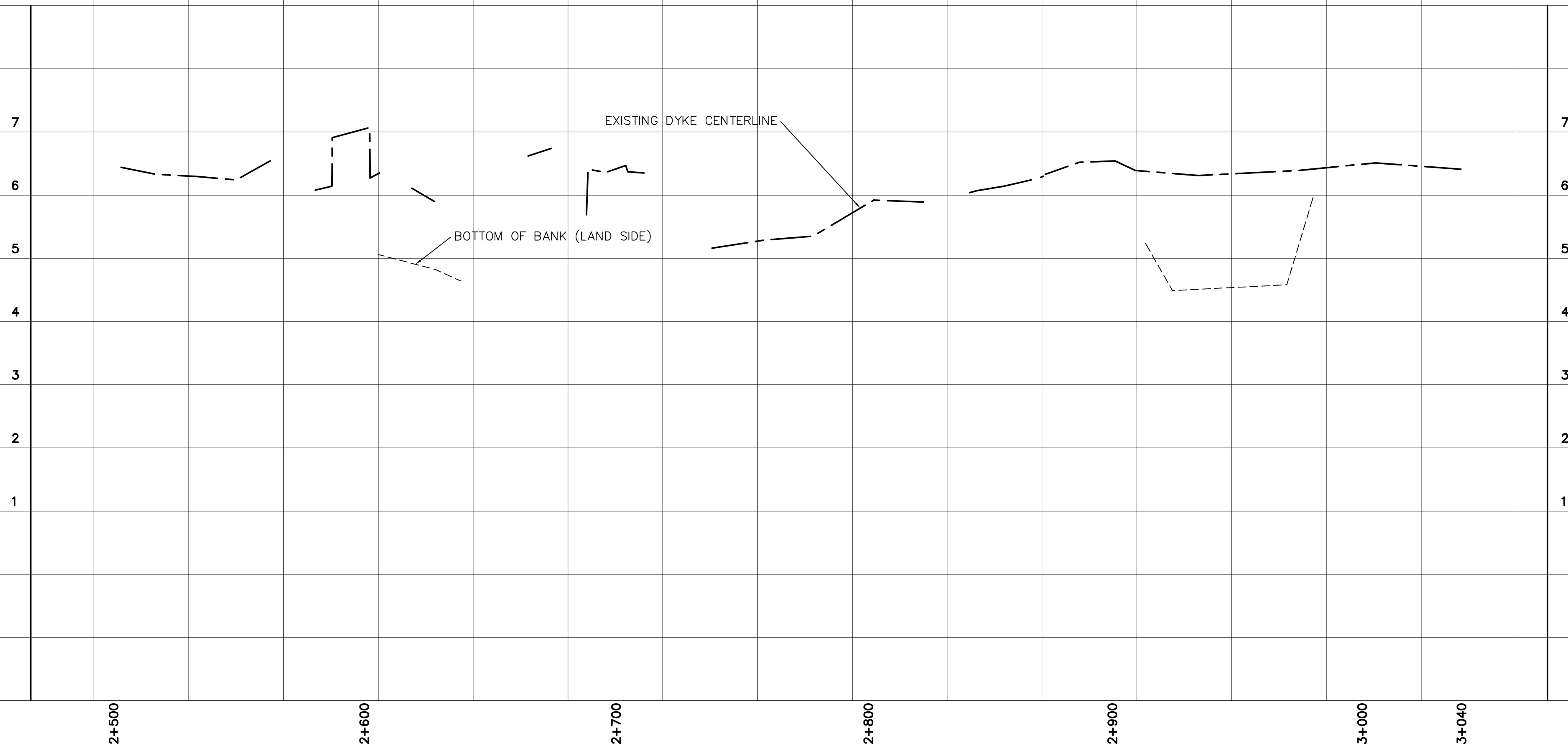

FOR CROSS SECTION DETAILS, SEE GEO MEDIA
ENGINEERING ALBION DYKE REPORT, DWG# G1221-3

ALBION DYKE 2007-0

No.	DATE	REVISION	BY

BENCHMARK
CONTROL MONUMENT: 84H0033
LOCATION: INTERSECTION OF
LOUGHEED HIGHWAY &
HANEY BYPASS

ELEVATION: 7.990m
VERTICAL DATUM: NAD83 CSRS

- EXISTING STIM
- PROPOSED STIM
- SANITARY SEWER
- GAS
- WATER
- U.G. LIGHTING
- U.G. HYDRO
- U.G. TELEPHONE
- MANHOLE
- CATCH BASIN
- WATER OR GAS VALVE

- DITCH
- UTILITY POLE / ANCHOR
- FIRE HYDRANT
- IRON PIN
- BASEMENT ELEV.
- EDGE OF PAVEMENT
- FENCE
- SIDEWALK
- SURVEY MONUMENT
- SAN. INSPECTION CHAMBER
- STREET LIGHT

- EDGE OF GRAVEL
- SLOPE
- SHRUB
- HEDGE
- TREE
- BUILDING

DRAWN P.M.
DESIGNED XX
CHECKED XX
APPROVED
SCALES
HORZ. 1:2500
VERT. 1:50

SEAL

CORPORATION OF THE DISTRICT OF MAPLE RIDGE
ENGINEERING DEPARTMENT

ALBION DYKE
FRASER RIVER
60m N/O MCKAY AVE. - 130m S/O DOCK ST.

DATE: NOVEMBER 2007
SHEET: 3 of 4
DWG. No.:

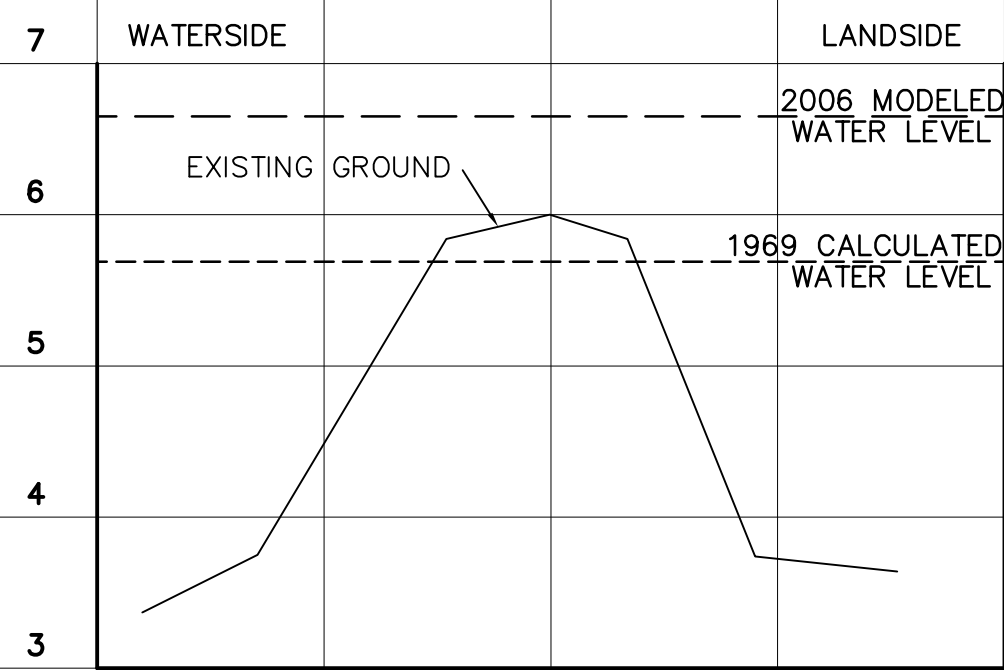

CROSS SECTION AT STATION 1+178

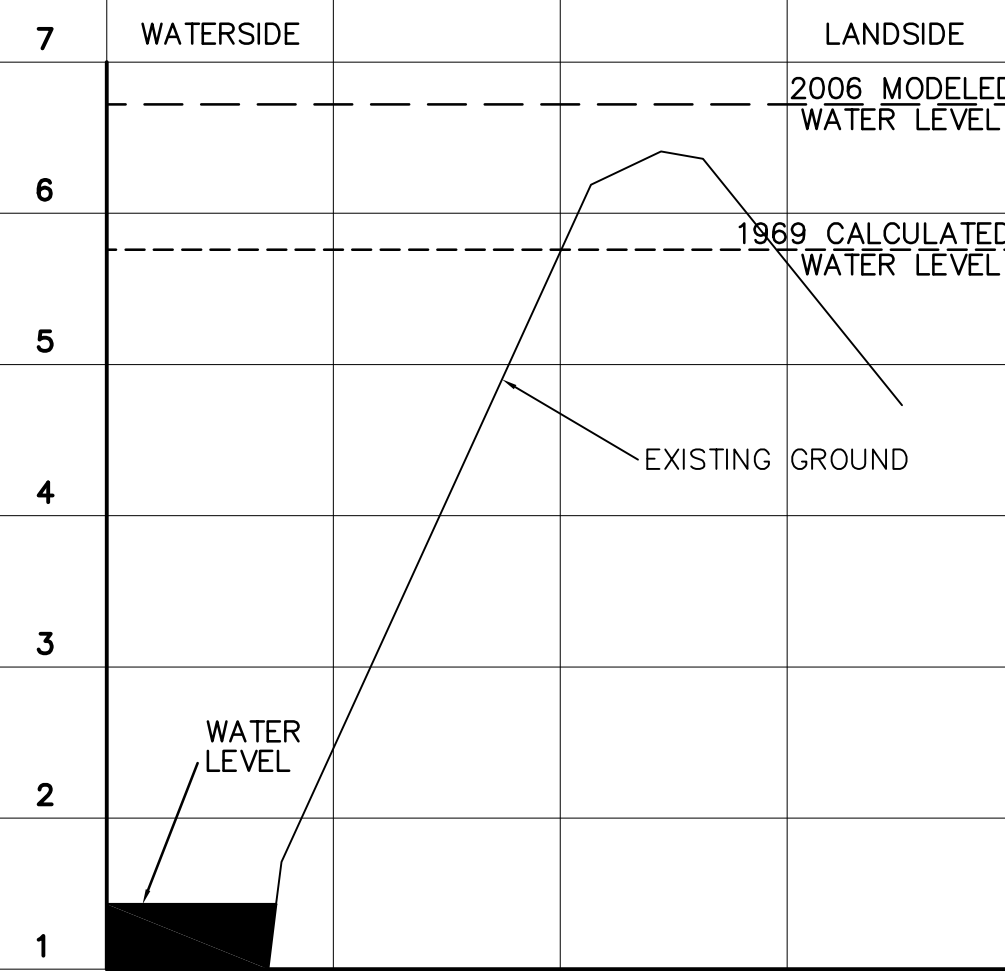

CROSS SECTION AT STATION 1+871

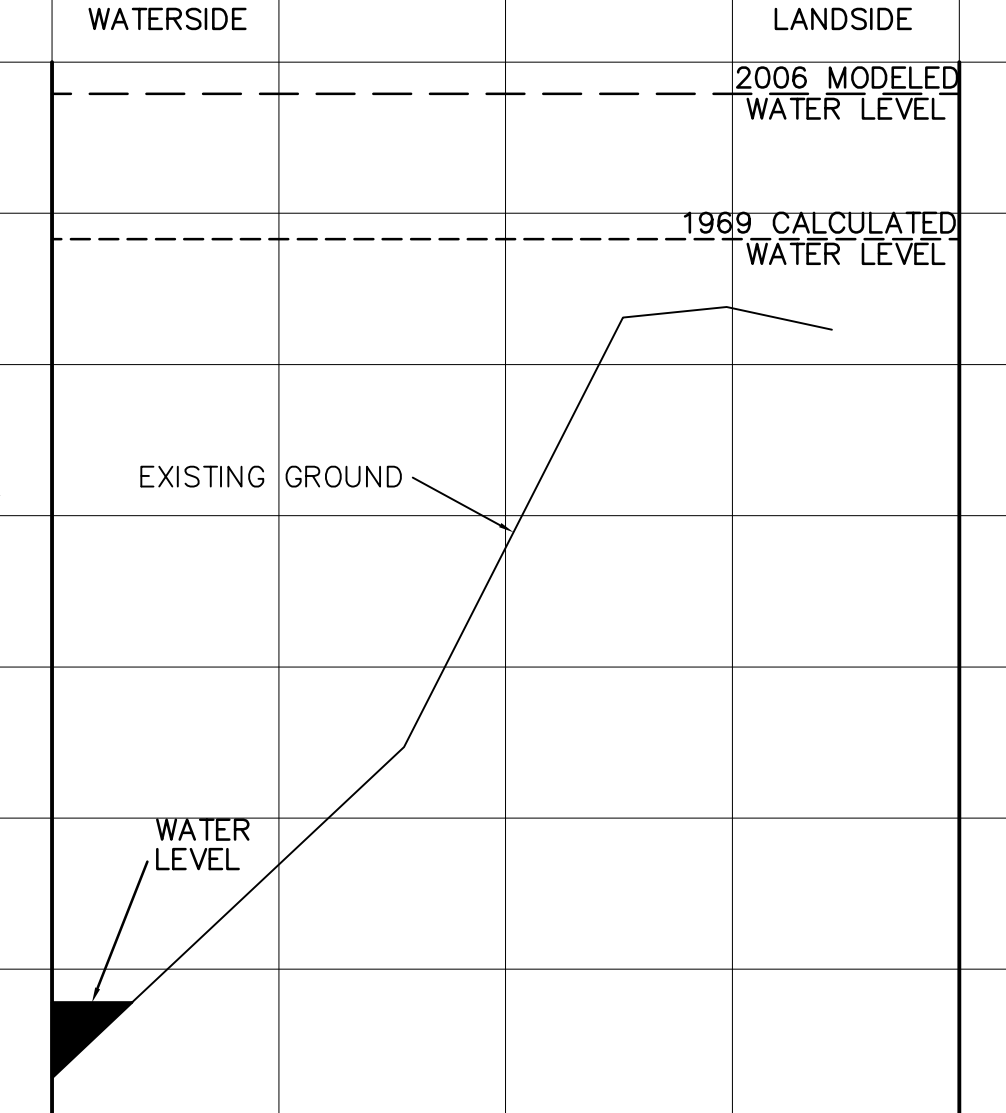

CROSS SECTION AT STATION 2+589 (McKAY AVENUE)

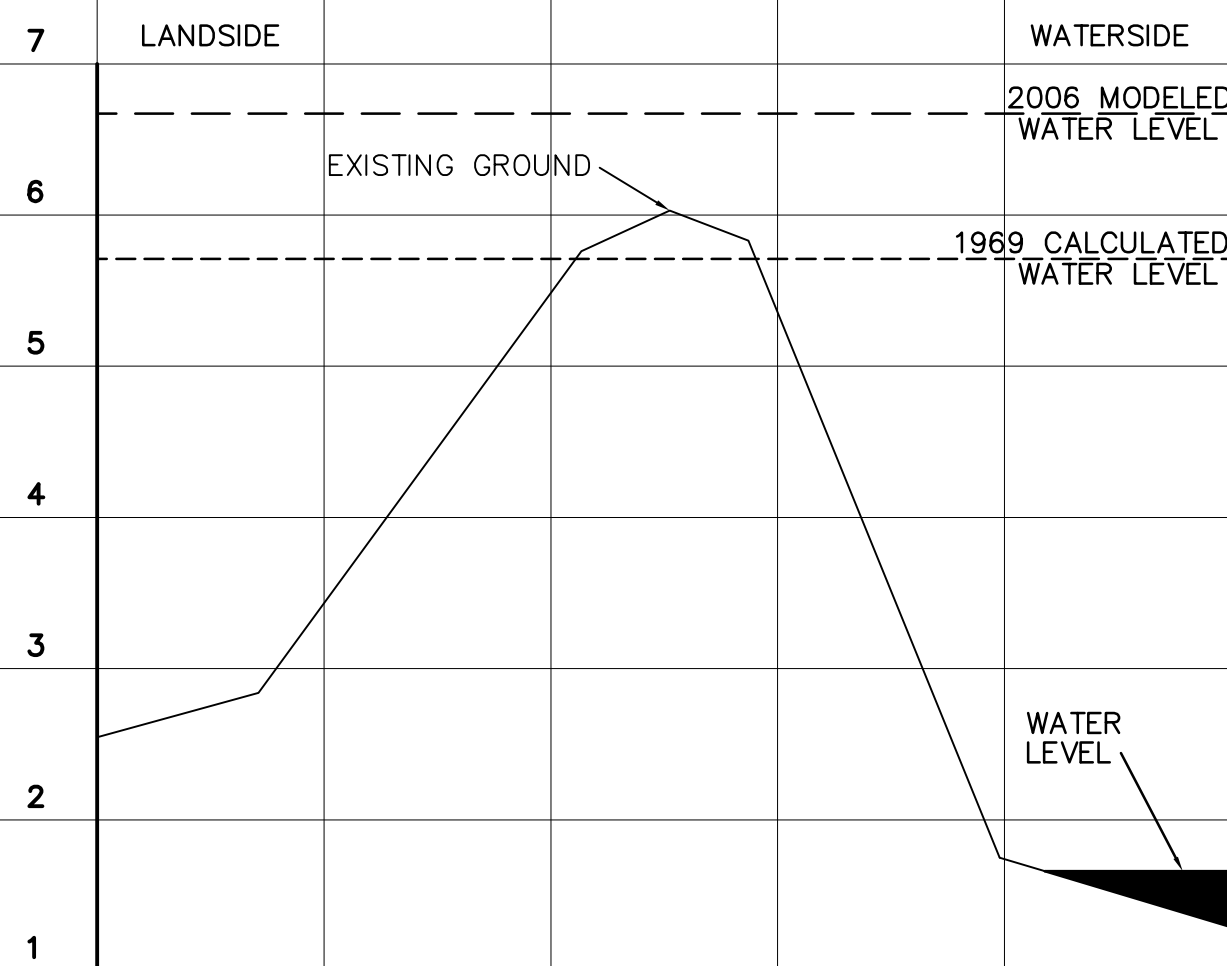

CROSS SECTION AT STATION 1+417

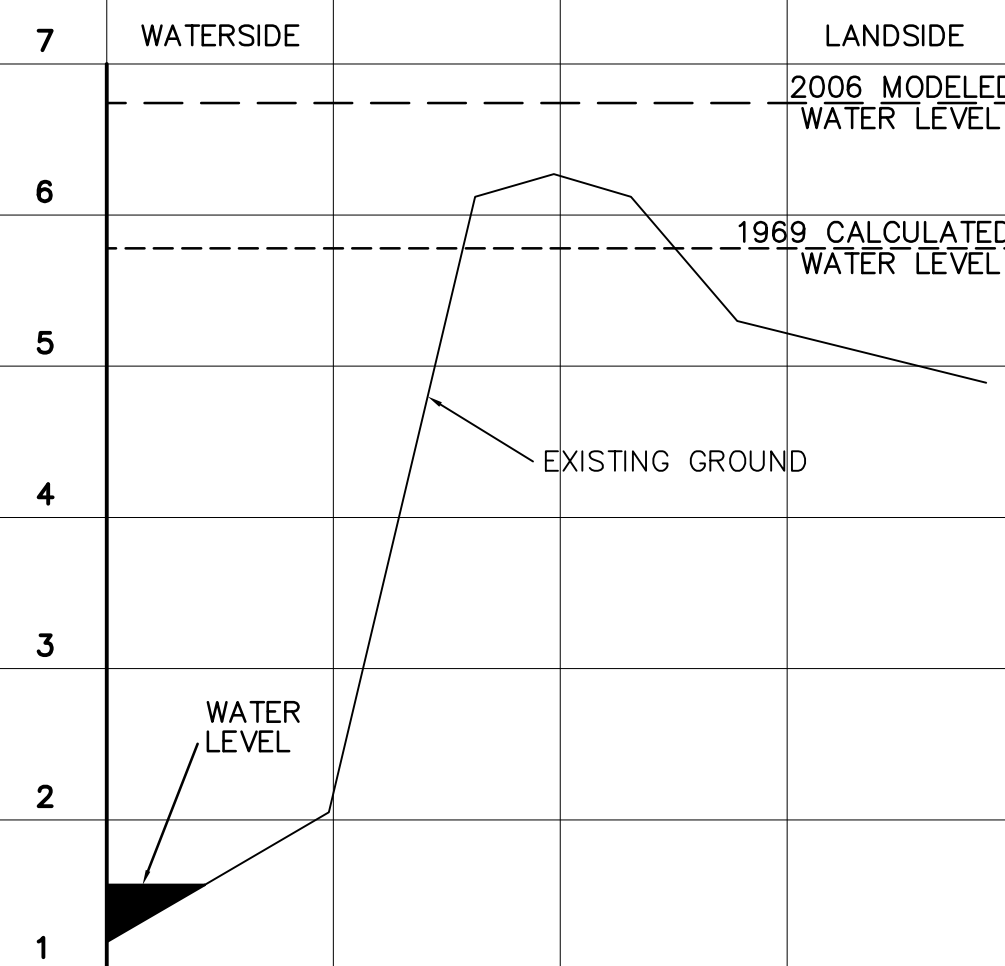

CROSS SECTION AT STATION 2+090

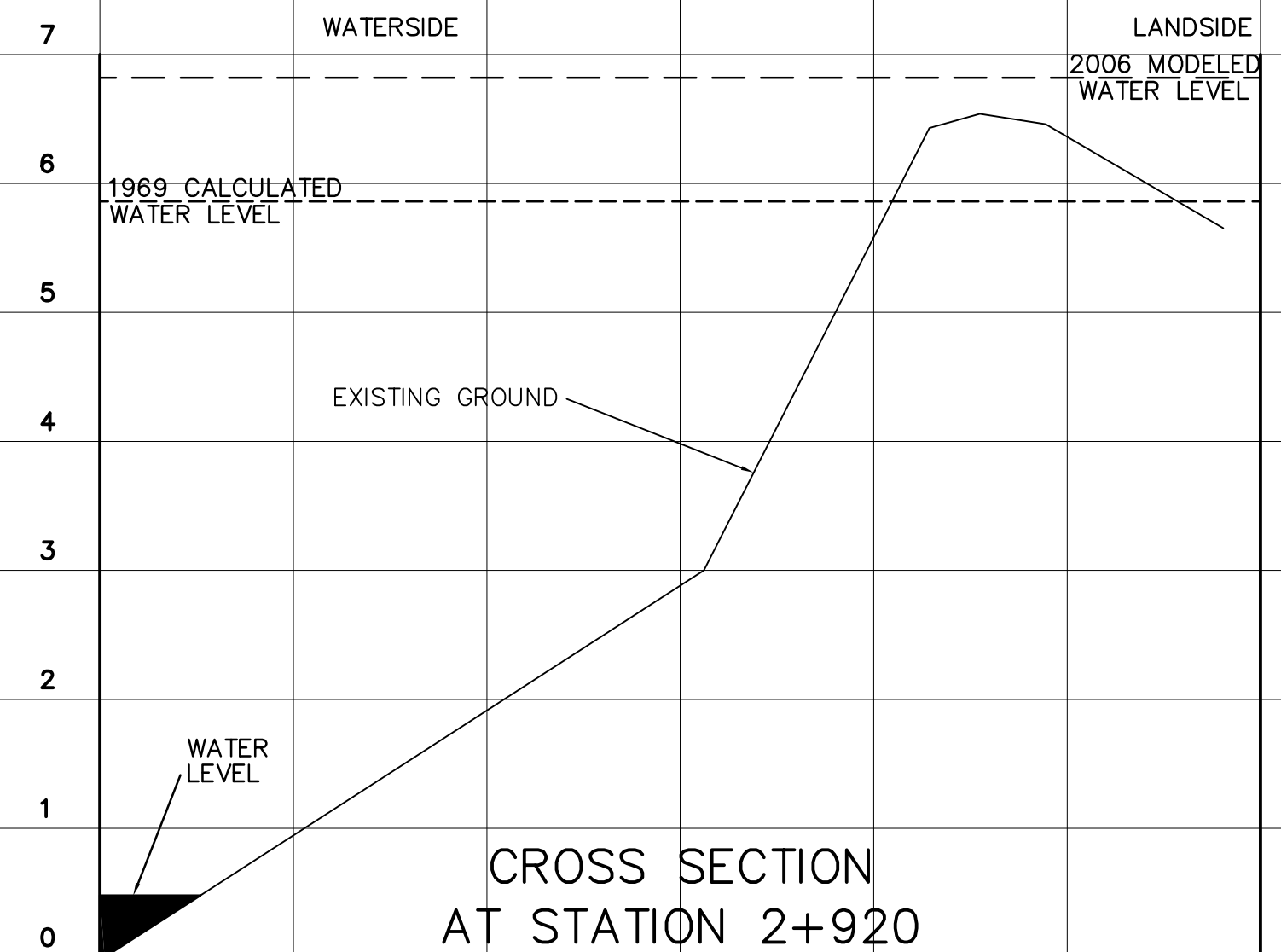

CROSS SECTION AT STATION 2+920

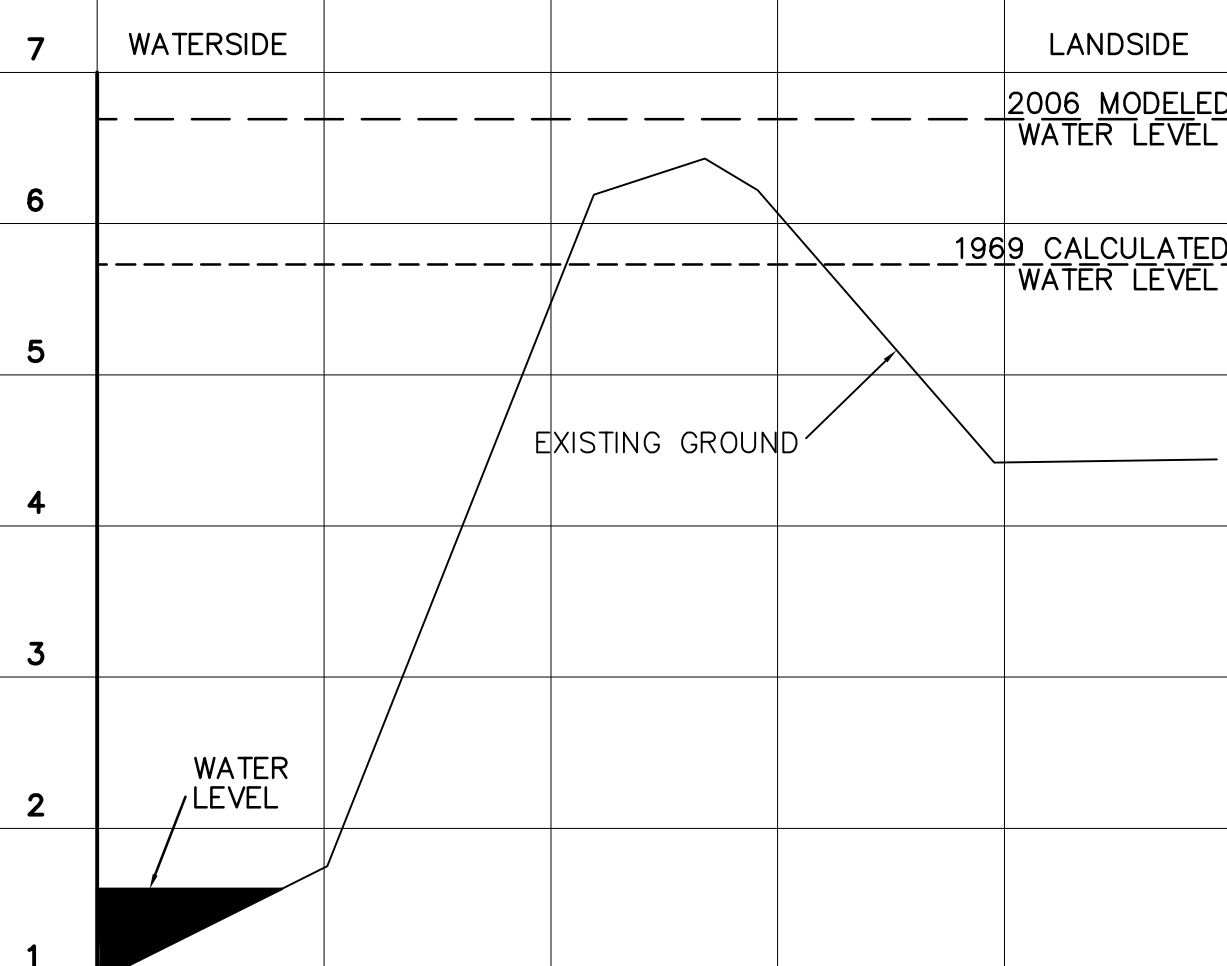

CROSS SECTION AT STATION 1+607

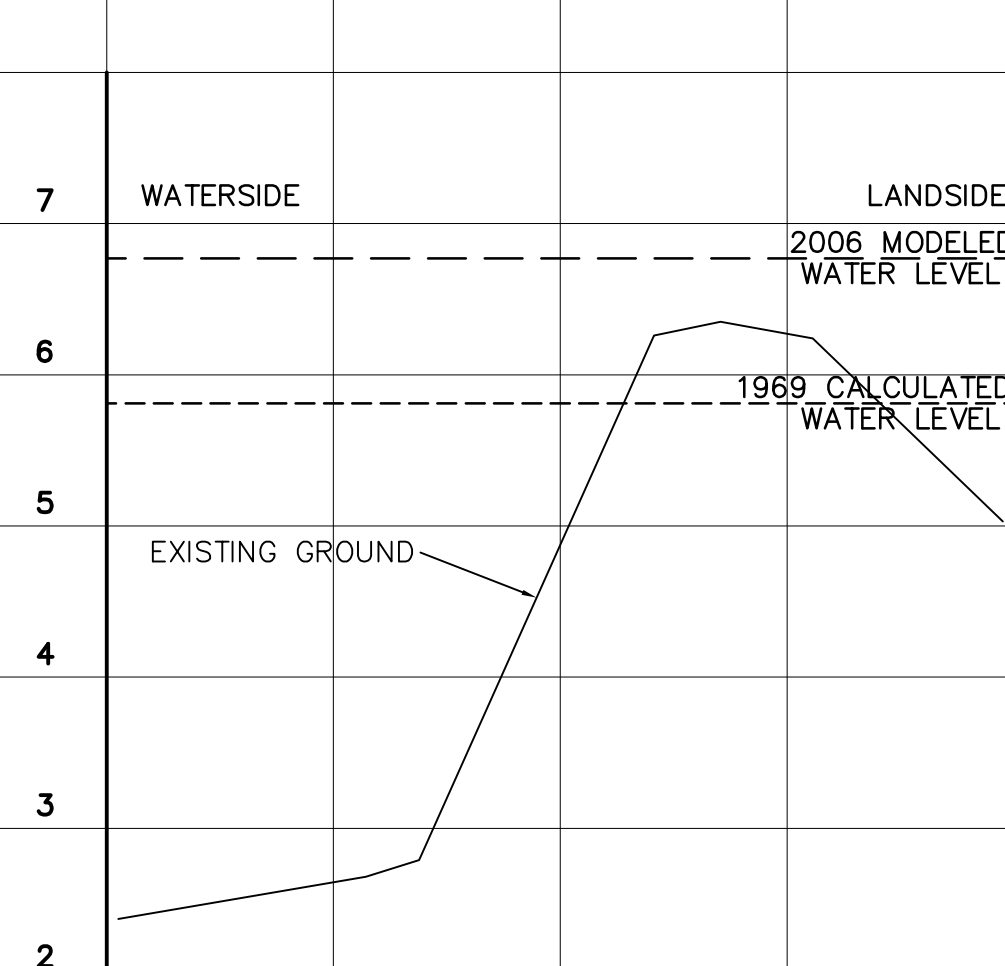

CROSS SECTION AT STATION 2+373

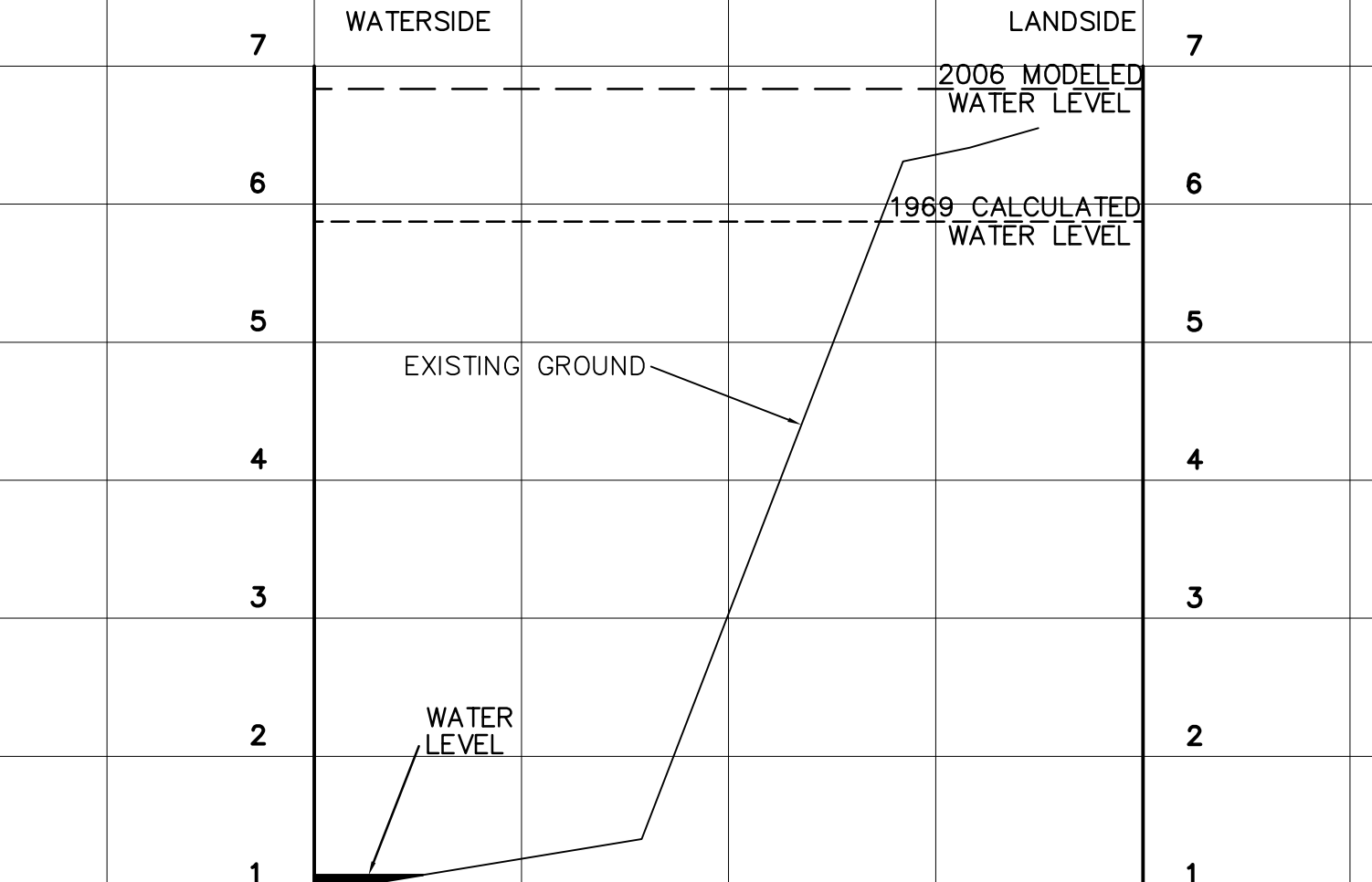

CROSS SECTION AT STATION 3+040

ALBION DYKE 2007-3

No.	DATE	REVISION	BY

BENCHMARK
 CONTROL MONUMENT: 84H0033
 LOCATION: INTERSECTION OF LOUGHEED HIGHWAY & HANEY BYPASS
 ELEVATION: 7.990m
 VERTICAL DATUM: NAD83 CSRS

EXISTING
 PROPOSED
 STORM SEWER
 SANITARY SEWER
 GAS
 WATER
 U.G. LIGHTING
 U.G. HYDRANT
 U.G. TELEPHONE
 MANHOLE
 CATCH BASIN
 WATER OR GAS VALVE

STIM
 SAN
 GAS
 W/M
 S/L
 HYD
 TEL
 X

DITCH
 UTILITY POLE / ANCHOR
 FIRE HYDRANT
 IRON PIN
 BASEMENT ELEV.
 EDGE OF PAVEMENT
 FENCE
 SIDEWALK
 SURVEY MONUMENT
 SAN. INSPECTION CHAMBER
 STREET LIGHT

LEFT
 RIGHT
 T

EDGE OF GRAVEL
 SLOPE
 SHRUB
 HEDGE
 TREE
 BUILDING

TOP
 TOE
 DECIDUOUS
 CONIFEROUS

DRAWN P.M.
 DESIGNED XX
 CHECKED XX
 APPROVED
 SCALES
 HORZ. 1:500
 VERT. 1:50

SEAL

CORPORATION OF THE DISTRICT OF MAPLE RIDGE
 ENGINEERING DEPARTMENT
CROSS SECTIONS
 ALBION DYKE
 KANAKA CREEK - 130m S/O DOCK STREET
 DATE NOVEMBER 2007
 SHEET 4 of 4
 DWG. No.