

CONDITIONAL WATER LICENCE

The owners of the land to which this licence is appurtenant are hereby authorized to divert and use water as follows:

- (a) The source on which the rights are granted is Beaton Creek and the reservoir is Beaton Lake.
- (b) The storage site and points of diversion and re-diversion are located as shown on the attached plan.
- (c) The date from which this licence shall have precedence is 29th February, 1896.
- (d) The purposes for which this licence is issued are storage and irrigation.
- (e) The maximum quantity of water which may be diverted for storage and irrigation purposes is 78 acre feet per annum.
- (f) The period of the year during which the water may be diverted into storage purpose is 1st November to 1st June and used for irrigation purpose is 1st April to 30th September.
- (g) The land upon which the water is to be used and to which this licence is appurtenant is Legal Subdivisions 3 and 4, Section 13, Township 20, Range 20, West of the Sixth Meridian, Kamloops Division Yale District, of which 26 acres may be irrigated.
- (h) The authorized works are diversion structures, ditches, dam, pumps, pipe and sprinkler system which shall be located approximately as shown on the attached plan.
- (i) The construction of the said works has been completed and the water is being used. The licensee shall continue to make regular beneficial use of the water in the manner authorized herein.
- (j) This licence is issued pursuant to the provisions of the Water Act to ensure compliance with that statute, which makes it an offence to divert or use water from a stream in British Columbia without proper authorization. It is the responsibility of the licensee to ensure that all activities conducted under this authorization are carried out with regard to the rights of third parties, and comply with other applicable legislation that may be in force.
- (k) The rights granted by this licence are included on the Certificate of Incorporation for the Beaton Creek Water Users' Community. Membership in the Water Users' Community is a condition of this licence.
- (l) This licence is issued in substitution of Conditional Water Licence 65862.



Bruce E. Madu
Assistant Regional Water Manager
Southern Service Region – Kamloops Service Centre
Land & Water Management Division

PERMIT UNDER THE WATER ACT AUTHORIZING THE OCCUPATION OF CROWN LAND

The holder of Conditional Water Licence 121071 whose licence authorizes the diversion and use of water from Beaton Creek and the reservoir is Beaton Lake, is hereby authorized to occupy Crown land by constructing, maintaining and operating thereon the works authorized under the said licence.

- (a) The Crown land which is authorized to be occupied under this permit is a portion of the South West $\frac{1}{4}$, Section 7, Township 20, Range 19 and the East $\frac{1}{2}$, Section 12, Township 20, Range 20 and North West $\frac{1}{4}$, Section 31, Township 19, Range 19, all West of the Sixth Meridian, Kamloops Division Yale District, the location of which is shown approximately on the plan attached to the said water licence.
- (b) The approximate dimensions of the Crown land authorized to be occupied under this permit are ditch from west channel to Beaton Lake 1450 feet (442.3 metres) in length by 15 feet (4.6 metres) in width for an area of 0.50 acre (0.20 hectare).

Ditch from PD51028 to west channel 500 feet (152 metres) in length by 15 feet (4.6 metres) in width for an area of 0.17 acre (0.07 hectare).

Flooding band around Beaton Lake for an area of 13.6 acres (5.50 hectares).

Damsite on Beaton Lake for an area of 1.00 acre (0.40 hectare).

Total: 15.27 acres (6.17 hectares).

- (c) Prior to the cutting or destruction or flooding of any timber necessary to permit construction and maintenance of the said works and clearing of the said lands which may be flooded, the permittee shall apply for and obtain a licence to cut timber from the Ministry of Forests, District Manager. The amount of stumpage, royalty and/or compensation payable to the Crown in respect of trees, including merchantable or young growth, cut, removed, damaged, or destroyed by the permittee, shall be the sum or sums fixed by the Forest Service of the Province of British Columbia.
- (d) This permit is appurtenant to the land, mine, or undertaking to which the aforesaid water licence is appurtenant.
- (e) This permit shall become void if the water licence with respect to which the permit is issued should terminate, be abandoned or cancelled, or amended so as to render this permit unnecessary.
- (f) This permit is issued and accepted on the understanding that the permittee shall indemnify and save harmless the Government of the Province of British Columbia for all loss, damage to works, cost or expense suffered by the permittee by reason of the Crown land or any portion thereof being submerged or damaged by erosion or otherwise affected by flooding.
- (g) The holder of this permit shall not be entitled to compensation if the Crown grants permits to other persons to occupy the land affected by this permit.
- (h) In the event of a dispute at any time with respect to the area or boundaries of the land affected by this permit, the holder shall, at his own expense, have the said land surveyed by a duly authorized surveyor.
- (i) This permit replaces Permit No. 16596.



Bruce E. Madu
Assistant Regional Water Manager
Southern Service Region – Kamloops Service Centre
Land & Water Management Division

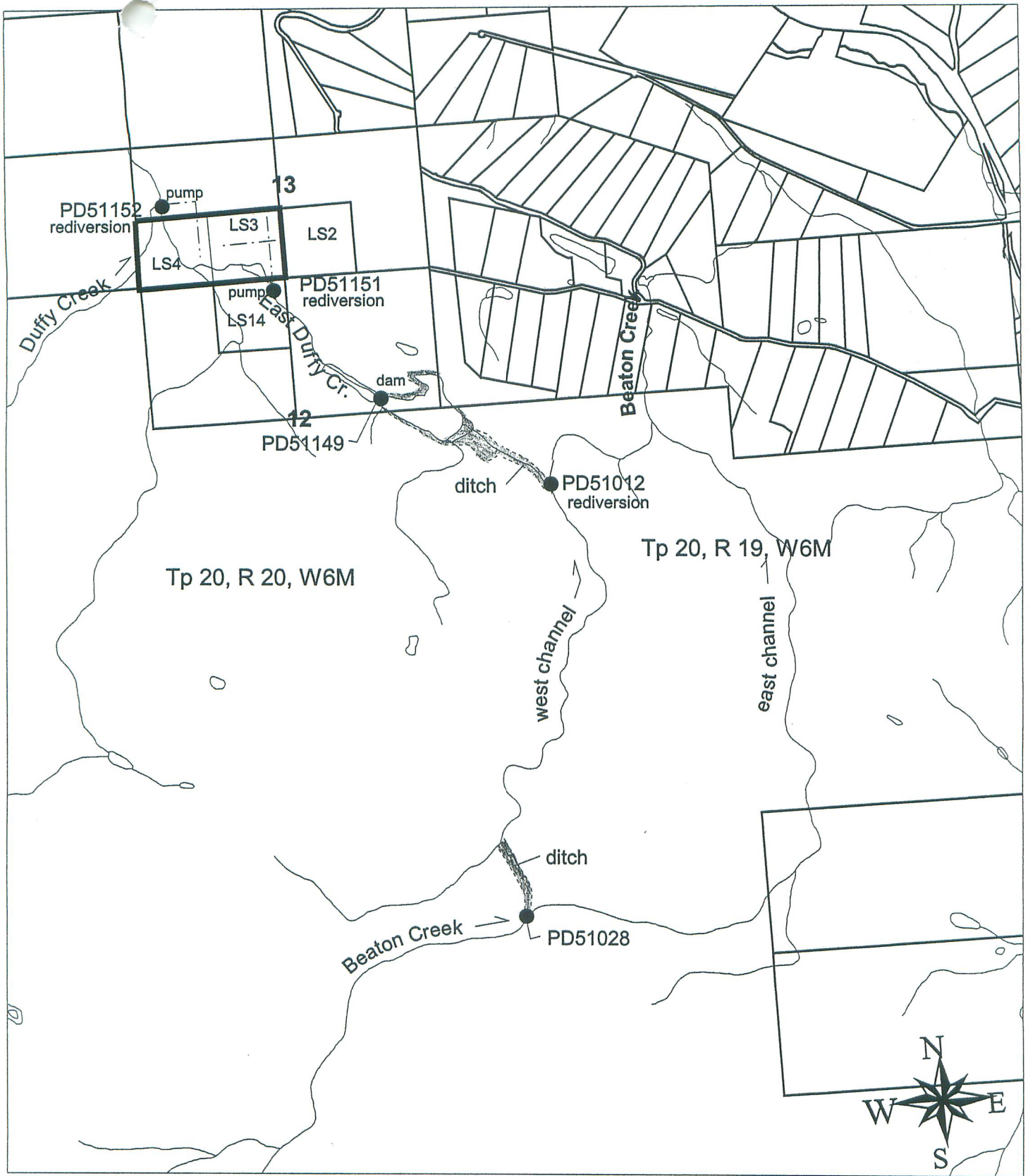

WATER DISTRICT:
 PRECINCT:
 LAND DISTRICT:

KAMLOOPS
 KAMLOOPS
 KDYD

Signature: 
 Date: AUGUST 18 2005

LEGEND:

Scale: 1:30,000
 Point of Diversion: ●
 Map Number: WR 3756 & 3753
 Pipe: ————
 Permit over Crown Land: 

C.L. 121071
 File 0241532
 P.C.L 25359

The boundaries of the land to which this licence is appurtenant are shown thus: 