



Province of British Columbia

Water Act

CONDITIONAL WATER LICENCE

British Columbia Hydro and Power Authority is hereby authorized to divert and use water as follows:

- a) The stream on which the rights are granted is Peace River.
- b) The point of diversion on Peace River is denoted by PD36283 and is shown on the attached plan.
- c) The date from which this licence shall have precedence is January 11, 2008.
- d) The purpose for which this licence is issued is power and the category for the power is general. The power is to be generated at the Site C Generating Station.
- e) The maximum quantity of water which may be diverted and used under this licence is 2,700.00 cubic-meters-per-second (cms), subject to the following:
The licensee shall maintain in Peace River, measured immediately downstream of the point of diversion:
 - 1) a minimum flow of 390.00 cms; or,
 - 2) a minimum flow as ordered by an Engineer under the *Water Act* (the "Engineer").
- f) The water may be diverted and used throughout the whole year.
- g) This licence is appurtenant to:
 - 1) the undertaking of British Columbia Hydro and Power Authority to construct and operate the Site C Clean Energy Project approved under Environmental Assessment Certificate E14-02, issued under the Environmental Assessment Act; and,
 - 2) the land upon which the powerhouse of the Site C Generating Station is to be located.
- h) The works authorized for the Site C Generating System are:
 - 1) an approach channel;
 - 2) an intake;
 - 3) a dam;
 - 4) spillways;
 - 5) a powerhouse and tailrace; and
 - 6) an access road,which shall be located approximately as shown on the attached plan; and
 - 7) ancillary works associated with operation of the dam and generating station.

- i) The dam authorized under clause (h) is subject to the Dam Safety Regulations and shall be designed, constructed and maintained, including any alterations, to the satisfaction of a Dam Safety Officer under the *Water Act* (the "Dam Safety Officer") and in accordance with the *Canadian Dam Association Guidelines*.
- j) Before commencing construction of the works authorized under clause (h) of this licence, the licensee must to the satisfaction of the Comptroller of Water Rights:
 - 1) retain a professional engineer registered in the province of British Columbia (the "Independent Engineer") who will provide services to the Engineer for the regulation of construction of the works (Attachment A);
 - 2) retain a person with professional qualifications (the "Independent Environmental Monitor") who will monitor environmental impacts from the construction of works (Attachment B);
 - 3) submit, the following:
 - a. plans that show the general arrangement of the works;
 - b. criteria for the design of the works;
 - c. criteria for the operation of the works;
 - d. a schedule for the construction of the works;
 - e. an environmental management plan (CEMP) for the management and mitigation of construction impacts;
 - 4) complete all monitoring, mitigation and compensation projects required for each Leave to Commence Construction, as specified in Schedule A; and
 - 5) obtain Leave to Commence Construction (LCC) in writing from the Engineer.
- k) Before undertaking construction of any component of works for which a LCC has been issued under (j) 5), the licensee must:
 - 1) ensure that the design drawings for the works to be constructed are signed and sealed by a professional engineer registered in the province of British Columbia (the "Design Engineer");
 - 2) ensure that a professional engineer registered in the province of British Columbia (the "Construction Engineer") supervises the construction of the works; and
 - 3) obtain a letter from the Independent Engineer that the actual construction of that component work may proceed.
- l) The construction of the said works must not commence until a draft Operation, Maintenance and Surveillance Manual (including a surveillance schedule for first filling) and an Emergency Preparedness Plan have been submitted to the satisfaction of the Dam Safety Officer.
- m) Before commencing operation of the works authorized under clause (h), the licensee must to the satisfaction of the Engineer:
 - 1) submit a report on the parameters and procedures for the operation of the works;
 - 2) submit and implement an environmental management plan (OEMP) for the management and mitigation of operational impacts;

- 3) submit and implement a plan for the measurement of in-stream flows and of the flow of water diverted from the stream under this licence; and
 - 4) obtain leave to commence the diversion and use of water authorized in this licence in writing from the Engineer.
- n) The licensee must operate the works authorized under clause (h) in accordance with:
- 1) procedures ordered by the Engineer, including any order for the regulation of the diversion, rate of diversion and use of water as may be required for the preservation of fish and wildlife; and
 - 2) any amendment of the procedures ordered by the Engineer.
- o) Remedial measures for the protection or enhancement of fisheries and wildlife habitat shall be carried out as directed by the Comptroller of Water Rights after consultation with the licensee and fisheries and wildlife agencies. The remedial measures include programmes such as an adequately funded Peace Site C Fish and Wildlife Compensation Program and other studies related to these resource values, which pertain to the impacts of construction, footprint, and continuing operations of the project. The licensee is required to assess the extent of these impacts at the end of the first five years of operation and report to the Comptroller of Water Rights on whether compensation funding is adequate to address these impacts. Should funding for fish and wildlife protection or enhancements and compensation programmes be inadequate to meet objectives in a timely manner, the licensee may be directed to provide additional funding.
- p) At the discretion of the Comptroller of Water Rights, the licensee's rights issued under this licence may be deemed to be subsequent to any rights granted under any licence or licences which may be issued at any time for the consumptive use of water.
- q) The licensee must:
- 1) replace intakes, wells or other diversion works of persons authorized to divert or use water, who hold earlier dates of precedence (whether licensed, authorized or deemed) than that of this licence, and whose works are used for diversion or use of water within the area impacted by the project, if the undertaking authorized by this licence will have a significant adverse impact on the source of their water supply, or the proper operation or use of those works, or otherwise prevent their continued operation or use for the purpose or in the manner intended for water supply to those impacted water users; and
 - 2) if, in particular cases, it is not feasible or practicable to replace those intakes, wells or other diversion works, as described in clause (q) 1), the licensee must instead provide interim water supply to such impacted water users until such time as an alternative source of water supply can be determined and must assist such impacted water users to secure replacement rights, whether licensed, authorized or deemed, or to secure access to an alternative source of water supply in place of their impacted intake, wells or other diversion works and impacted source of water supply, as may be required to replace that water supply or to enable its use for the purpose and manner required by those impacted water users, including by installing any additional works required for that purpose.

- r) Submit to the Engineer, and as directed by the Engineer, within six months of receiving the leave to commence the diversion and use of water, the drawings of record that show the works as they were constructed.
- s) Final Operation, Maintenance and Surveillance Manual and Emergency Preparedness Plan must be submitted to the satisfaction of the Dam Safety Officer during the first year of operation.
- t) The construction of works authorized in clause (h) shall be completed and the water shall be beneficially used prior to December 31, 2025. Thereafter, the licensee shall continue to make regular and beneficial use of the water in a manner authorized herein.
- u) The term of this licence is 40 years from the date of issuance of this licence.



Pieter Bekker
Deputy Comptroller of Water Rights

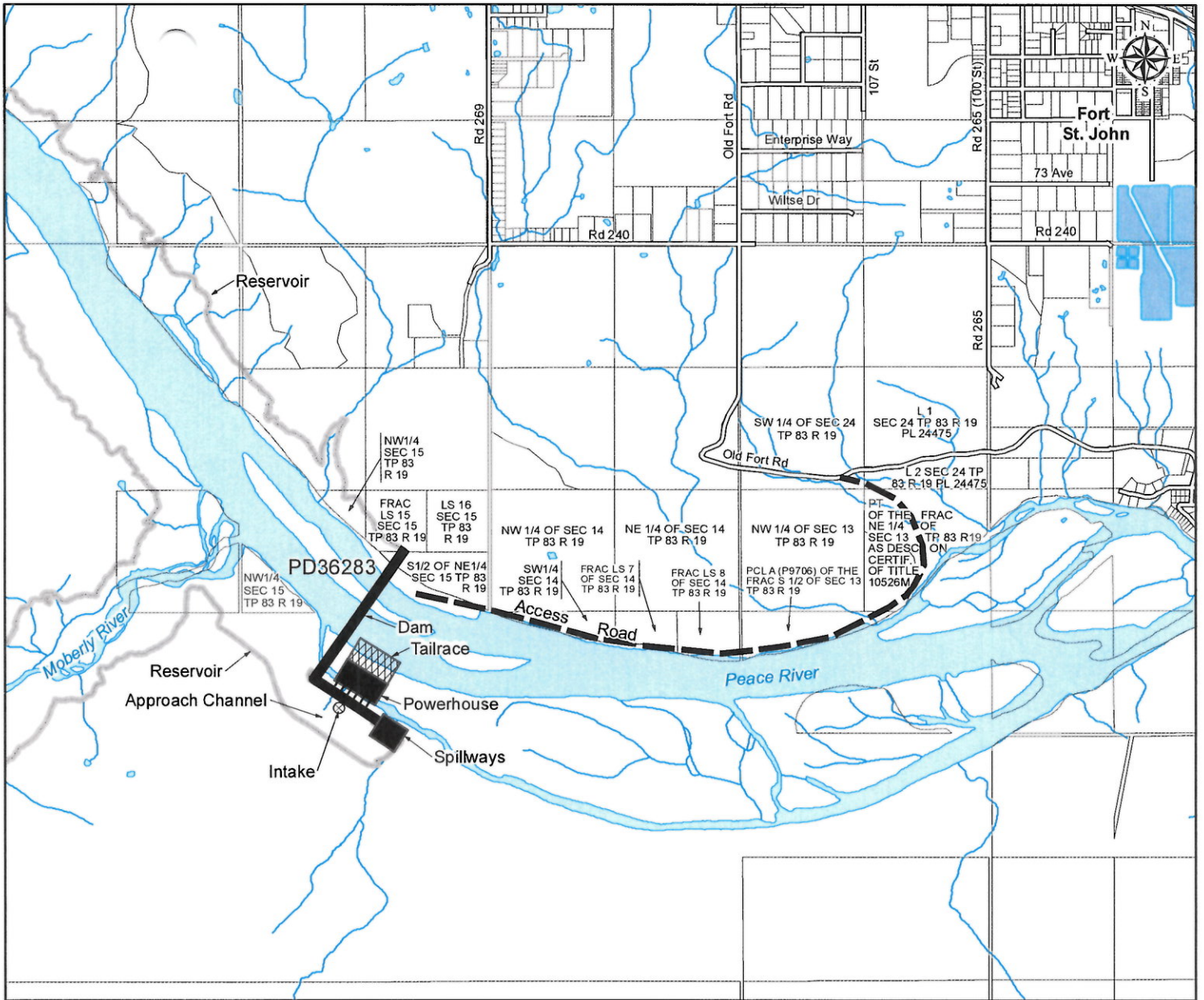

WATER DISTRICT: PEACE RIVER
 PRECINCT: DAWSON CREEK, FORT ST. JOHN
 LAND DISTRICT: PEACE RIVER

Signature: *[Handwritten Signature]*

Date: Feb. 26, 2016

LEGEND:
 Scale 1:40,000
 Point of Diversion ●
 Map Number 94A.016, 94A.016

Conditional Water Licences C132990 and C132991

Schedule A

Clause j) 4) in Conditional Water Licence 132990 and Conditional Water Licence 132991 requires a number of monitoring, mitigation and compensation projects to be completed to the satisfaction of the Comptroller of Water Rights before construction of certain works components are authorized to proceed. The monitoring, mitigation and compensation projects are specified in the table below along with the corresponding construction components and agency or committee from which the Comptroller of Water Rights will seek advice.

To address potential ecosystem impacts and ensure that fish and wildlife agency input is addressed, two *ad hoc* technical committees consisting of provincial and federal agencies and BC Hydro have been formed to collaboratively provide oversight and guidance to many of the required programs in the table. The two technical committees are the Fisheries and Aquatic Habitat Mitigation and Monitoring Technical Committee (FAHTC) and the Vegetation and Wildlife Mitigation and Monitoring Technical Committee (VWTC);

The FAHTC will provide guidance on the *Fisheries and Aquatic Habitat Management Plan* and *Fisheries and Aquatic Habitat Monitoring and Follow-up Program*.

The VWTC will provide guidance in the following areas:

1. Ungulate Winter Range
2. Wetlands and Riparian Habitat
3. Fishers
4. Bats
5. Snakes
6. Amphibians
7. Eagles
8. Breeding and Migratory Birds
9. Ground Nesting Raptors
10. Cavity Nesting Species
11. Rare Plants
12. Sharp-tailed Grouse
13. Lighting Effects
14. Carnivore Den Sites
15. Other Raptors
16. Other Species at Risk (Red and Blue-listed, Committee on the Status of Endangered Wildlife in Canada, *Species-At-Risk Act* Schedule 1)

The VWTC is directed to consider the following wildlife species and habitats, which are not directly mitigated for under the existing 16 program areas: fur-bearers, including beavers, otters and muskrat; migratory waterfowl; invertebrates; ungulate calving habitat; mineral licks; bear and carnivore habitats, including dens and migratory corridors; and, wildlife downstream of the dam site.

The Ministry of Forests, Lands and Natural Resource Operations is referred to in the table as FLNRO; the Ministry of Environment as MoE.

PROJECT CONSTRUCTION COMPONENT	MONITORING OR MITIGATION PROJECTS COMPLETED	ADVISORY ENTITY
Initial Right & Left Bank Works	Vegetation Clearing and Debris Management Plan	Provincial Forests – FLNRO
	Monitoring plan for downstream flow fluctuations	FAHTC
	Assessment procedure for evaluating juvenile fish in tributaries	FAHTC
	Scope of long-term monitoring and follow-up decision criteria for offsets/compensation ¹	FAHTC
	Kokanee Assessment Plan ¹	FAHTC
	Soil Management, Site Restoration and Revegetation Plan	VWTC
Shoreline Protection Berm at Hudson's Hope	Initial design, including habitat features, is provided to FAHTC and District of Hudson's Hope for review at least three years before berm construction is to begin	FAHTC
	Final design criteria and preliminary design drawing are agreed to by FAHTC and DHH two years before construction is to begin	FAHTC

¹ Upon advice of the Conservation Science Manager, MoE, completion of the project may be postponed to when pre-diversion left bank works proceeds.

Project Construction Component	Monitoring or Mitigation Projects Completed	Advisory Entity
Pre-Diversion Left Bank Works	The plan, including detailed methodology, for the annual Waterfowl and Shorebird Monitoring component of the Breeding and Migratory Bird Program area (VWTC Program Area 8)	VWTC
	Review of Program Areas 13, 14, and 15, determination of any additional plans or program development needed, and time-frame for plan(s) completion	VWTC
Pre-Diversion Right Bank Works	Review of Program Areas 10, 12, and 16, determination of any additional plans or program development needed, and time-frame for plan(s) completion	VWTC
Roller Compacted Concrete Buttress	Progress of monitoring and mitigation programs in FAHTC program areas is deemed satisfactory	FAHTC
	Wetland function assessment tool. Implementation process for Wetland and Riparian Habitat mitigation and monitoring plan (VWTC Program Area 2)	VWTC
	Plan for implementing and monitoring Fisher mitigation (VWTC Program Area 3)	VWTC
	Bat Mitigation and Monitoring Program Plan (VWTC Program Area 4)	VWTC
	Amphibian Mitigation and Monitoring Plan (VWTC Program Area 6)	VWTC
	Eagle Mitigation and Monitoring Plan (VWTC Program Area 7)	VWTC

Project Construction Component	Monitoring or Mitigation Projects Completed	Advisory Entity
Roller Compacted Concrete Buttress	Plan, including detailed methodology, for the annual Breeding Bird Monitoring component of the Breeding and Migratory Bird Program (VWTC Program Area 8)	VWTC
	Plan, including detailed methodology, for annual Ground Nesting Raptor Program (VWTC Program Area 9)	VWTC
	Rare Plant Mitigation and Monitoring Plan (VWTC Program Area 11)	VWTC
	Reviews of mitigation plans in VWTC Program Areas 10, 12, 13, 14, 15, 16	VWTC
	Relevant VWTC mitigation and monitoring programs have commenced as per mitigation and monitoring plans (VWTC Program Areas 1 – 16)	VWTC
Earthfill Dam	Progress of monitoring and mitigation programs in FAHTC program areas deemed satisfactory	FAHTC
	Relevant VWTC mitigation and monitoring programs have commenced as per completed mitigation and monitoring plans (VWTC Program Areas 1 – 16)	VWTC

Project Construction Component	Monitoring or Mitigation Projects Completed	Advisory Entity
Stage 2 Cofferdams and Diversion	Update of Fisheries and Aquatic Habitat Monitoring and Follow-up Program for monitoring during the diversion stage	FAHTC
	Schedule for reviews of monitoring results, including fish passage management, through the diversion stage is completed.	FAHTC
	Ungulate Winter Range Program Plan (VWTC Program Area 1)	VWTC
	Snake Mitigation and Monitoring Program Plan (VWTC Program Area 5)	VWTC
	Relevant VWTC mitigation and monitoring programs have commenced as per mitigation and monitoring plans (VWTC Program Areas 1 – 16)	VWTC
	Report on: (1) results of further investigation of potentially contaminated sites that may be inundated or affected by the change in groundwater level; (2) list of sites that require remediation	MoE
	Methylmercury Monitoring Plan, to be submitted a minimum of three (3) years prior to reservoir filling	Northern Health Authority
Spillway and Generating Station	Relevant VWTC mitigation and monitoring programs have commenced as per mitigation and monitoring plans (VWTC Program Areas 1 – 16)	VWTC
	Plan and Schedule for: (1) contaminated site remediation and (2) monitoring of water quality of surface water and potentially affected wells	MoE

Project Construction Component	Monitoring or Mitigation Projects Completed	Advisory Entity
Diversion Tunnel Conversion and Reservoir Filling	Update of Fisheries and Aquatic Habitat Monitoring and Follow-up Program for monitoring during the operation phase	FAHTC
	Relevant VWTC mitigation and monitoring programs have commenced as per mitigation and monitoring plans (VWTC Program Areas 1 – 16)	VWTC
	Remediation of contaminated sites and monitoring of surface water quality as well as groundwater quality for existing water well users that may be affected.	MoE

Attachment A

Site C Clean Energy Project

Scope of Information and Reports by the Independent Engineer

A. Preamble

BC Hydro and Power Authority (the "Licensee") is proceeding with the construction of the Site C Clean Energy Project (the "Project"). The Project is located on Peace River and is authorized by Conditional Water Licences 132990 and 132991 (the "Licences"), which form part of this document. The works of the Project are described under clause (h) of the Licences.

The Licensee is required under clause (j) 1) of the Licences to retain an Independent Engineer who will provide information and reports under the direction of the Engineer under the *Water Act* (the "Engineer") regarding the design and construction of the works. The Licensee is also required to retain an Independent Environmental Monitor as set out in clause (j) 2) of the Licences.

The information and reports to be provided by the Independent Engineer to the Engineer, and the Independent Engineer's relationship with the Licensee, Design Engineer, Construction Engineer and Independent Environmental Monitor are described in this document.

B. Regulation of the Construction of Works

The Engineer has the power to regulate the construction of works, which regulation may consider the following:

- 1) The criteria for the design and construction of works to protect the public and the environment.
- 2) The criteria for the operation of the works to protect the interests of licensees, riparian owners and owners of land adjacent to the works, and protect the environment from adverse effects.
- 3) The construction activities that may adversely affect the public, the environment and the interests of licensees, riparian owners and owners of land adjacent to the works.

If the Engineer has determined that the construction of works may be hazardous to the public and the environment, or the interests of licensees, riparian owners and owners of land adjacent to the works may be adversely affected, the Engineer may issue an order that directs the Licensee to change the manner in which the works are constructed to remove the hazard and adverse effect.

C. Information and Reports

The Licensee is required under clause (j) 3) of the Licences to submit to the Comptroller of Water Rights the following:

- a) plans that show the general arrangement of the works;
- b) criteria for the design of the works;
- c) criteria for the operation of the works;
- d) a schedule for the construction of the works;
- e) an environmental management plan (CEMP) for the management and mitigation of construction impacts;

The Licensee is also required under clause (k) to ensure that the design drawings for the works to be constructed are signed and sealed by a professional engineer registered in the province of British Columbia (the "Design Engineer").

These submissions by the Licensee are the basis for the regulation of the construction of the works.

The Independent Engineer is directed to review the submissions and provide the Engineer with reports as follows:

- 1) Compare the plans showing the general arrangement of the works to the works described by the Licences and describe any differences.
- 2) Assess the criteria for the design of the works to determine if works constructed to these criteria will be a hazard to the public and the environment.
- 3) Assess the criteria for the operation of the works to determine if works operated to these criteria will protect the interests of licensees, riparian owners and owners of land adjacent to the works, and protect the environment from adverse impacts.
- 4) Assess the schedule for the construction of the works to determine if there are any practical matters in relation to the conditions in the Licences and the CEMP; and the interests of the public, licensees, riparian owners and owners of land adjacent to the works that the Engineer should consider in the regulation of the works.
- 5) Assess the design drawings for the construction of the works to determine if they are in accordance with the criteria for the design and operation of the works, and they are signed and sealed by the Design Engineer.
- 6) Assess the schedule for the construction of the works and the design drawings for the construction of the works to determine the frequency of the submission by the Licensee of the reports on the progress of construction.
- 7) Review the reports submitted by the Licensee on the progress of the construction of the works to determine if any of the construction activities should be adjusted to reduce the future hazard posed by the works on the public and the environment.

- 8) Summarize any outstanding matters that would make the works a hazard to the public and the environment when the Licensee submits a schedule for testing the works.

The Independent Engineer will prepare a recommendation report for the Engineer on the review of items 1) to 4) above for the issuance of Leaves to Commence Construction.

The Independent Engineer will prepare a recommendation report for the Engineer, copy to the Licensee, Design Engineer and the Construction Engineer, on the review of items 5) and 6) if the actual construction of a particular component of the project may proceed.

The Engineer may direct the Independent Engineer to provide additional information and reports as may be required for the regulation of the construction of the works.

The Independent Engineer will discuss and clarify with the Design Engineer and the Construction Engineer any matters that may need further action. If the Independent Engineer is unable to resolve such matters, the Independent Engineer must immediately notify the Engineer. The Engineer will contact the Licensee, and resolve the matter.

D. Independent Environmental Monitor

The Licensee is required to retain a person with professional qualifications (the "Independent Environmental Monitor") to observe and report on the activities of constructing the works in relation to the requirements under the environmental management plan (the "CEMP"). The Independent Engineer will be provided a copy of the report by the Independent Environmental Monitor

The Independent Engineer will review the reports by the Independent Environmental Monitor and advise the Engineer in a written report if the construction activities are adversely affecting the environment and the interests of licensees, riparian owners and owners of land adjacent to the works.

The Independent Engineer and the Independent Environmental Monitor will communicate with each other during the construction of the works to coordinate their activities to provide information to the Engineer for proper regulation of the construction of the works.

E. Leave to Commence Construction

The Licensee may divide the construction of the works into phases. Before the Engineer grants leave to commence construction of any phase of the works, the Engineer must be satisfied that the Licensee has met the requirements under clause (j) of the Licences.

The Independent Engineer will provide the Engineer with information and reports as set out in Section C above for each phase in the construction of the works. The information and reports are to be provided in a timely manner in accordance with the schedule for the construction of the works.

Based on information submitted by the Independent Engineer, the Engineer may issue a leave to commence construction for a particular phase of the project, subject to the Independent Engineer reviewing design drawings and giving consent for construction to proceed.

F. Undertaking and Monitoring of Construction

The Independent Engineer will review the design drawings for the construction of the works, and prepare a report as set out in Section C before giving consent that construction may be undertaken. The Independent Engineer will identify in the report to the Engineer the components within each phase of the construction of the works that are critical for regulating the construction of the works to protect the public and the environment, and the interests of licensees, riparian owners and owners of land adjacent to the works, and protect the environment from adverse effects. A cover letter, with a copy to the Licensee, Design Engineer and the Construction Engineer, would make recommendation if construction of that particular component of works may be undertaken, and this would be sufficient for the Construction Engineer to proceed with construction.

The Independent Engineer will schedule site inspections to verify that the conditions for the construction of the critical components are in accordance with the construction plans, and provide the Engineer with a report on the outcome of the inspection.

G. Testing the Operation

The Independent Engineer will monitor the testing of the operation of the works to determine if the operation poses a hazard to the public and the environment, and submit to the Engineer a report on the outcome of the monitoring.

H. Acceptance

The information and reports to be provided by the Independent Engineer to the Engineer as set out above is acceptable to:

Name: _____ Date: _____

Independent Engineer

AND

The Licensee agrees to retain the Independent Engineer to provide the information and reports to the Engineer as set out above.

Name: _____ Date: _____

Licensee

Appendix A - Contact List

Deputy Comptroller of Water Rights	
Name:	Pieter Bekker
Position Title:	Deputy Comptroller of Water Rights
Office Phone Number:	250-952-6791
Mobile or Alternate Phone Number:	
Mailing Address:	PO Box 9340 Stn Prov Govt, Victoria BC V8W 9M1
Engineer under the <i>Water Act</i>	
Name:	Gypsy Fisher
Position Title:	Water Management Officer
Office Phone Number:	250 387-1154
Mobile or Alternate Phone Number:	
Mailing Address:	PO Box 9340 Stn Prov Govt, Victoria BC V8W 9M1
Independent Engineer	
Name:	
Position Title:	
Company:	
Office Phone Number:	
Mobile or Alternate Phone Number:	
Mailing Address:	
Licensee Representative	
Name:	
Position Title:	
Company:	
Office Phone Number:	
Mobile or Alternate Phone Number:	
Mailing Address:	

Design Engineer	
Name:	
Position Title:	
Company	
Office Phone Number:	
Mobile or Alternate Phone Number:	
Mailing Address:	
Construction Engineer	
Name:	
Position Title:	
Company	
Office Phone Number:	
Mobile or Alternate Phone Number:	
Mailing Address:	

The licensee is required to retain an Independent Engineer ("IE") and Independent Environmental Monitor ("IEM") over the duration of project construction. The IE will review project design drawings to confirm consistency with works authorized and that project design can meet all licence conditions. The IE makes recommendations to the Engineer under the WaterAct to issue Leaves. The IE is also responsible to monitor the progress of project construction and report to the Engineer. The IEM is responsible for ensuring that all environmental impacts during construction are managed and mitigated to the extent feasible. The IEM reviews the Construction Environmental Management Plan ("CEMP"), including Environmental Protection Plans ("EPPs") and Environmental Works Plans ("EWPs"), and verifies that the plans adequately address the potential environmental impacts before construction work can proceed. The IEM will make recommendations to the Engineer on the adequacy of the CEMP and to the IE on the adequacy of the EPPs and EWPs before Leaves are granted.

Attachment B

Site C Clean Energy Project

Scope of Information and Reports by the Independent Environmental Monitor

A. Preamble

BC Hydro and Power Authority (the “Licensee”) is proceeding with the construction of the Site C Clean Energy Project (the “Project”). The Project is located on Peace River and is authorized by Conditional Water Licences 132990 and 132991 (the “Licences”), which form part of this document. The works of the Project are described under clause (h) of the Licences.

The Licensee is required under clause (j) 3) e) of the Licences to prepare an environmental management plan (the “CEMP”) for the management and mitigation of construction impacts, which plan is to be to the satisfaction of the Comptroller of Water Rights (the “Comptroller”).

The Licensee is required under clause (j) 2) of the Licences to retain a person with professional qualifications (the “Independent Environmental Monitor”) who will monitor environmental impacts from the construction of works. The Independent Environmental Monitor will also provide information and reports under the direction of the Engineer under the *Water Act* (the “Engineer”) on compliance of the construction with the CEMP. The Licensee is also required to retain an Independent Engineer as set out in clause (j) 1) of the Licences.

The CEMP are the provisions that meet the collective requirements of the Engineer and the municipal, provincial and federal agencies that contributed to the development of the CEMP to mitigate the effects of the construction activities.

The information and reports by the Independent Environmental Monitor will be provided to the Engineer and the municipal, provincial and federal agencies that contributed to the development of the CEMP. Each agency will take action on the information and reports provided by the Independent Environmental Monitor in accordance with the jurisdiction of the agency.

B. Regulation of the Construction of Works

The Engineer has the power to regulate the construction of works, which regulation may consider the construction activities that may adversely affect the public, the environment and the interests of licensees, riparian owners and owners of land adjacent to the works.

If the Engineer has determined that the construction activities may be hazardous to the interests of licensees, riparian owners and owners of land adjacent to the works and the

environment, the Engineer may issue an order that directs the Licensee to change the manner in which the works are constructed to remove the hazardous condition.

C. Information and Reports

The Independent Environmental Monitor is responsible for observing the methods of construction and preparing information and reports on the compliance of the construction activities with the CEMP.

The information and the reports to be provided by the Independent Environmental Monitor to the Engineer and the municipal, provincial and federal agencies that contributed to the development of the CEMP must include the following:

1. Review the CEMP and develop a work plan that sets out the following:
 - The frequency of inspecting the construction activities.
 - The manner in which notice is to be given to the parties for a construction activity that is not in compliance with the CEMP.
 - A process for escalating enforcement of compliance of construction activities with the CEMP.
 - The format and frequency for the preparation of reports on the compliance of the construction activities with the CEMP.
2. Reports on meetings with the Licensee and the Construction Engineer to develop a strategy to communicate to the workers on the construction site the following:
 - the requirements of the CEMP,
 - the potential environmental impacts, and
 - the authority of the Independent Environmental Monitor.
3. Reports on matters that arise during the construction and testing of the works that are not described in the CEMP. If cannot be resolved by discussion with the Licensee and the Construction Engineer, obtain direction from the Engineer and the municipal, provincial and federal agencies that contributed to the development of the CEMP for the mitigation of these matters.
4. Provide any other information or advice required by the Engineer and the municipal, provincial and federal agencies that contributed to the development of the CEMP that is required to ensure that the construction and commissioning of the works is in accordance with the CEMP.

D. Independent Engineer

The Licensee is required under clause (j) 1) of the Licences to retain an Independent Engineer who will provide information and reports under the direction of the Engineer regarding the design and construction of the works.

The Independent Engineer and the Independent Environmental Monitor will communicate with each other during the construction of the works to coordinate their activities to provide information to the Engineer for proper regulation of the construction of the works.

E. Delegation of Duties of Independent Environmental Monitor

When the Independent Environmental Monitor is unable to personally observe and report on the construction activities, the persons who have the same authority as the Independent Environmental Monitor to observe and report on construction activities are:

- 1.
- 2.

F. Testing the Operation

When the Licensee submits a schedule for testing the operation of the works, the Independent Environmental Monitor will inspect the site and report to the Engineer and the municipal, provincial and federal agencies that contributed to the development of the CEMP on any matters that would make the works a hazard to the public and the environment. The Independent Environmental Monitor will observe the testing of the operation of the works to determine if the operation poses a hazard to the public and the environment, and submit to the Engineer a report on the outcome of the monitoring.

G. Authority to Stop Construction Activities

The plan prepared by the Independent Environmental Monitor for escalating the enforcement of compliance of construction activities with the CEMP includes a provision that the Independent Environmental Monitor may direct the Construction Engineer to stop a construction activity.

The authority of the Independent Environmental Monitor to stop a construction activity pertains only to those matters under the jurisdiction of the municipal, provincial and federal agencies that contributed to the development of the CEMP.

An order to stop a construction activity that affects the interests of licensees, riparian owners and owners of land adjacent to the works may only be given by the Engineer.

H. Acceptance

The information and reports to be provided by the Independent Environmental Monitor to the Engineer as set out above is acceptable to:

Name: _____ Date: _____
Independent Environmental Monitor

AND

The Licensee agrees to retain the Independent Environmental Monitor to provide the information and reports to the Engineer set out above.

Name: _____ Date: _____
Licensee

Appendix A - Contact List

Deputy Comptroller of Water Rights	
Name:	Pieter Bekker
Position Title:	Deputy Comptroller of Water Rights
Office Phone Number:	250-952-6791
Mobile or Alternate Phone Number:	
Mailing Address:	PO Box 9340 Stn Prov Govt Victoria BC V8W 9M1
Engineer under the <i>Water Act</i>	
Name:	Gypsy Fisher
Position Title:	Water Management Officer
Office Phone Number:	250 387-1154
Mobile or Alternate Phone Number:	
Mailing Address:	PO Box 9340 Stn Prov Govt, Victoria BC V8W 9M1
Independent Engineer	
Name:	
Position Title:	
Company:	
Office Phone Number:	
Mobile or Alternate Phone Number:	
Mailing Address:	
Licensee Representative	
Name:	
Position Title:	
Company:	
Office Phone Number:	
Mobile or Alternate Phone Number:	
Mailing Address:	
Design Engineer	
Name:	
Position Title:	
Company:	
Office Phone Number:	
Mobile or Alternate Phone Number:	
Mailing Address:	

Construction Engineer	
Name:	
Position Title:	
Company	
Office Phone Number:	
Mobile or Alternate Phone Number:	
Mailing Address:	