



## PERMIT UNDER THE WATER ACT AUTHORIZING THE OCCUPATION OF CROWN LAND

The holders of Conditional Water Licence 66911 whose licence authorizes the diversion and storage of water from Fiftynine Creek and redirection from Bonaparte River and the reservoir is Magnesia Lake, are hereby authorized to occupy Crown Land by flooding and by constructing, maintaining and operating thereon the works authorized under the said licence and any licence which may be issued in substitution thereof.

- (a) The Crown Land which is authorized to be occupied under this permit is a portion of Lots 1716 and 5166 and unsurveyed land, Lillooet District, the location of which is shown approximately on the plan attached to the said water licence.
- (b) The approximate area of the Crown Land authorized to be occupied under this permit is:
- |                         |
|-------------------------|
| 1.0 acre for damsite    |
| 90.0 acres for flooding |
| <hr/>                   |
| Total Area 91.00 acres  |
- (c) The permittee may cut and remove from the said Crown Land any timber necessary to permit construction and maintenance of the said works and clearing of the said lands which may be flooded. Prior to the cutting, destruction or flooding of any timber, the permittee shall apply for and obtain a licence to cut timber from the District Manager and the amount of stumpage, royalty and (or) compensation payable to the Crown in respect of trees, including merchantable or young growth, cut, removed, damaged, or destroyed by the permittee, shall be the sum or sums fixed by the Forest Service of the Province of British Columbia.
- (d) This permit is appurtenant to the land, mine or undertaking to which the aforesaid water licence is appurtenant.
- (e) This permit shall become void if the water licence with respect to which the permit is issued should terminate, be abandoned or cancelled, or amended so as to render this permit unnecessary.
- (f) This permit is issued and accepted on the understanding that the permittee shall indemnify and save harmless the Government of the Province of British Columbia for all loss, damage to works, cost or expense suffered by the permittee by reason of the Crown Land or any portion thereof being submerged or damaged by erosion or otherwise affected by flooding.
- (g) The holder of this permit shall not be entitled to compensation if the Crown grants permits to other persons to occupy the land affected by this permit.
- (h) In the event of a dispute at any time with respect to the area or boundaries of the land affected by this permit, the holder shall, at his own expense, have the said land surveyed by a duly qualified surveyor.
- (i) The annual rental for this permit is \$93.00, which is subject to review and revision at any time at the discretion of the Crown.
- (j) This permit replaces Permit No.5857.

Deputy Minister of Environment and Parks



# Province of British Columbia

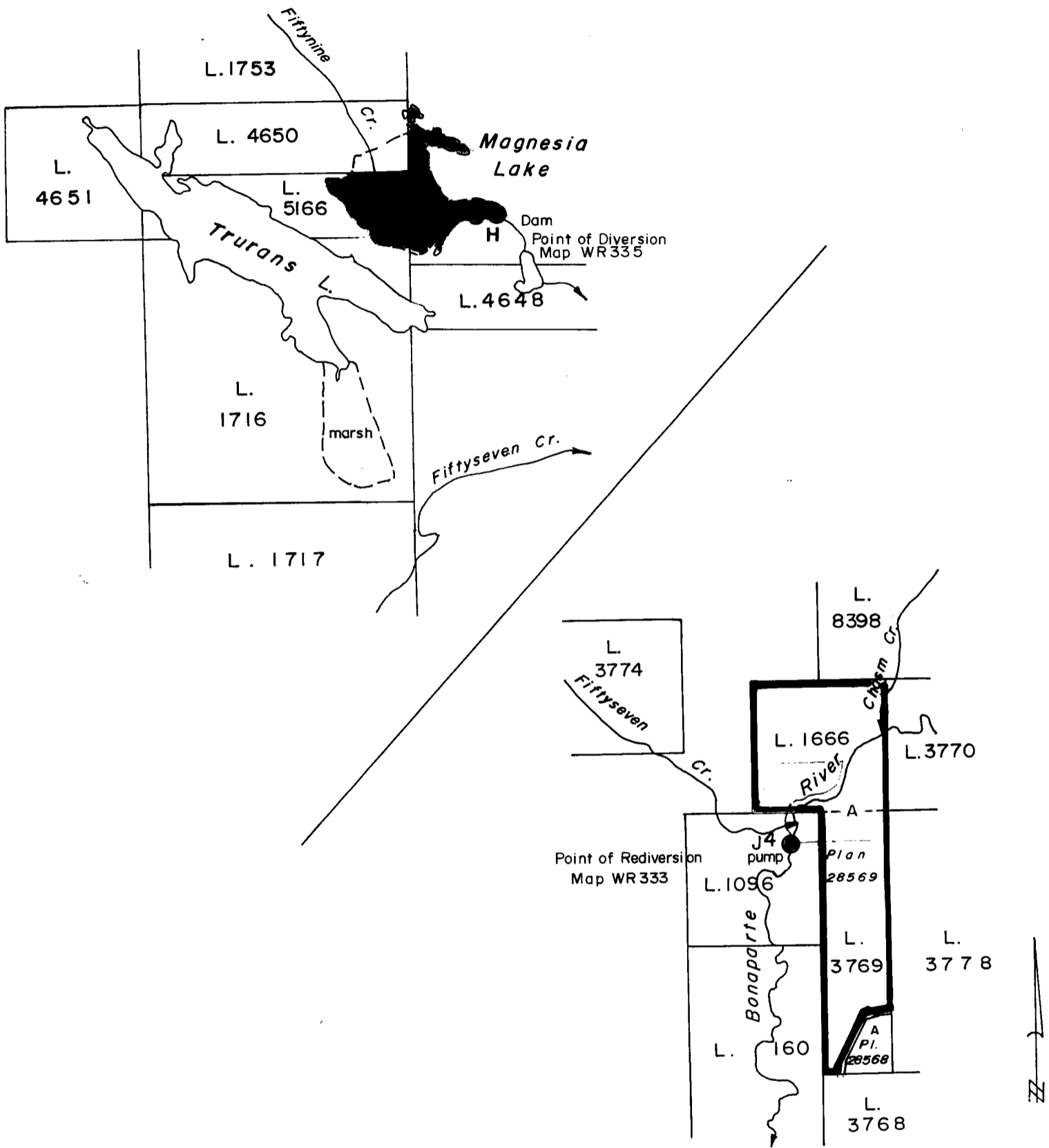

WATER DISTRICT : ASCHROFT  
 PRECINCT : BONAPARTE  
 LAND DISTRICT : LILLOOET

Signature *Alfred Schrodin*  
 Date APR 21 1938

### LEGEND

Scale : 40 chains to 1 inch  
 Point of Diversion, Rediversion: ●, ●  
 Map Number : WR 335, 333  
 Pipe : ————  
 Permit over Crown Land:

C.L.66911 for FL.7185  
 & F.L.7186  
 P.C.L. 16970  
 File 0031090

The boundaries of the land to which this licence is appurtenant are shown thus: