

- Users must note the dates of base mapping, aerial photography, river surveys and issue of mapping relevant to dates of development in the map area. Subsequent developments or changes within the floodplain or channel (natural or constructed) will affect flow levels and render site-specific map information obsolete.
- Floodplain maps are administrative tools which depict minimum flood elevations and floodplain boundaries. Flooding may occur outside of the designated floodplain boundary.
- Floodplain maps do not provide information on site-specific flood hazards such as, land erosion or high water velocity, sudden shifts in the channel of the watercourse, or alluvial and debris flow fan areas.
- Other sources of water, roads, railways or other barriers can restrict water flow and affect local flood levels. As well, obstructions such as ice and debris, flooding in surrounding areas, channel deposition, groundwater or other phenomena can cause flood levels to exceed those indicated on the map. Land adjacent to a floodplain may be subject to flooding from tributary watercourses.
- Floodplain maps do not indicate or locate legal survey boundaries. A site survey is required to reconcile property location, ground elevations, and designated flood boundaries.
- The accuracy of the location of a floodplain boundary as shown on this map is limited by the base topographic map, generally assumed to be plus or minus one-half the increment of the ground contours.
- Professional assistance and detailed engineering analysis are required to address any of the above considerations.

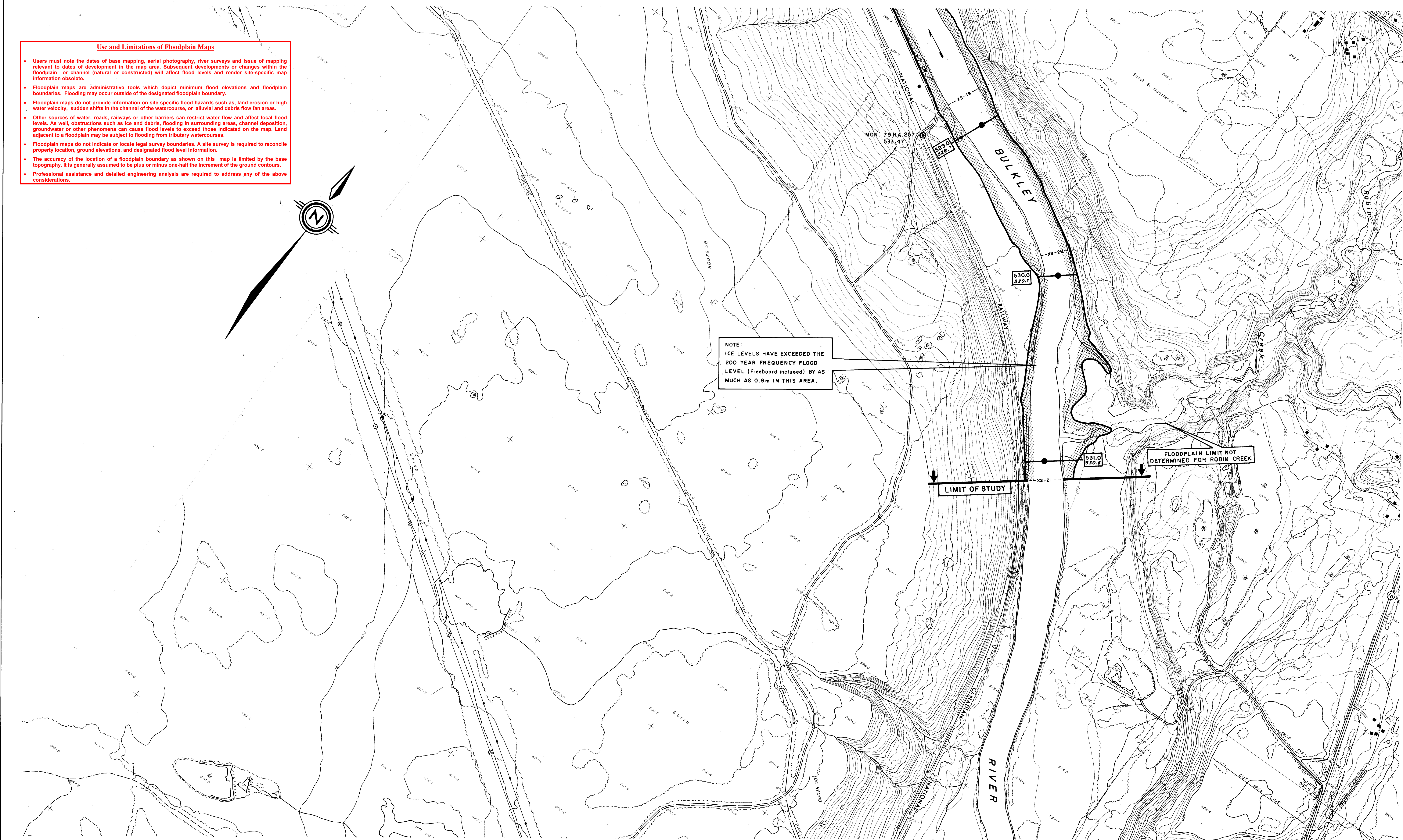

FLOODPLAIN DATA

- The Designated Flood has a statistical frequency of occurrence of once every 200 years.
- The flood levels were computed using a standard step method modelling technique, assuming open water flow conditions.
- The floodplain limits assume the absence of all dykes.
- The floodplain limits and flood levels include an allowance for freeboard.
- The floodplain limits are not established on the ground by legal survey.
- The floodplain limits are not delineated for side streams and tributaries.
- The required setback of buildings from the natural boundaries of lakes and watercourses to allow for the passage of floodwaters and possible bank erosion is not shown. This information is available either through local municipalities or the Ministry of Environment.

[illegible]

No	DESCRIPTION	D

DRAWN	N. F. A.
CHECKED	P. T. D.
RIVER SURVEY	T. M. D.
DESIGNED	F. W. D.



PRELIMINARY FLOODPLAIN MAPPING
BULKLEY RIVER
QUICK AREA

FILE No.
46-0000-S.

N.T.S. MAP No.
93 L / IO

SCALE
1 : 5 000

NEGATIVE No.
280 151

DRAWING No. 86-23-4