**Use and Limitations of Floodplain Maps**

- Users must note the dates of base mapping, aerial photography, river surveys and issues of maps relevant to dates of development in the map area. Subsequent developments or changes within the floodplain or channel (natural or constructed) will affect flood levels and render site-specific map information obsolete.
- Floodplain maps are administrative tools which depict minimum flood elevations and floodplain boundaries. Flooding may occur outside of the designated floodplain boundary.
- Floodplain maps do not provide information on site-specific flood hazards such as, land erosion or high water velocity, sudden shifts in the channel of the watercourse, or alluvial and debris flow fan areas.
- Other sources of water, roads, railways or other barriers can restrict water flow and affect local flood levels. As well, obstructions such as ice and debris, flooding in surrounding areas, channel deposition, groundwater or other phenomena can cause flood levels to exceed those indicated on the map. Land adjacent to a floodplain may be subject to flooding from tributary watercourses.
- Floodplain maps do not indicate or locate legal survey boundaries. A site survey is required to reconcile property location, ground elevations, and designated flood level information.
- The accuracy of the location of a floodplain boundary as shown on this map is limited by the base topography. It is generally assumed to be plus or minus one-half the increment of the ground contours.
- Professional assistance and detailed engineering analysis are required to address any of the above considerations.

NOTES

Produced by: British Columbia Environmental and Engineering Service
Floodplain Mapping Program.

Survey; Field survey done by Planning and Surveys Division,
Water Investigations Branch.
a) Horizontal control based on provincial network.
b) Vertical control based on Geodetic Survey of Canada (1963).

Mapping; Mapping done by Map Production Division, Surveys and
Mapping Branch.
a) Contour interval - 1 metre and greater. Spot elevations
shown to 0.1 metres, with accuracy to 0.3 metres.
b) Grid origin referred to U.T.M. Projection, Zone 11.

FLOODPLAIN DATA

- a) Flood profiles were computed by a standard step method
modelling technique.
b) Floodplain limits shown assume absence of all dykes.
c) Floodplain limits and flood levels include allowances for
freesboard.
d) Position of floodplain boundary not established on ground
by legal survey.
e) See "Flood Control Requirements" for minimum distances
allowed from buildings to natural boundaries of water-
courses and lakes.
f) Floodplain limits are not delineated for side streams
or tributaries.

* Correspondence to Municipalities, Oct 30, 1973

LEGEND

200 Year
Floodplain Limit

Flood Levels in Metres
Above G.S.C. Datum.
352.4 — 200 Year Frequency
352.2 — 20 Year Frequency

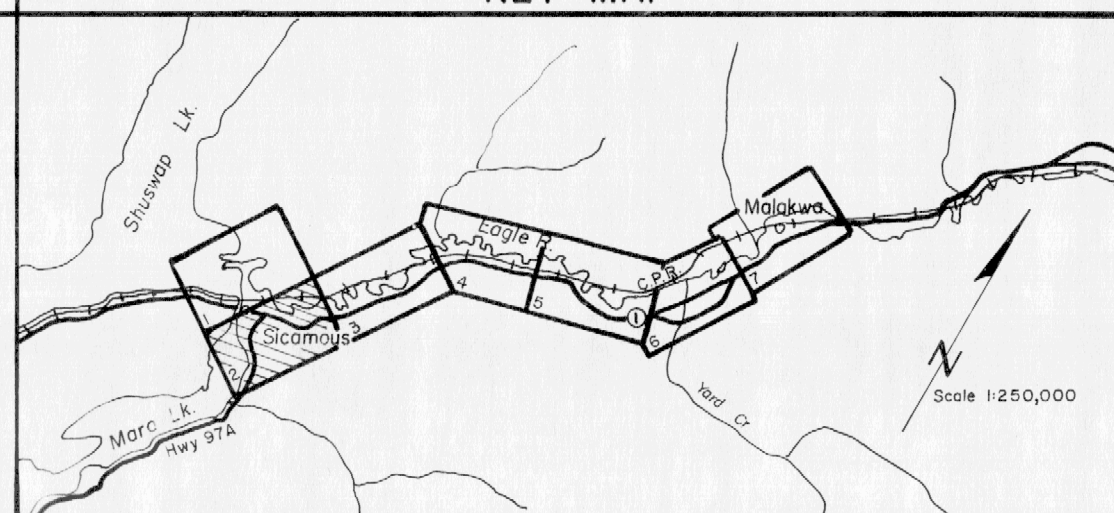
KEY MAP**REVISIONS**

No.	DESCRIPTION	DATE

**ORTHOPHOTO
MAPPING**

Date of Photography
Sept. 1975

**MAPPING
INFORMATION**

Checked ls

**FLOODPLAIN
INFORMATION**

Checked rdz

ISSUE OF MAPPING

Date Jan 1979



Province of
British Columbia

Ministry of Environment
Environmental and Engineering Service
Water Investigations Branch

FLOODPLAIN MAPPING**EAGLE RIVER**

Scale in Metres
100 0 100 200 300 400 500

RECOMMENDED
DIVISION CHIEF [Signature]

APPROVED
DEPUTY MINISTER [Signature]

263 393

FILE No.

0310213-4

SCALE

1:5000

DWG. No.

A5187-2

SHEET

2 OF 7