

SEE SHEET 3

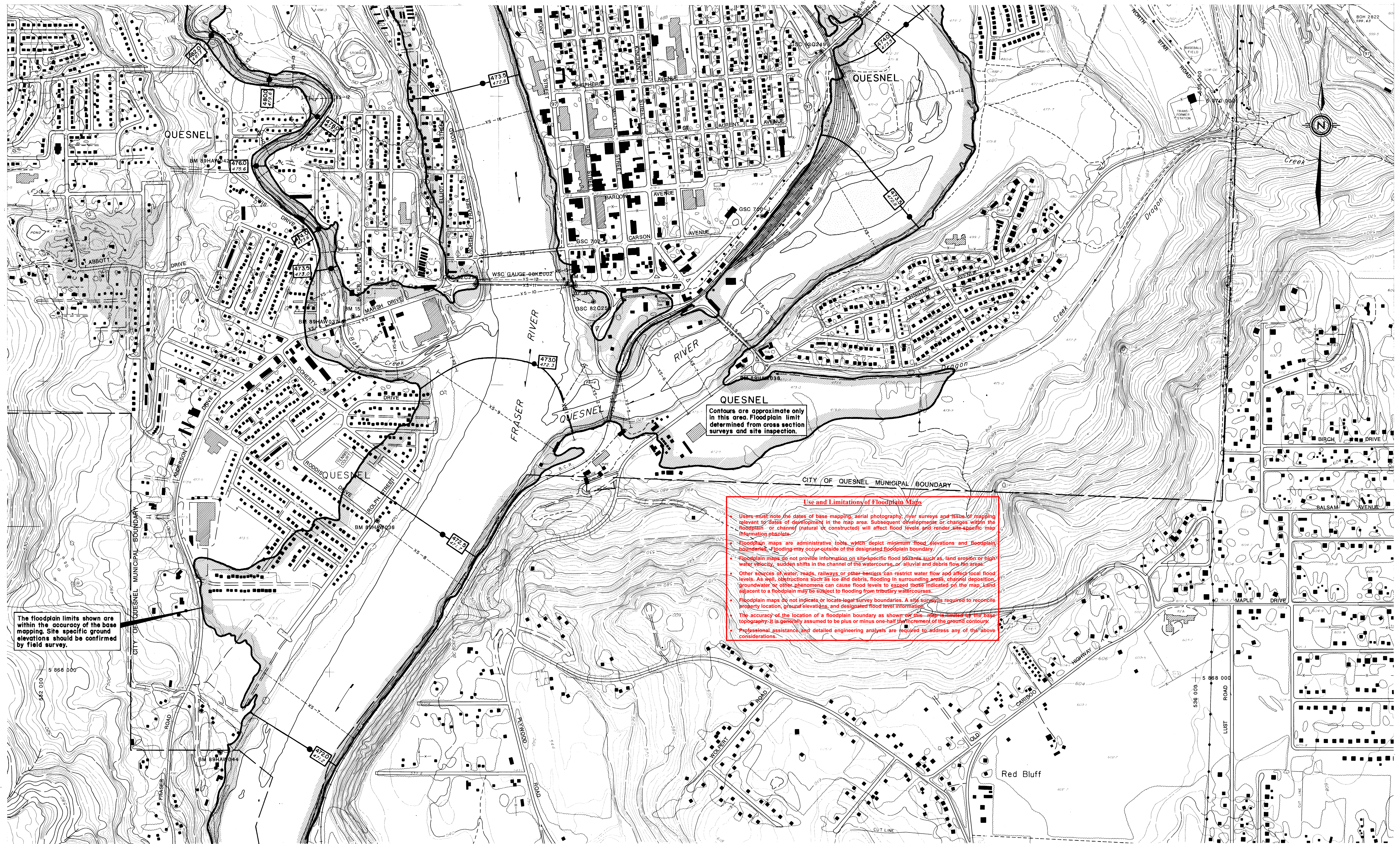

SEE SHEET 1

NOTES		FLOODPLAIN DATA		LEGEND		KEY MAP		REVISIONS		ISSUE OF MAPPING		ENVIRONMENT CANADA INLAND WATERS ENvironnement Canada EAUX INTERIEURES		BRITISH COLUMBIA MINISTRY OF ENVIRONMENT COLOMBIE-BRITANNIQUE MINISTÈRE DE L'ENVIRONNEMENT		CANADA-BRITISH COLUMBIA FLOODPLAIN MAPPING AGREEMENT L'ACCORD CANADA-COLOMBIE-BRITANNIQUE SUR LA CARTOGRAPHIE DES PLAINES D'INONDATION		FILE No. 100-0000-Q	
Produced by: British Columbia Water Management Branch, Special Projects Section, Floodplain Mapping Program.		1. The floodplain areas as depicted on this map have been interin designated pursuant to the Canada/British Columbia Floodplain Mapping Agreement (1988) by the Minister of the Environment for Canada and the Minister of Environment, Lands and Parks for British Columbia. Flooding may still occur outside of the interin designated floodplain areas. The Ministers do not assume any liability by reason of the interin designation or failure to interin designate areas on this map.		DESIGNATED FLOODPLAIN LIMIT		Scale 1:250 000		No. DESCRIPTION DATE		DATE Sept. 30, 1992		DRAWN M.W.		CHECKED M.P.		DESIGNED M.P.		ENGINEER N.A. Gray	
Survey: River survey done by Survey Section, Water Management Branch, Project 81-12 P027, July, 1989.		2. The Designated Flood has a statistical frequency of occurrence of once every 200 years.		FLOOD LEVEL				1. Extends, revises and replaces Dwg. 87-17, Sheet 1 dated May 1987 and Interim designated Sept. 30, 1988.		RIVER SURVEY M.P.		RECOMMENDED P. Woods		APPROVED E. G. G. G.		DRAWING No. 89-43-2		SHEET 2 of 5	
Mapping: Base mapping done by Map Production Division, Surveys and Resource Mapping Branch, Project 81-0281, 1980 Air Photography.		3. The flood levels were computed using a standard step method modelling technique, assuming open water flow conditions.		200 Year Frequency						Scale in metres									
a) Contour interval 2 metres and greater; spot elevations shown to 0.1 metres.		4. The floodplain limits assume the absence of all dykes.		20 Year Frequency															
b) Elevation are in metres and are referred to Geoidic Survey of Canada datum. (M) indicates Survey Monument).		5. The floodplain limits and flood levels include an allowance for freeboard.		(METRES G.S.C. DATUM)															
c) Contour interval 2 metres and greater; spot elevations shown to 0.1 metres.		6. The floodplain limits are not established on the ground by legal survey.																	
d) Elevation are in metres and are referred to Geoidic Survey of Canada datum. (M) indicates Survey Monument).		7. The floodplain limits are not delineated for side streams and tributaries.																	
e) Contour interval 2 metres and greater; spot elevations shown to 0.1 metres.		8. The required setback of buildings from the natural boundaries of lakes and watercourses to allow for the passage of floodwaters and possible bank erosion is not shown. This information is available through local municipalities or the Ministry of Environment, Lands and Parks.																	
f) Contour interval 2 metres and greater; spot elevations shown to 0.1 metres.		9. MAPS AVAILABLE FROM SURVEYS AND RESOURCE MAPPING BRANCH, MAPS B.C., MAP AND AIR PHOTO SALES, VICTORIA, B.C.																	