

Use and Limitations of Floodplain Maps

- Users must note the dates of base mapping, aerial photography, river surveys and issue of mapping relevant to dates of development in the map area. Subsequent developments or changes within the floodplain or channel (natural or constructed) will affect flood levels and render site-specific map information obsolete.
- Floodplain maps are administrative tools which depict minimum flood elevations and floodplain boundaries. Flooding may occur outside of the designated floodplain boundary.
- Floodplain maps do not provide information on site-specific flood hazards such as, land erosion or high water velocity, sudden shifts in the channel of the watercourse, or alluvial and debris flow fan areas.
- Other sources of water, roads, railways or other barriers can restrict water flow and affect local flood levels. As well, obstructions such as ice and debris, flooding in surrounding areas, channel deposition, groundwater or other phenomena can cause flood levels to exceed those indicated on the map. Land adjacent to a floodplain may be subject to flooding from tributary watercourses.
- Floodplain maps do not indicate or locate legal survey boundaries. A site survey is required to reconcile property location, ground elevations, and designated flood level information.
- The accuracy of the location of a floodplain boundary as shown on this map is limited by the base topography. It is generally assumed to be plus or minus one-half the increment of the ground contours.
- Professional assistance and detailed engineering analysis are required to address any of the above considerations.

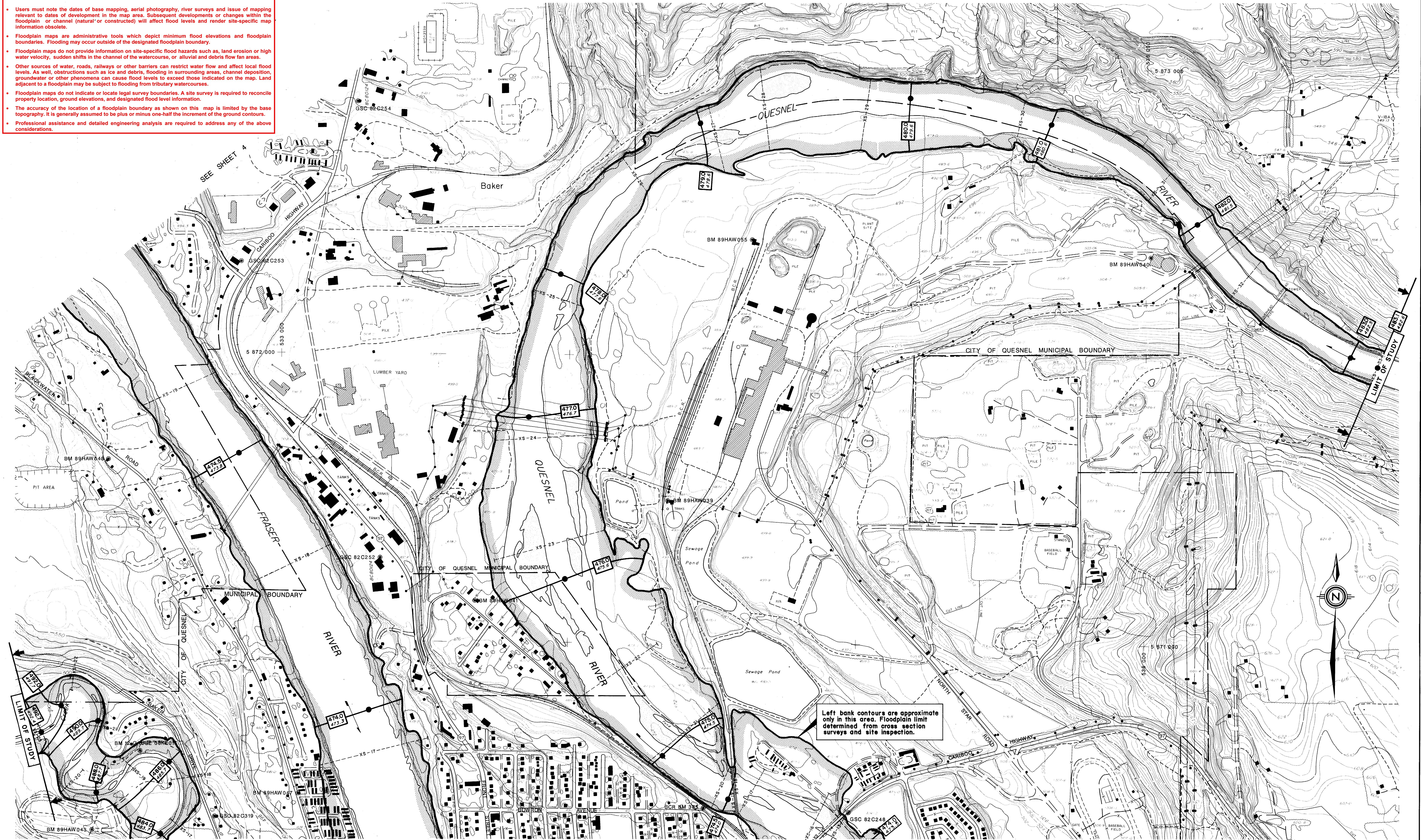

SEE SHEET 2

NOTES		FLOODPLAIN DATA		LEGEND		KEY MAP		REVISIONS		ISSUE OF MAPPING		FLOODPLAIN MAPPING		DRAWING No. REV.							
<p>Produced by: British Columbia Water Management Branch, Special Projects Section, Floodplain Mapping Program.</p> <p>Survey: River survey done by Surveys Section, Water Management Branch, Project 89-15, F027, July, 1989.</p> <p>a) Horizontal control based on provincial datum.</p> <p>b) Elevations are in metres and are referred to Sea Level Survey of Canada datum.</p> <p>c) Indicates Survey Monument.</p> <p>Mapping: Base mapping done by Map Production Division, Surveys and Resource Mapping Branch, Project 89-281, 1989 Air Photography.</p> <p>a) Contour interval 2 metres and greater; spot elevations shown to 0.1 metres, with accuracy to ± 0.5 metres, except where noted.</p> <p>b) Grid origin referred to U.T.M. Projection Zone 10.</p>		<p>1. The floodplain areas as depicted on this map have been interim designated pursuant to the Canada/British Columbia Floodplain Mapping Agreement (1988) by the Minister of the Environment for Canada and the Minister of Environment, Lands and Parks for British Columbia. Flooding may still occur outside of the interim designated floodplain areas. The Ministers do not assume any liability by reason of the interim designation or failure to interim designate areas on this map.</p> <p>2. The Designated Flood has a statistical frequency of occurrence of once every 200 years.</p> <p>3. The flood levels were computed using a standard step method modelling technique, assuming open water flow conditions.</p> <p>4. The floodplain limits assume the absence of all dykes.</p> <p>5. The floodplain limits and flood levels include an allowance for freeboard.</p> <p>6. The floodplain limits are not established on the ground by legal survey.</p> <p>7. The floodplain limits are not delineated for side streams and tributaries.</p> <p>8. The required setback of buildings from the natural boundaries of lakes and watercourses to allow for the passage of floodwaters and possible bank erosion is not shown. This information is available either through local municipalities or the Ministry of Environment, Lands and Parks.</p> <p>9. Maps available from SURVEYS AND RESOURCE MAPPING BRANCH, MAPS B.C., MAP AND AIR PHOTO SALES, VICTORIA, B.C.</p>		<p>DESIGNATED FLOODPLAIN LIMIT</p> <p>FLOOD LEVEL</p> <p>200 Year Frequency</p> <p>20 Year Frequency</p> <p>(METRES - G.S.C. DATUM)</p>		<p>KEY MAP</p> <p>Scale 1:250 000</p>		<p>REVISIONS</p> <table border="1"> <thead> <tr> <th>No.</th> <th>DESCRIPTION</th> <th>DATE</th> </tr> </thead> <tbody> <tr> <td>1.</td> <td>Extends, revises and replaces Dwg. 87-17, Sheet 1 dated May 1987 and interim designated Sept. 30, 1988.</td> <td>Sept. 30, 1992</td> </tr> </tbody> </table>		No.	DESCRIPTION	DATE	1.	Extends, revises and replaces Dwg. 87-17, Sheet 1 dated May 1987 and interim designated Sept. 30, 1988.	Sept. 30, 1992	<p>ISSUE OF MAPPING</p> <p>DATE: Sept. 30, 1992</p> <p>DRAWN: M.W.</p> <p>CHECKED: C.N.</p> <p>RIVER SURVEY: M.P.</p> <p>DESIGNED:</p> <p>ENGINEER: V.J. Selay</p> <p>RECOMMENDED: [Signature]</p> <p>APPROVED: [Signature]</p>		<p>FLOODPLAIN MAPPING</p> <p>FRASER AND QUESNEL RIVERS AT QUESNEL</p> <p>Scale in metres</p> <p>100m 0 100 200 300 400 500m</p>		<p>ENVIRONMENT CANADA INLAND WATERS ENvironnement Canada Eaux Interieures</p> <p>BRITISH COLUMBIA MINISTRY OF ENVIRONMENT COLOMBIE-BRITANNIQUE MINISTÈRE DE L'ENVIRONNEMENT</p> <p>CANADA-BRITISH COLUMBIA FLOODPLAIN MAPPING AGREEMENT L'ACCORD CANADA-COLOMBIE-BRITANNIQUE SUR LA CARTOGRAPHIE DES PLAINES D'INONDATION</p> <p>FILE No. 100-0000-Q</p> <p>N.T.S. MAP No. 93B/15.16, 93G/1.2</p> <p>SCALE 1:5 000</p> <p>NEGATIVE No.</p> <p>DRAWING No. 89-43-3</p> <p>SHEET 3 of 5</p>	
No.	DESCRIPTION	DATE																			
1.	Extends, revises and replaces Dwg. 87-17, Sheet 1 dated May 1987 and interim designated Sept. 30, 1988.	Sept. 30, 1992																			