

**WATER LICENCE DISPOSITION RECORD**

File #: 0152961 Water Licence #: F014851

Stream Name: Lime and Alex Creeks

Date of Disposition: Mar 26, 2014

Abandoned

Cancelled

Refused

Superseded by Licence #/s: C131051  
\_\_\_\_\_  
\_\_\_\_\_  
\_\_\_\_\_

Close File?  Yes  No

Noted by: JR Date: Nov 25, 2014  
*(Financial Services Branch Representative)*

PROVINCE OF  
BRITISH COLUMBIA

# Water Rights Branch

DEPARTMENT OF  
LANDS AND FORESTS

## FINAL WATER LICENCE

**LEWIS DAVID WILLIAMS** of **R.R. #1,** is  
**Louis Creek, B.C.**

hereby authorized to **divert and use** water as follows:—

- (a) The source of the water-supply ~~is~~ **are Lime and Alex Creeks,** tributary of **Sinmax (Pass) Creek.**
- (b) The point of **diversion** <sup>are</sup> ~~is~~ located as shown on the attached plan.
- (c) The date from which this licence shall have precedence is **3rd June, 1945.**
- (d) The purpose for which the water is to be used is **irrigation.**
- (e) The maximum quantity of water which may be **diverted is 140 acre feet per annum,**  
and such additional quantity  
as the Engineer may from time to time determine should be allowed for losses.
- (f) The period of the year during which the water may be **used is 1st April to 30th September.**
- (g) The land upon which the water is to be used and to which this licence is appurtenant is  
**District Lots 831, 1209 and Easterly 10 chains of District Lot 2185 Kamloops  
Division of Yale District of which 70 acres may be irrigated.**
- (h) The works authorized hereunder are  
**Diversion Dams, Ditches and Flumes**  
located as shown on the attached plan.
- (i) This licence is issued in substitution of Conditional Water Licence No. **16092 and 17530.**

ENTERED ON  
Map No. **3600**  
By **NEL**

  
**E. H. TREDCROFT,**  
Comptroller of Water Rights.

1  
British



Columbia

To accompany Final Licence No. 14851

### KAMLOOPS WATER DISTRICT

Scale: 20 Chains to 1 Inch.

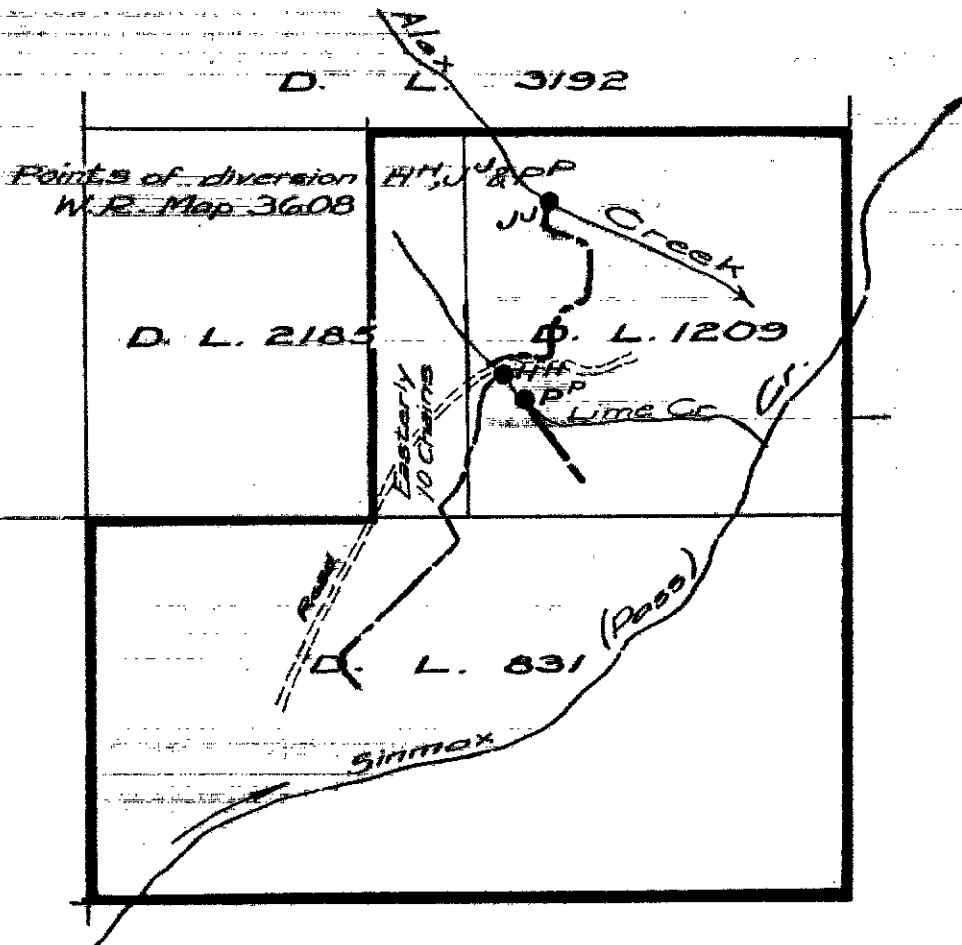

### KAMLOOPS DIV. OF YALE DISTRICT

#### LEGEND.

Point of Diversion ●

Ditch & Flume - - - - -

The boundaries of the land to which this licence is appurtenant are shown thus: —————

Signature E. H. W. B.

Date 1st Oct 1952

EXHIBIT "A"

FL (14851) for CL's 160922/17530

For Storage see F.L. 14852

File 0152361