

WATER LICENCE DISPOSITION RECORD

File #: 0159322 Water Licence #: C017042

Stream Name: Silvene Spring, Wrigglesworth Brook

Date of Disposition: Dec 17, 2014

Abandoned

Cancelled

Refused

Superseded by Licence #/s: _____

Close File? Yes No

Noted by: MD Date: Jan 6, 2014
(Financial Services Branch Representative)



Province of British Columbia
Water Act

ORDER
Section 23

File No. 0159322

In accordance with the Notice of Proposed Cancellation, dated the 17th day of November, 2014,
Conditional Water Licence C017042 is hereby cancelled.

Dated at Nanaimo, British Columbia, this 17th day of December, 2014.

Darryl Slater
Assistant Regional Water Manager

PROVINCE OF
BRITISH COLUMBIA.

WATER RIGHTS BRANCH.

DEPARTMENT OF
LANDS AND FORESTS.

CONDITIONAL WATER LICENCE.

HENRY M. JONES

of Malahat, P. O., B. C., is

hereby authorized to divert and use water as follows:—

- (a.) The sources of the water-supply ~~is~~ are Silvene Spring and Wrigglesworth Brook.
- (b.) The points of diversion ~~is~~ ^{are} located as shown on the attached plan.
- (c.) The date from which this licence shall have precedence is 4th February, 1946.
- (d.) The purpose for which the water is to be used is domestic.
- (e.) The maximum quantity of water which may be diverted is 500 gallons a day from Silvene Spring and 500 gallons a day from Wrigglesworth Brook.
- and such additional quantity
as the Engineer may from time to time determine should be allowed for losses.
- (f.) The period of the year during which the water may be used is the whole year.
- (g.) The land upon which the water is to be used and to which this licence is appurtenant is Parcel "E" (Certificate of Title 99836¹) of District Lot 51, Malahat District Victoria Land Registration District.
- (h.) The works authorized to be constructed are pipe line.

and they shall be located approximately as shown on the attached plan.

- (i.) The construction of the said works ~~shall be commenced on or before the~~ day
of ~~19~~ ^{has already been} and shall be completed and the water beneficially
used on or before the 31st day of December 1947.
- (j) This licence authorizes the use of water in the dwelling on the land described in clause (g) at the date hereof and in any dwelling built to replace the same but not in any other dwelling.

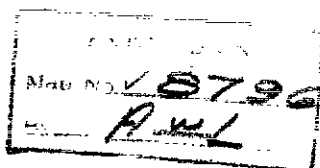

Comptroller of Water Rights.

4

British Columbia.



To accompany Conditional Licence No. 17042

VICTORIA WATER DISTRICT.

Scale, 20 Chains to 1 Inch.

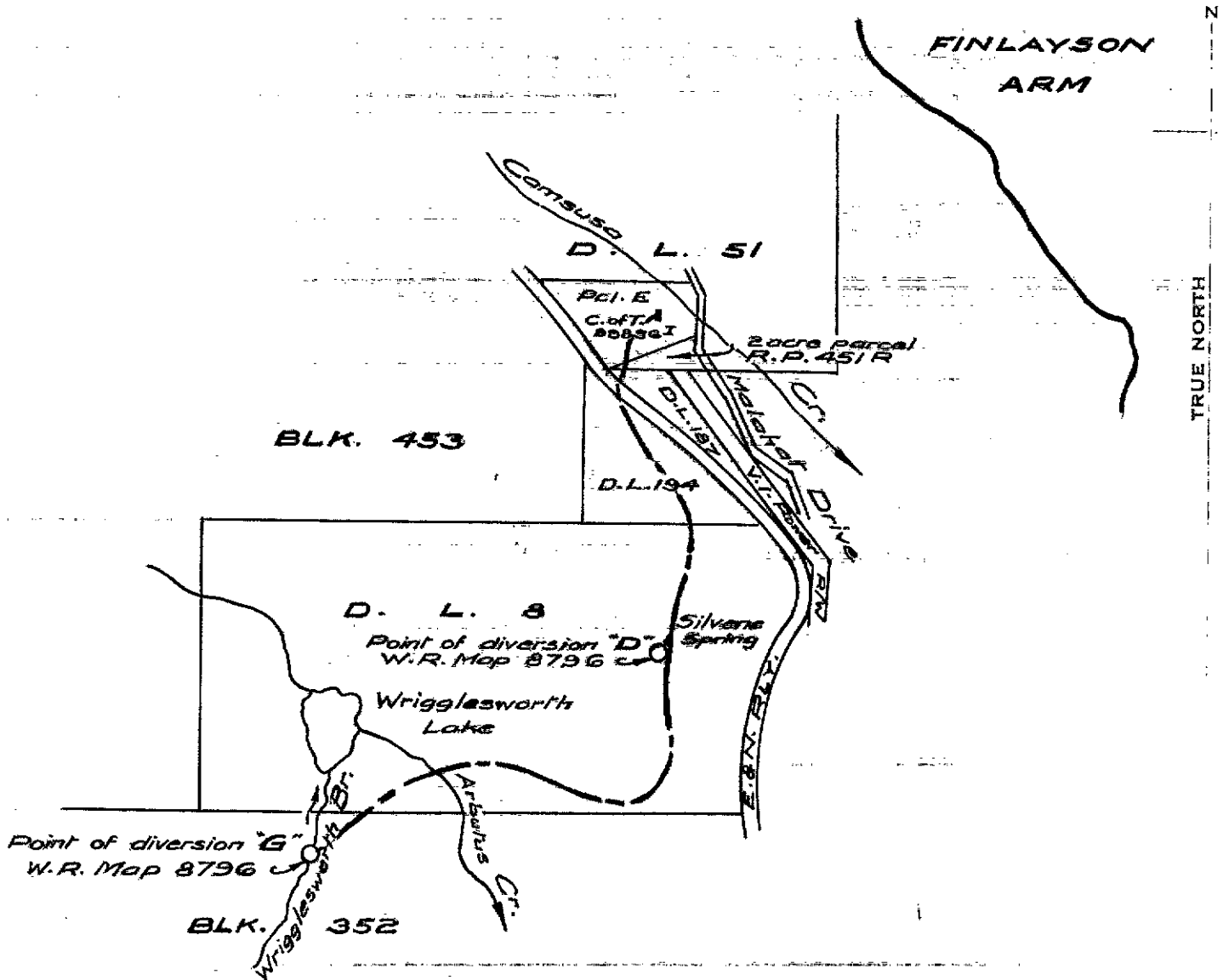

MALAHAT LAND DIST.
VICTORIA LAND REG DIST.

LEGEND

Points of diversion 
Pipe 

The boundaries of the land to which this licence is appurtenant are shown thus: 

Signature E. Davis.

Date 1st April, 1946

EXHIBIT "A"

C.L. 17042
File 0159322