

WATER LICENCE DISPOSITION RECORD

File #: 0156112 Water Licence #: C017044

Stream Name: Silvene Springs, Wigglesworth Brook

Date of Disposition: Dec 17, 2014

Abandoned

Cancelled

Refused

Superseded by Licence #/s: _____

Close File? Yes No

Noted by: MD Date: Jan 7, 2015
(Financial Services Branch Representative)



Province of British Columbia
Water Act

ORDER
Section 23

File No. 0156112

In accordance with the Notice of Proposed Cancellation, dated the 17th day of November, 2014,
Conditional Water Licence C017044 is hereby cancelled.

Dated at Nanaimo, British Columbia, this 17th day of December, 2014.

Darryl Slater
Assistant Regional Water Manager

PROVINCE OF
BRITISH COLUMBIA.

WATER RIGHTS BRANCH.

DEPARTMENT OF
LANDS AND FORESTS.

CONDITIONAL WATER LICENCE.

GEORGE MASONOS of Malahat, P. O., B. C., is

hereby authorized to divert and use water as follows:—

(a.) The sources of the water-supply ~~is~~ are Silvene Spring and Wrigglesworth Brook.(b.) The points of diversion ^{are} ~~is~~ located as shown on the attached plan.

(c.) The date from which this licence shall have precedence is 4th February, 1946.

(d.) The purpose for which the water is to be used is domestic.

(e.) The maximum quantity of water which may be diverted from Silvene Spring is 500 gallons a day and from Wrigglesworth Brook 500 gallons a day.

and such additional quantity as the Engineer may from time to time determine should be allowed for losses.

(f.) The period of the year during which the water may be used is the whole year.

(g.) The land upon which the water is to be used and to which this licence is appurtenant is Lot 187, Malahat District.

(h.) The works authorized to be constructed are pipe line.

and they shall be located approximately as shown on the attached plan.

(i.) The construction of the said works ~~shall be commenced on or before the~~ day ~~of~~ ^{has already been} ~~19-~~ and shall be completed and the water beneficially

used on or before the 31st day of December 19 47.

(j) This licence authorizes the use of water in the dwelling on the land described in clause (g) at the date hereof and in any dwelling built to replace the same but not in any other dwelling.

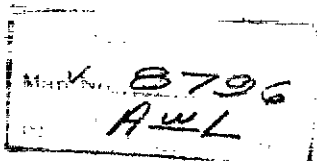

Comptroller of Water Rights.

British Columbia

To accompany Conditional Licence No. 17044

VICTORIA WATER DISTRICT.

Scale, 20 Chains to 1 Inch.

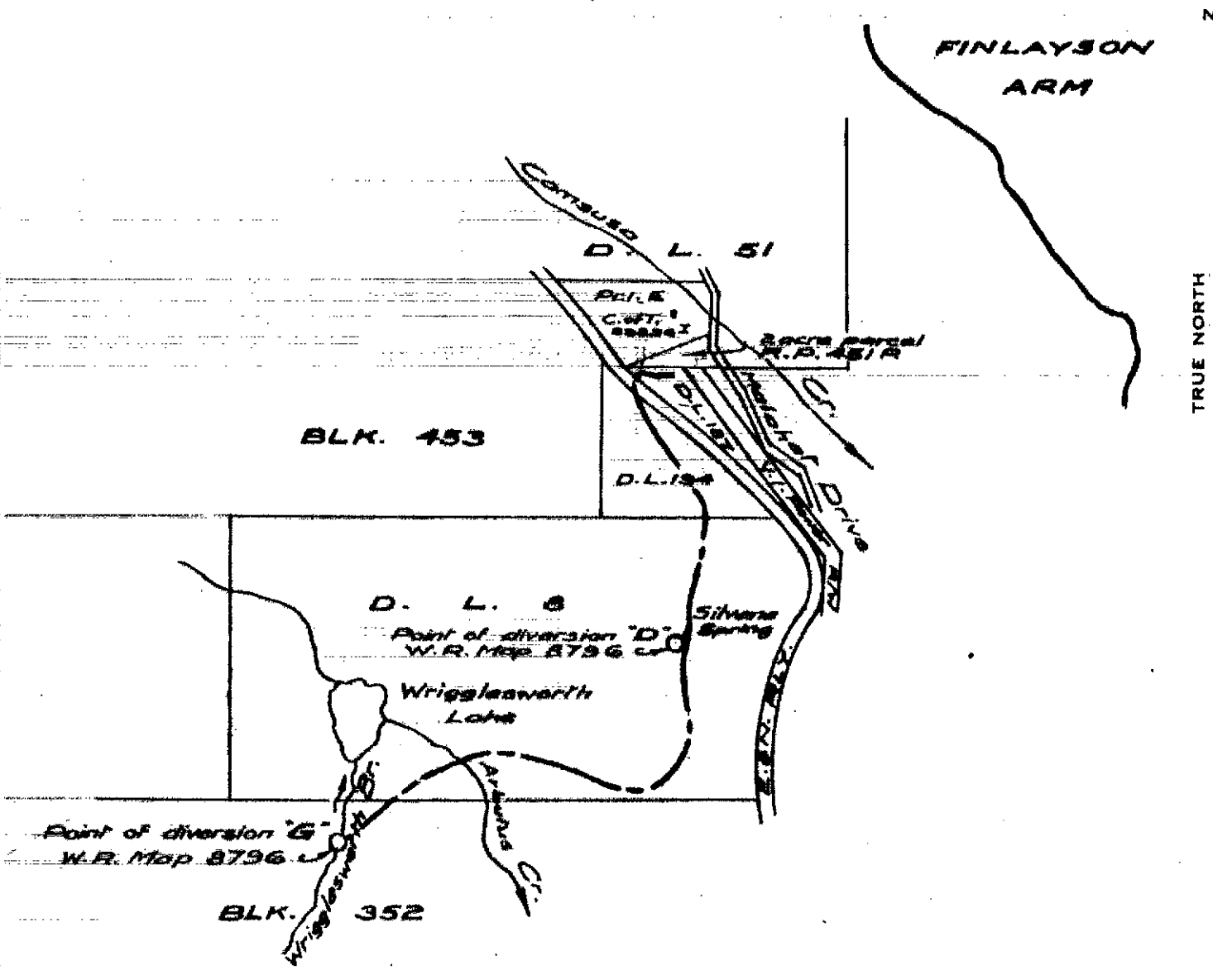

MALAHAT LAND DIST.
VICTORIA LAND REG DIST.

LEGEND
Points of diversion 
Pipe 

The boundaries of the land to which this licence is appertenant are shown thus: 

Signature *E. Davis*

Date *1st April, 1946*

EXHIBIT "A"

C.L. 17044
File 0156112

ORDER
WATER ACT

Section 16

FILE NO. 0156112

In the matter of Conditional Water Licence No. 17044, which authorizes the diversion of 500 gallons a day from Wrigglesworth Brook and 500 gallons a day from Silvene Spring for domestic use on Lot 187, Malahat District.

Having received an application for a Change of Appurtenancy from the owner of the above said land and being satisfied that no persons' rights will be injuriously affected. I hereby delete clause (i) and amend clauses (g) and (h) of the said licence to read as follows:

- (g) The land upon which the water is to be used and to which this licence is appurtenant is Parcel E (D.D. 99836¹) of Lot 51, Malahat District.
- (h) The works authorized hereunder are pipeline to be located approximately as shown on the attached amended plan the construction of which has already been commenced and shall be completed and the water beneficially used on or before 31st day of December, 1963.

Dated at Victoria, B.C. this 23rd day of July, 1962.

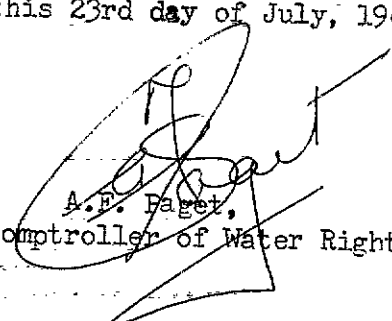
A.E. Paget,
Comptroller of Water Rights.

British Columbia

VICTORIA WATER DISTRICT.

Scale $\frac{1320 \text{ Feet}}{1 \text{ Inch}}$
Scale $\frac{203 \text{ Metres}}{1 \text{ Inch}}$

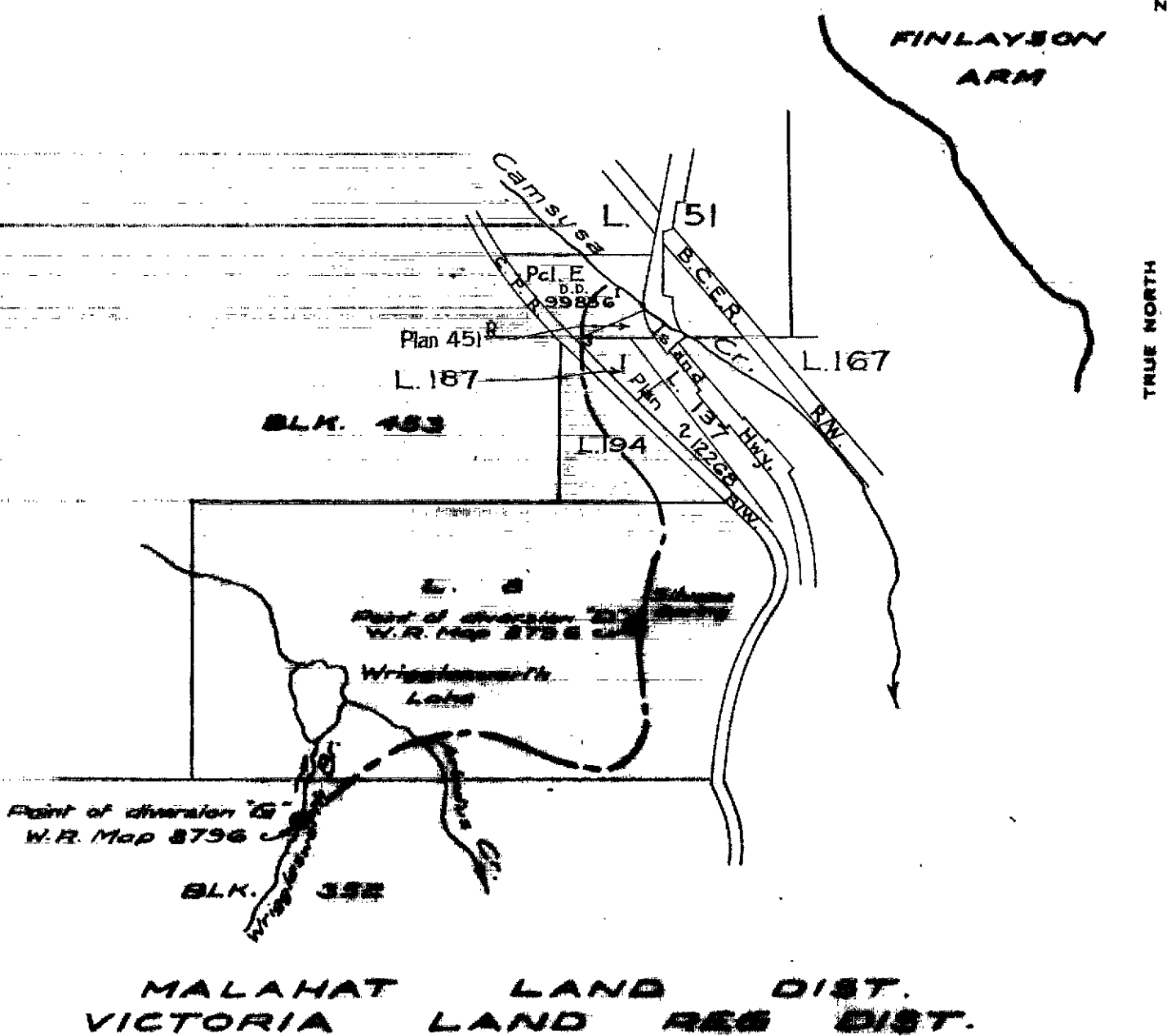

MALAHAT LAND DIST.
VICTORIA LAND REG DIST.

LEGEND

Points of diversion ●
Pipe — — — — —

The boundaries of the land to which this licence is appurtenant are shown ~~here~~

Signature

Date 23 July, 1962

Amended CL 17064

File 0156112

EXHIBIT "A"