

THE PROVINCE OF BRITISH COLUMBIA—WATER ACT
CONDITIONAL WATER LICENCE

Richard Henry Teese of **P.O. Box 403, Williams Lake, B.C.**

is/are hereby authorized to **divert and use** water as follows:—

(a) The source(s) of the water-supply is/are **Johnny Creek.**

(b) The point(s) of **diversion** is/are located as shown on the attached plan.

(c) The date from which this licence shall have precedence is **8th August, 1963.**

(d) The purpose for which the water is to be used is **domestic.**

(e) The maximum quantity of water which may be **diverted is 1500 gallons a day,**

and such additional quantity
as the Engineer may from time to time determine should be allowed for losses.

(f) The period of the year during which the water may be **used is the whole year.**

(g) The land upon which the water is to be used and to which this licence is appurtenant is
Lot 11397, Cariboo District.

(h) The works authorized to be constructed are **pump and pipe,**

and they shall be located approximately as shown on the attached plan.

(i) The construction of the said works **shall be commenced on or before the 30th day of September, 1965, and shall be completed and the water beneficially used on or before the 31st day of December, 1966.**

(j) **This licence authorizes the use of water in the first dwelling to be constructed on the land described in clause (g) or any dwelling replacing same but not in any other dwelling.**

R. D. DeBeck,

Deputy Comptroller of Water Rights.

FILE No. **6151575**

Date issued: **1 April 1965**

CONDITIONAL LICENCE No.

29796

FILE COPY

ASJ

Carroll J

British



Columbia

CARIBOO WATER DISTRICT
CARIBOO DISTRICT

Scale: { 1320 Feet to 1 Inch
20 Chains

TRUE NORTH

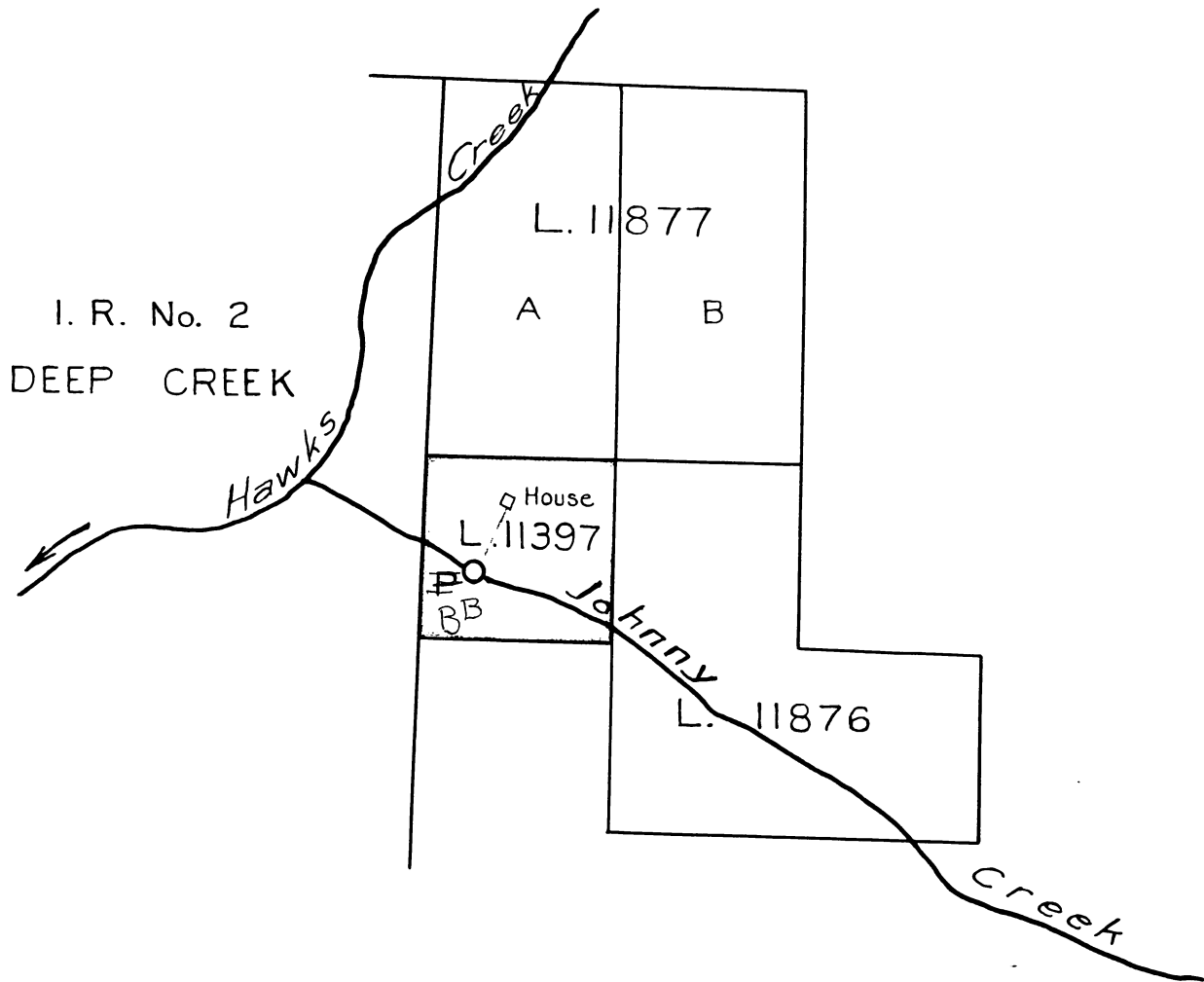

LEGEND

- Point of Diversion ○
- W.R. Map #60 1159
- Pipe ———

The boundaries of the land to which this licence is appurtenant are shown thus: _____

Signature *[Handwritten Signature]*

Date 1. April, 1965

CL 29796
File 0251575

EXHIBIT "A"