

WATER LICENCE DISPOSITION RECORD

File #: 0309134 Water Licence #: C040570

Stream Name: Cow Creek

Date of Disposition: Jun 27, 2014

☐ Abandoned

☐ Cancelled

☐ Refused

☒ Superseded by Licence #/s: C131593

Close File? ☐ Yes ☒ No

Noted by: MD Date: Dec 9, 2014
(Financial Services Branch Representative)

THE PROVINCE OF BRITISH COLUMBIA—WATER ACT
CONDITIONAL WATER LICENCE

Siegfried P. and Margarete L. Landrock of Box 2349, Smithers, B.C.

is/are hereby authorized to divert and use water as follows:—

- (a) The source(s) of the water-supply is/are Cow Creek.
- (b) The point(s) of diversion is/are located as shown on the attached plan.
- (c) The date from which this licence shall have precedence is 5th October, 1971.
- (d) The purpose for which the water is to be used is domestic.
- (e) The maximum quantity of water which may be diverted is 500 gallons a day,
and such additional quantity
as the Engineer may from time to time determine should be allowed for losses.
- (f) The period of the year during which the water may be used is the whole year.
- (g) The land upon which the water is to be used and to which this licence is appurtenant is
that part of East $\frac{1}{2}$ of Lot 1125, Range 5, Coast District,
lying north and west of Canadian National Railway Right of Way.
- (h) The works authorized to be constructed are diversion structure, pump and pipe,
which shall be located approximately as shown on the attached plan.
- (i) The construction of the said works shall be commenced on or before the 30th
day of September, 1973, and shall be completed and the water
beneficially used on or before the 31st day of December, 1976.
- (j) This licence authorizes the use of water for domestic purpose
in one dwelling located approximately as shown on the attached
plan.

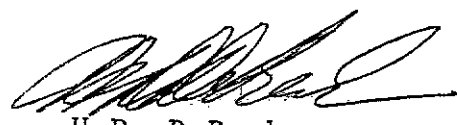
H.D. DeBeck,
Comptroller of Water Rights.

File No. 0309134 Date issued: March 15, 1973

Conditional Licence No. 40570

ENTERED ON
Map No. 93/NA-41
By  CB

93.L.094 (9059PA)

British



Columbia

HAZELTON WATER DISTRICT
RANGE 5 COAST DISTRICT

Scale: 1000 Feet to 1 Inch

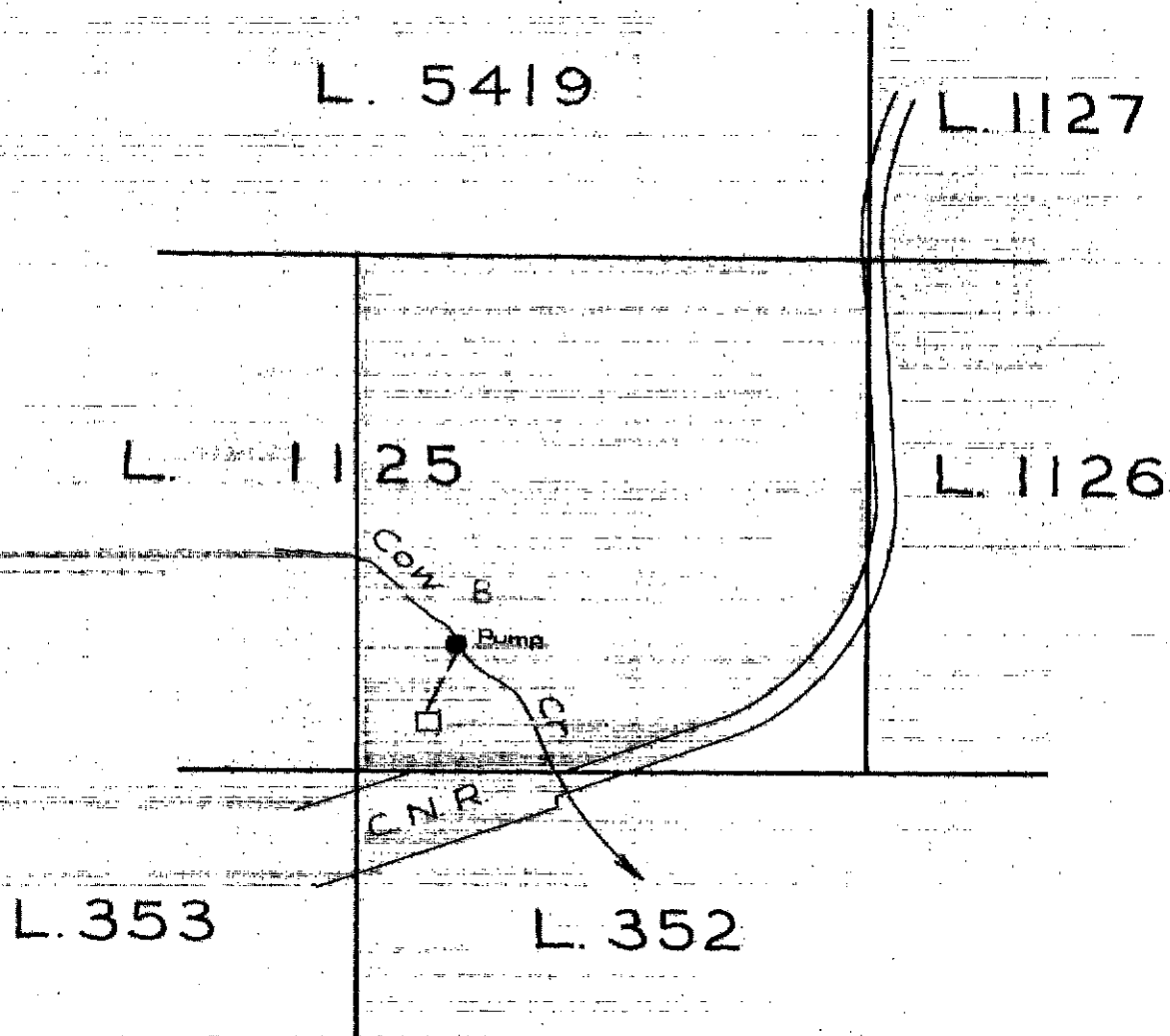

LEGEND

Point of Diversion

Ref. Map

Pipe

93 L. CRU (90599D)
93 L. NW (F. 4)

SMITHERS - PRECINCT

The boundaries of the land to which this licence
is appurtenant are shown thus:

Signature

Date 15th Mar 1973

CL 40570

ELC0309134