

THE PROVINCE OF BRITISH COLUMBIA—WATER ACT  
**CONDITIONAL WATER LICENCE**

**Lower Nicola Waterworks District of P.O. Box 18, Lower Nicola, B.C.**

is/are hereby authorized to **divert and use** water as follows:—

- (a) The source(s) of the water-supply is/are **Guichon Creek.**
- (b) The point(s) of **diversion** is/are located as shown on the attached plan.
- (c) The date from which this licence shall have precedence is **13th April, 1906.**
- (d) The purpose for which the water is to be used is **waterworks.**
- (e) The maximum quantity of water which may be **diverted is 95,000 gallons a day,**  
and such additional quantity  
as the Engineer may from time to time determine should be allowed for losses.
- (f) The period of the year during which the water may be **used is 1st April to 30th  
September.**
- (g) ~~The land upon which the water is to be used and to which~~ this licence is appurtenant is **to  
lands within the boundaries of Lower Nicola Waterworks  
District.**
- (h) The works authorized to be constructed are **diversion structure, pump, pipe,  
tank and distribution system,**  
which shall be located approximately as shown on the attached plan.
- (i) The construction of the said works **has been completed and the water shall be  
beneficially used on or before the 31st day of December, 1974.**
- (j) **This licence is issued in substitution of Final Water Licence  
8272, under Sections 15 and 16 of the Water Act.**

**H.D. DeBeck,**  
*Comptroller of Water Rights.*

File No. **0241667** Date issued: **November 1, 1973** Conditional Licence No. **41439**

o

**FILE COPY**



NICOLA WATER DISTRICT  
KAMLOOPS DIVISION OF YALE DISTRICT

Scale 500 feet to 1 Inch

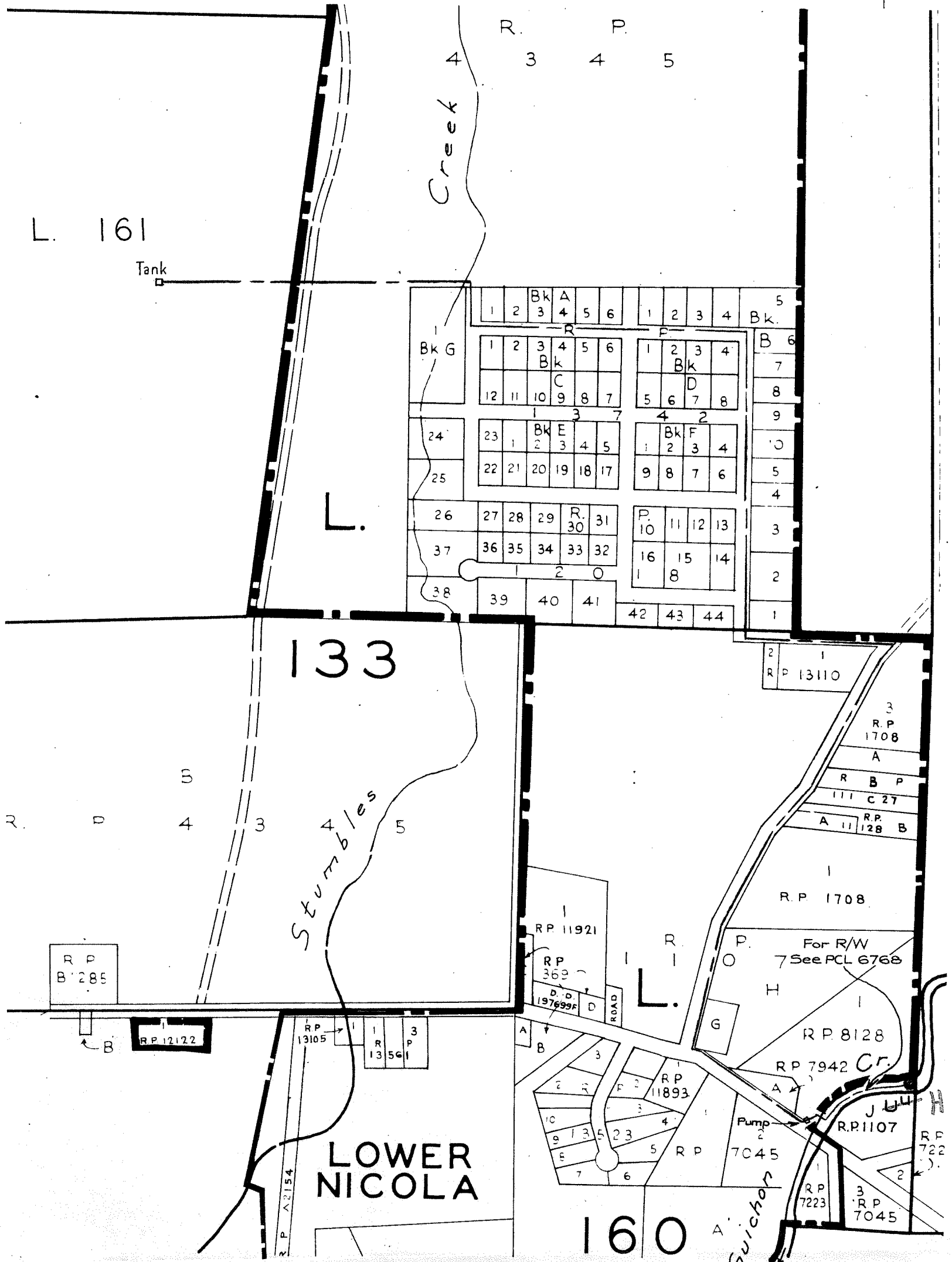

LEGEND

Point of Diversion ● 92101641  
 W.R. Map 6006-A  
 Pipe - - - - -

The boundaries of the Lower Nicola Waterworks District are shown thus: **—————**

Signature *[Handwritten Signature]*

Date 1<sup>st</sup> Nov. 1973  
 C.L. 41439 for F.L. 8272  
 File 0241667

EXHIBIT "A"

Lower Nicola Precinct  
 For Storage See F.L. 9672