

THE PROVINCE OF BRITISH COLUMBIA—WATER ACT
CONDITIONAL WATER LICENCE

Raymond and Stewart Pakka of R. R. #1, Sorrento, B. C. VOE 2W0

are hereby authorized to divert and use water as follows:

- (a) The source of the water-supply is White Lake.
- (b) The point of diversion is located as shown on the attached plan.
- (c) The date from which this licence shall have precedence is 28th May, 1980.
- (d) The purpose for which the water is to be used is domestic.
- (e) The maximum quantity of water which may be diverted is 500 gallons a day, and such additional quantity as the Engineer may from time to time determine should be allowed for losses.
- (f) The period of the year during which the water may be used is the whole year.
- (g) The land upon which the water is to be used and to which this licence is appurtenant is that part of Legal Subdivision 5 of Section 14, Township 22, Range 10, West of the 6th Meridian, Kamloops Division of Yale District, lying east of Plan H 11659.
- (h) The works authorized to be constructed are diversion structure, pump and pipe, which shall be located approximately as shown on the attached plan.
- (i) The construction of the said works has been commenced and shall be completed and the water beneficially used on or before the 31st day of December, 1986.
- (j) This licence authorizes the use of water for domestic purpose in one dwelling located approximately as shown on the attached plan.



Deputy Comptroller of Water Rights

File No. 0366629

Date issued: 30th April, 1984

Conditional Licence 60569

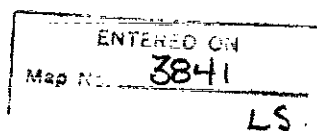



Province of British Columbia

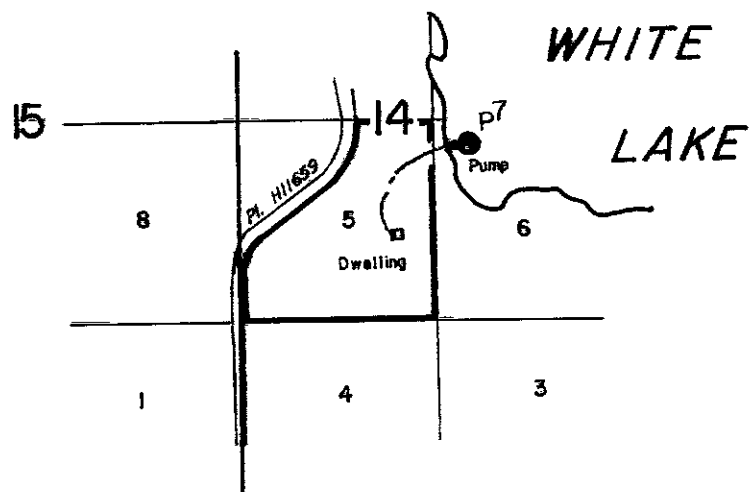

TP. 22 R. 10 W. 6M.



WATER DISTRICT : KAMLOOPS
PRECINCT : SEYMOUR
LAND DISTRICT : KAMLOOPS DIVISION OF YALE

Signature [Signature]

Date 30th Apr. 1984.

LEGEND

Scale : 20 Chains to 1 Inch
Point of Diversion : ●
Map Number : WR 3841
Pipe : _____
Permit over Crown Land: XXXXXXXXXX

C.L. 60569
File 0366629
P.C.L. 14303

The boundaries of the land to which this licence
is appurtenant are shown thus: XXXXXXXXXX