

THE PROVINCE OF BRITISH COLUMBIA—WATER ACT
CONDITIONAL WATER LICENCE

Clyde H. Coates of Box 1000, Gabriola Island, B. C. V0R 1X0

is hereby authorized to divert and use water as follows:

- (a) The source of the water supply is Hoggan Lake.
- (b) The point of diversion is located as shown on the attached plan.
- (c) The date from which this licence shall have precedence is 25th November, 1971.
- (d) The purpose for which the water is to be used is industrial (golf course).
- (e) The maximum quantity of water which may be diverted is 48.2 acre feet per annum, and such additional quantity as the Engineer may from time to time determine should be allowed for losses.
- (f) The period of the year during which the water may be used is 1st April to 30th September.
- (g) The land upon which the water is to be used and to which this licence is appurtenant is the Fractional North East 1/4 of Section 11, except Plans 12120 and 30051 and part shown as road on Plan 29152; the Fractional East 1/2 of the North West 1/4 of Section 11; the East 1/2 of the Fractional South West 1/4 of Section 11; and the Fractional South East 1/4 of Section 11, except Plan 30051 and part shown as road on Plan 29152, all within Gabriola Island, Nanaimo District.
- (h) The works authorized to be constructed are diversion structure, pump, pipe, tank and sprinkler system, which shall be located approximately as shown on the attached plan.
- (i) The construction of the said works has been commenced and shall be completed and the water beneficially used on or before the 31st day of December, 1987.
- (j) This licence is issued in substitution of Conditional Water Licence 43115, in part, under Sections 15 and 20 of the Water Act.



J. E. Farrell,
Deputy Comptroller of Water Rights.



NANAIMO WATER DISTRICT

NANAIMO DISTRICT

Scale: 1 : 5000

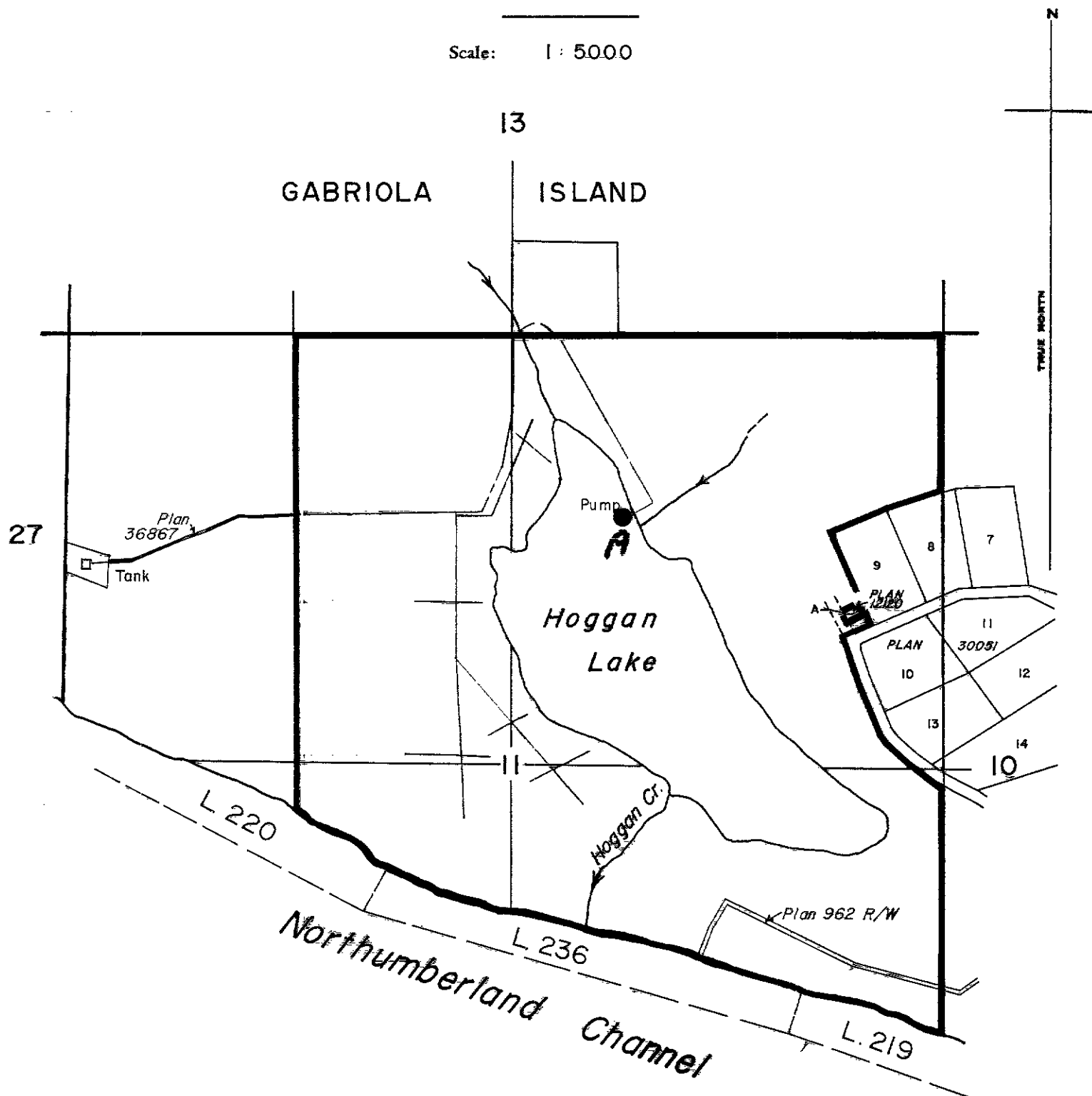

LEGEND

Point of Diversion ●

Ref. Map

92-674(1) 92.G.011-4-2

Pipe

The boundaries of the land to which this licence is appurtenant are shown thus: **—————**

Signature: *[Handwritten Signature]*

Date: **FEB 12 1985**

C.L. 62078 for C.L. 43115 in part
File 0309323

Nanaimo Precinct.
For Storage See C.L. 62080

ORDER

Water Act

Section 18 (e)

File No: 0309323

In the matter of Conditional Water Licence No. C062078 which authorizes the diversion and use of 59,454 cubic metres (48.2 acre feet) per year of water from Hoggan Lake for industrial (golf course) purpose and is appurtenant to the Fractional North East 1/4 of Section 11, except Plans 12120 and 30051 and part shown as road on Plan 29152; the Fractional East 1/2 of the North West 1/4 of Section 11; the East 1/2 of the Fractional South West 1/4 of Section 11; and the Fractional South East 1/4 of Section 11, except Plan 30051 and part shown as road on Plan 29152, all within Gabriola Island, Nanaimo District.

Having determined that the appurtenancy is inadequately described in the licence, and being satisfied that no person's rights will be injuriously affected, I hereby amend the licence to read as follows:

- (g) The land upon which the water is to be used and to which this licence is appurtenant is the North East 1/4 of Section 11, except those parts in Plans 12120, 29152 and 30051; the East 1/2 of the North West 1/4 of Section 11; Lot 1, of District Lot 478, and of Section 11, Plan VIP57010; and Lot 2, of District Lot 467, and of Section 11, Plan VIP57010, all within Gabriola Island, Nanaimo District.
- (h) The works authorized to be constructed are diversion structure, pump, pipe, tank and sprinkler system, which shall be located approximately as shown on the attached plan, and is effective on the date of this Order.

DATED at Nanaimo, British Columbia, this 11th day of March, 2015.



Darryl Slater
Assistant Regional Water Manager



BRITISH COLUMBIA

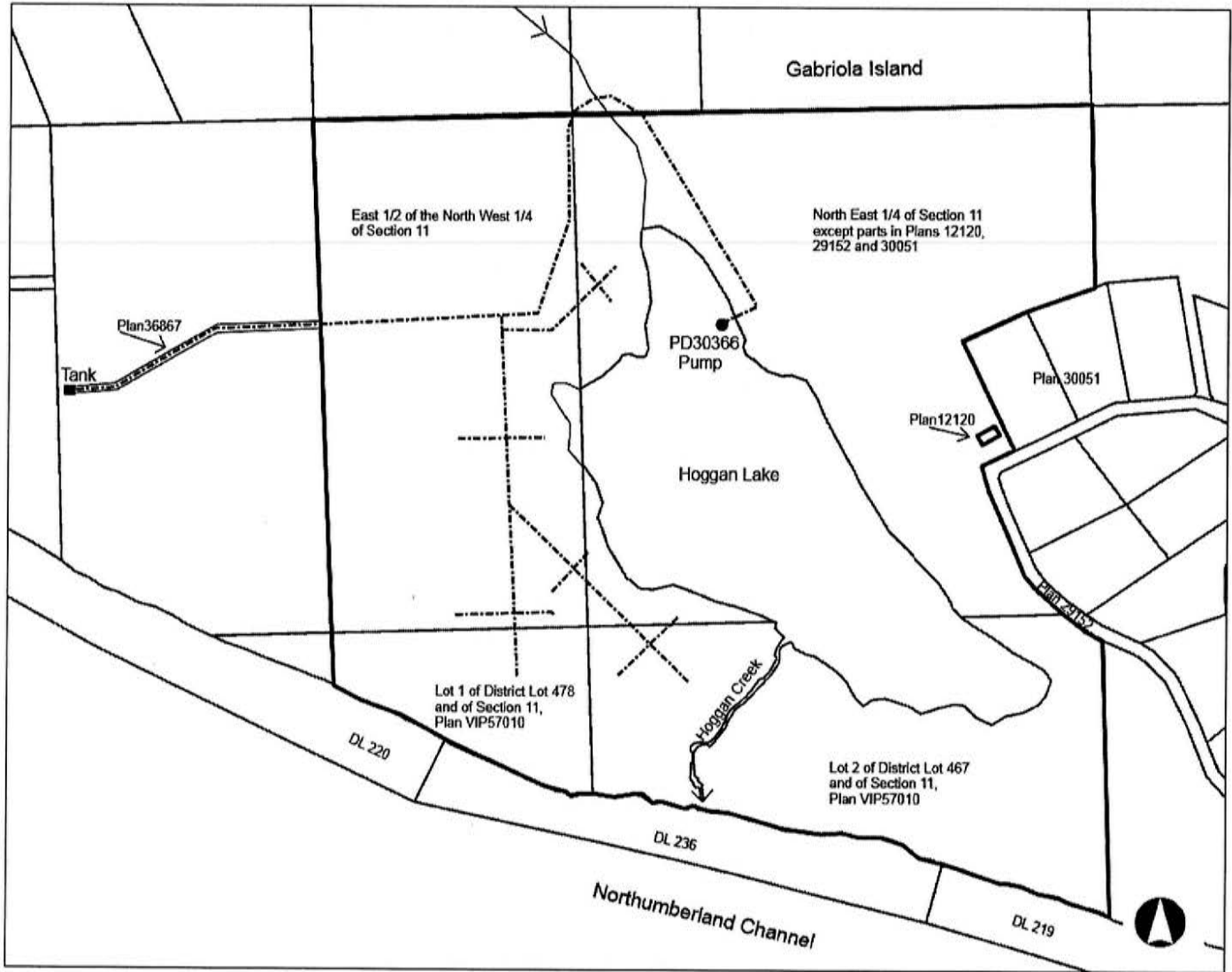

WATER DISTRICT: Nanaimo
 PRECINCT: Nanaimo
 LAND DISTRICT: Nanaimo

Signature: *[Handwritten Signature]*
 Date: MAR 11 2015

LEGEND:

Scale: 1: 10,000

Point of Division: ●

Map Number: 92G.011.2.4

Pipe: - · - · - · - ·

Amended C.L. C062078

File 0309323

P.C.L. Not applicable

Amended by Order

The boundaries of the land to which this licence is appurtenant are shown thus: —————