

WATER LICENCE DISPOSITION RECORD

File #: 1000469 Water Licence #: C063922

Stream Name: Hoggan Creek

Date of Disposition: Dec 18, 2013

Abandoned

Cancelled

Refused

Superseded by Licence #/s: C063922 _____

Close File?

Yes

No

Noted by: MD

Date: Dec 12, 2014

(Financial Services Branch Representative)

THE PROVINCE OF BRITISH COLUMBIA—WATER ACT

CONDITIONAL WATER LICENCE

Clyde Harvey Coats of P.O. Box 1000, Gabriola Island, British Columbia VOR 1X0
is hereby authorized to divert and use water as follows:

- (a) The source of the water supply is Hoggan Lake.
- (b) The point of diversion is located as shown on the attached plan.
- (c) The date from which this licence shall have precedence is 15th May, 1985.
- (d) The purpose for which is licence is issued is power (general).
- (e) The maximum quantity of water which may be diverted is 13 cubic feet per second.
- (f) The period of the year during which the water may be used is the whole year.
- (g) The land upon which the water is to be used is the Fractional South East 1/4 of Section 11, Gabriola Island, Nanaimo District except plans 30051 & 29152 on which a powerhouse is situated, and the land to which this licence is appurtenant is the said lot.
- (h) The works authorized to be constructed are diversion structure, penstock, powerhouse and transmission line, which shall be located approximately as shown on the attached plan.
- (i) The construction of the said works shall be completed and the water beneficially used on or before the 31st day of December, 1989.
- (j) The rights granted under this licence may be deemed to be subsequent to any rights granted under any licence or licences that may be issued at any time for the consumptive use of water.

B. Hollingshead
Regional Water Manager



Province of British Columbia

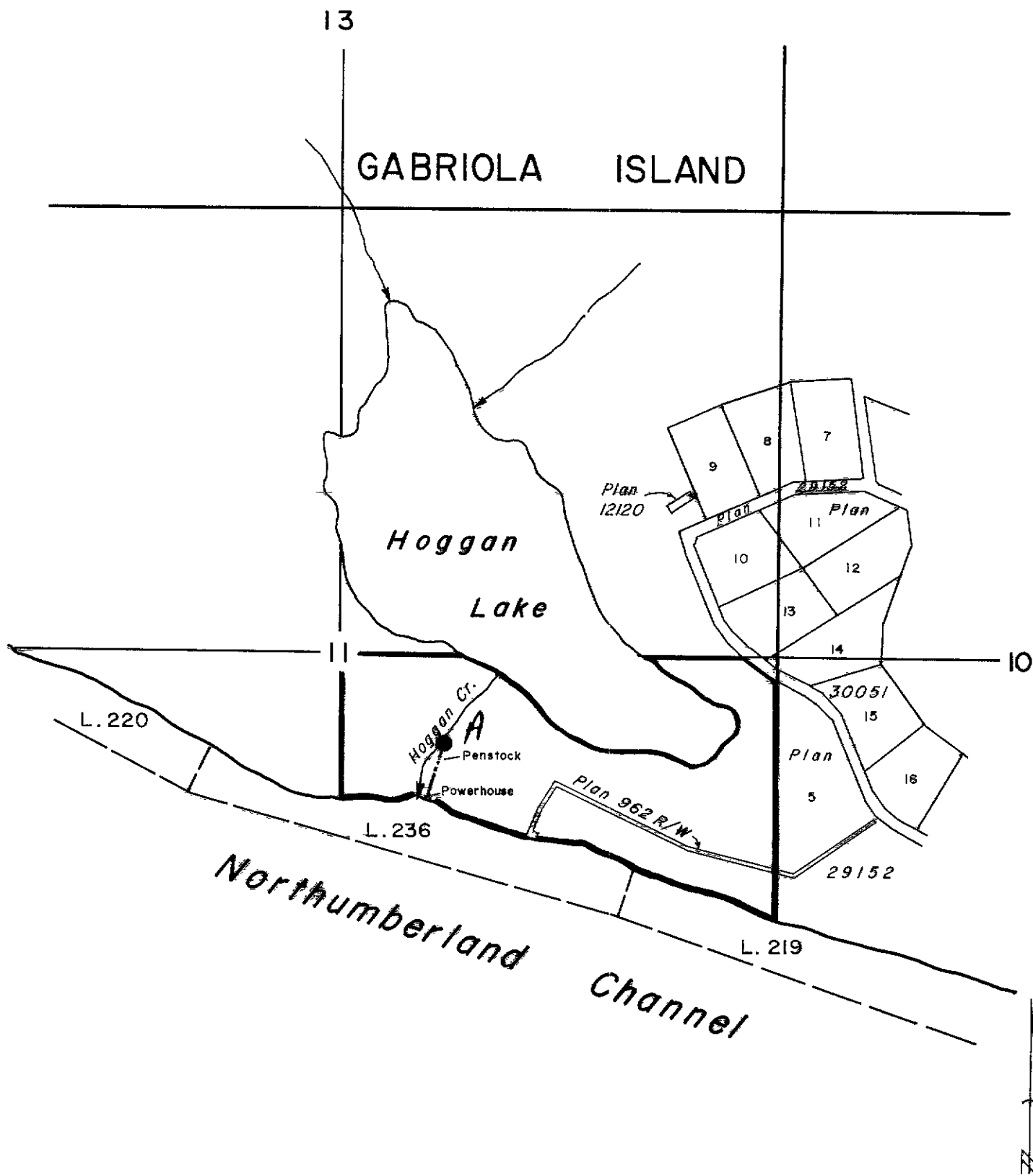

WATER DISTRICT : NANAIMO
 PRECINCT : NANAIMO
 LAND DISTRICT : NANAIMO

LEGEND

Scale : 1:10,000
 Point of Diversion : ●
 Map Number : ~~WR 926/A (1)~~ 92.6.0112.4
 Transmission Line : ———

Signature: *[Handwritten Signature]*
 Date: June 10, 1986

C.L. 63922
 File 1000469

For Storage see C.L. 63923

The boundaries of the land to which this licence is appurtenant are shown thus: —————