

## WATER LICENCE DISPOSITION RECORD

File #: 0368961      Water Licence #: C067056

Stream Name: Jesmond Creek

Date of Disposition: Feb 20, 2014

Recorded as Abandoned

Recorded as Cancelled

Superseded by Licence #/s: C130124 \_\_\_\_\_  
\_\_\_\_\_  
\_\_\_\_\_  
\_\_\_\_\_

Close File?       Yes       No

Noted by: EB      Date: Dec 12, 2014  
*(Financial Services Branch Representative)*

THE PROVINCE OF BRITISH COLUMBIA—WATER ACT  
CONDITIONAL WATER LICENCE

Henry W. Coldwell of Jesmond, Clinton, B.C. V0K 1K0

is hereby authorized to divert and use water as follows:

- (a) The stream on which the rights are granted is Jesmond Creek.
- (b) The point of diversion is located as shown on the attached plan.
- (c) The date from which this licence shall have precedence is 28th July, 1981.
- (d) The purpose for which this licence is issued is irrigation.
- (e) The maximum quantity of water which may be diverted is 34.0 acre-feet per annum.
- (f) The period of the year during which the water may be used is 1st April to 30th September.
- (g) The land upon which the water is to be used and to which this licence is appurtenant is Lot 150 and Lot 3456, Lillooet District, of which 17 acres may be irrigated.
- (h) The authorized works are diversion structure, ditch, pipe and sprinkler system, located approximately as shown on the attached plan.
- (i) The construction of the said works shall be completed and the water beneficially used prior to the 31st day of December, 1991. Thereafter, the licensee shall continue to make beneficial use of the water in the manner authorized herein.

  
A.D. Zackodnik, P. Eng.  
Regional Water Manager

File:0368961 Date Issued: FEB 23 1989 Conditional Licence: 67056



Province of British Columbia

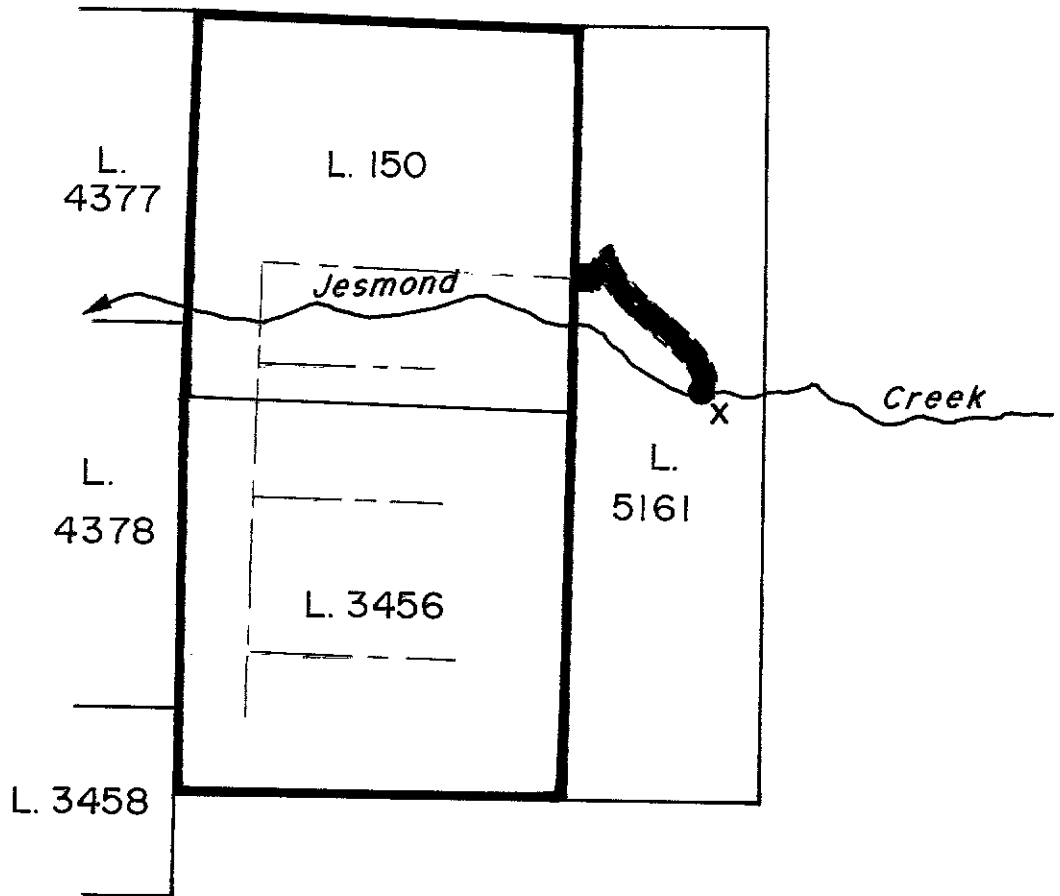

WATER DISTRICT : ASHCROFT  
 PRECINCT : PAVILION  
 LAND DISTRICT : LILLOOET

LEGEND

Scale : 20 chains to 1 inch  
 Point of Diversion : ●  
 Map Number : WR 260  
 Pipe : \_\_\_\_\_  
 Permit over Crown Land: ~~\_\_\_\_\_~~

Signature *Ch. Zachodnik*  
 Date FEB 23 1989

C.L. 67056  
 File 0368961  
 P.C.L. 17048

The boundaries of the land to which this licence is appurtenant are shown thus: **\_\_\_\_\_**