

WATER LICENCE DISPOSITION RECORD

File #: 1001860 Water Licence #: C109960

Stream Name: Kitsucksus Creek

Date of Disposition: Oct 15, 2014

Abandoned

Cancelled

Refused

Superseded by Licence #/s: C131738

Close File? Yes No

Noted by: JR Date: Dec 9, 2014
(Financial Services Branch Representative)

THE PROVINCE OF BRITISH COLUMBIA—WATER ACT

CONDITIONAL WATER LICENCE

The owners of the land to which this licence is appurtenant are hereby authorized to divert and store water as follows:

- (a) The source of the water-supply is Kitsucksus Creek.
- (b) The point of diversion is located as shown on the attached plan.
- (c) The date from which this licence shall have precedence is 18th July, 1995.
- (d) The purpose for which this licence is issued is industrial (log pond).
- (e) The maximum quantity of water which may be diverted and held in storage is 1.7 acre feet per annum.
- (f) The period of the year during which the water may be used for industrial purpose is the whole year.
- (g) The land upon which the water is to be used and to which this licence is appurtenant is Lot A, District Lot 106, Alberni, District, Plan VIP57991.
- (h) The works authorized to be constructed are dam, spillway, fishway, and dugout, which shall be located approximately as shown on the attached plan.
- (i) The construction of the said works has commenced and it shall be completed and the rights exercised, on or before 31st December, 1999.
- (j) The licensee shall make releases of water past the dam authorized under Clause (h) hereof, as may, from time to time, be ordered by the engineer under the Water Act, to maintain a minimum flow in the stream.
- (k) On or before 31st December, 1999, the licensee shall submit to the Regional Water Manager, for approval, an operations and maintenance manual, which has been prepared by a Professional Engineer registered in BC, for the dam, spillway, and fishway, authorized under Clause (h) hereof. Operation and maintenance of the said works shall be in compliance with procedures described in that manual.

B. Hollingshead
Regional Water Manager



Province of British Columbia

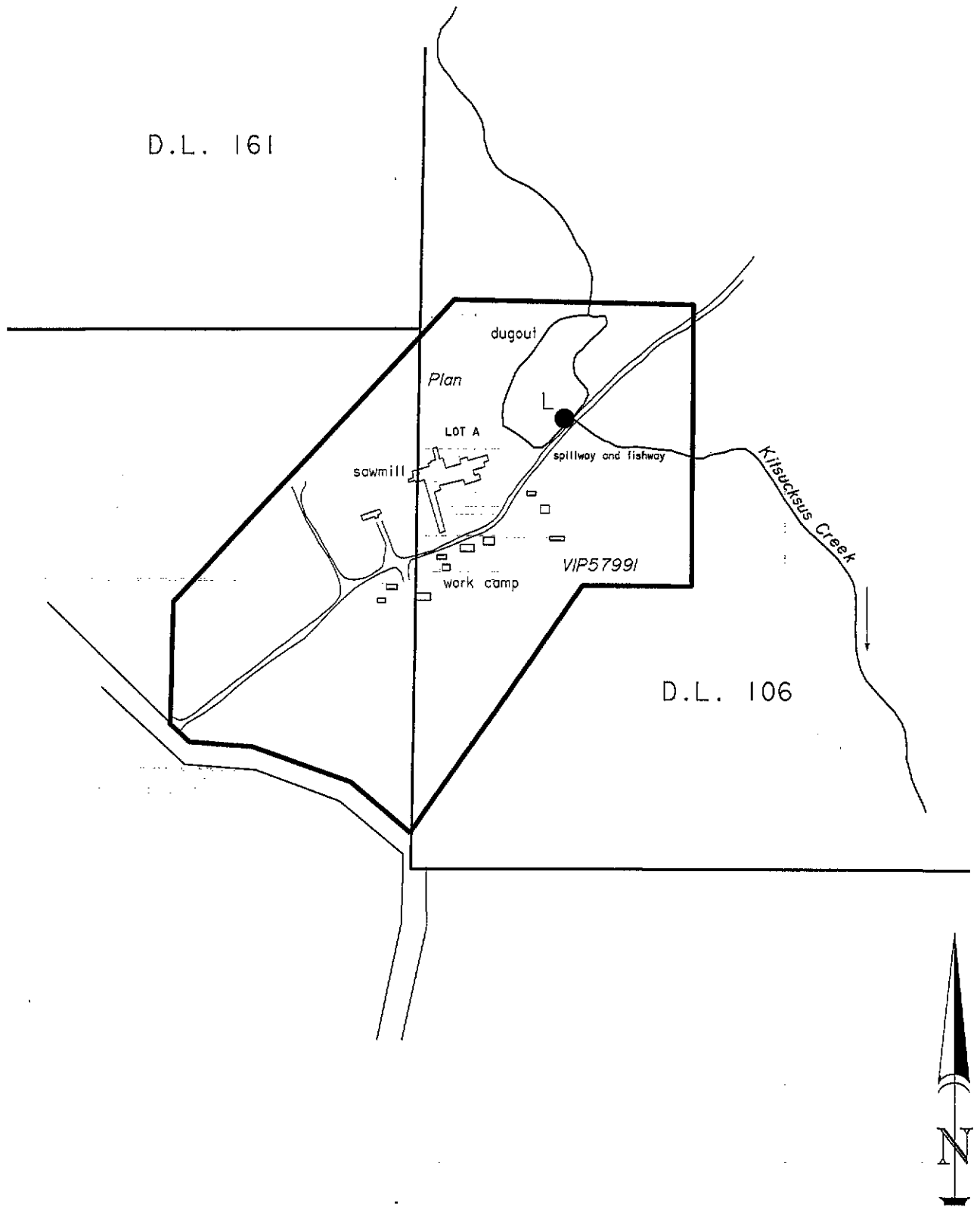

WATER DISTRICT : ALBERNI
 PRECINCT : ALBERNI
 LAND DISTRICT : ALBERNI

LEGEND

Scale : 1:5000
 Dam :
 Map Number : WR 92.F.036.2.2
 Pipe :

Signature:
 Date: 14 February 1996

C.L. 109960
 File 1001860

The boundaries of the land to which this licence is appurtenant are shown thus: