

WATER LICENCE DISPOSITION RECORD

File #: 0067398 Water Licence #: C110613

Stream Name: Kitsucksus Creek

Date of Disposition: Oct 15, 2014

Abandoned

Cancelled

Refused

Superseded by Licence #/s: C131733 _____

Close File? Yes No

Noted by: JR Date: Dec 9, 2014
(Financial Services Branch Representative)

THE PROVINCE OF BRITISH COLUMBIA—WATER ACT

CONDITIONAL WATER LICENCE

The owners of the land to which this licence is appurtenant are hereby authorized to divert, store, and use water as follows:

- (a) The source of the water-supply is Kitsucksus Creek.
- (b) The point of diversion is located as shown on the attached plan.
- (c) The date from which this licence shall have precedence is 25th March, 1926.
- (d) The purposes for which this licence is issued are industrial (e - log pond) and industrial (i - steam production & work camp).
- (e) The maximum quantity of water which may be diverted into storage is 2.5 acre feet per annum; the maximum quantity which may be used for industrial (log pond) purpose is 1.5 acre feet per annum, and the maximum quantity which may be used for Industrial (steam/work camp) purpose is 1000 gallons a day.
- (f) The period of the year during which the water may be held in storage and used for industrial purposes is the whole year.
- (g) The land upon which the water is to be used and to which this licence is appurtenant is Lot A, District Lot 106, Alberni, District, Plan VIP57991.
- (h) The works authorized to be constructed are dam, spillway, fishway, dugout, pump, and pipe, which shall be located approximately as shown on the attached plan.
- (i) The intake shall be adequately screened to prevent debris and fish from entering the works.
- (j) The construction of the said works has commenced and it shall be completed and the rights exercised, on or before 31st December, 1999.
- (k) The licensee shall make releases of water past the dam authorized under Clause (h) hereof, as may, from time to time, be ordered by the engineer under the Water Act, to maintain a minimum flow in the stream.
- (l) On or before 31st December, 1999, the licensee shall submit to the Regional Water Manager, for approval, an operations and maintenance manual, which has been prepared by a Professional Engineer Registered in BC, for the dam, spillway, and fishway, authorized under Clause (h) hereof. Operation and maintenance of the said works shall be in compliance with procedures described in that manual.
- (m) This licence authorizes the use of water for industrial (work camp) purpose in those buildings associated with the sawmill, located approximately as shown on the attached plan.
- (n) This licence is issued in substitution of Final Water Licence 7341, under Section 15 of the Water Act.



B. Hollingshead
Regional Water Manager



Province of British Columbia

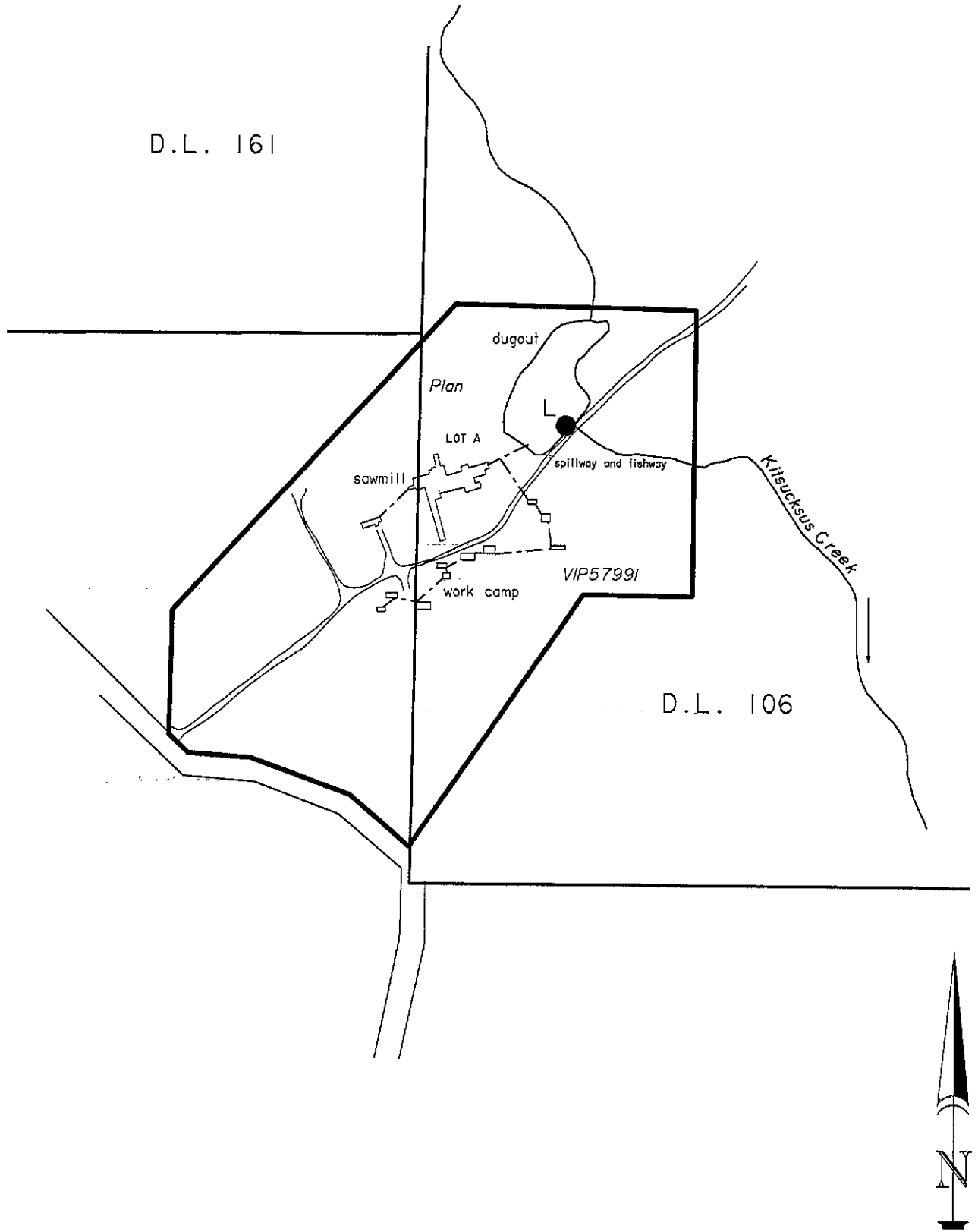

WATER DISTRICT : ALBERNI
 PRECINCT : ALBERNI
 LAND DISTRICT : ALBERNI

LEGEND

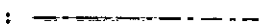
Scale : 1:5000
 Dam : 
 Map Number : WR 92.F.036.2.2
 Pipe : 

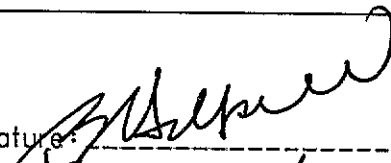
Signature: 
 Date: February 1996

C.L. 110613 for F.L. 7341
 File 0067398

The boundaries of the land to which this licence is appurtenant are shown thus: 