CONDITIONAL WATER LICENCE

The owners of the land to which this licence is appurtenant are hereby authorized to divert and use water as follows:

- (a) The source on which the rights are granted is Shatford Creek with storage in Aeneas Lake.
- (b) The points of diversion and rediversion are located as shown on the attached plan.
- (c) The date from which this licence shall have precedence is 25th October, 1996.
- (d) The purposes for which this licence is issued are storage and irrigation.
- (e) The maximum quantity of water which may be diverted into storage is 20 acre feet per annum and the quantity of stored water which may be used for irrigation purpose is 20 acre feet per annum.
- (f) The period of the year during which the water may be diverted into storage is 1st October to 15th June and the period of year during which the stored water may be used for irrigation purpose is 1st April to 30th September.
- (g) The land upon which the water is to be used and to which this licence is appurtenant is Lot 4, District Lot 214S and of Section 23, Township 88, Similkameen Division Yale District, Plan 23700, except Plan H15201, of which 10 acres may be irrigated.
- (h) The authorized works are screened intakes, flume, pipe, siphon, ditch, reservoir, dam and sprinkler system which shall be located approximately as shown on the attached plan.
- (i) The construction of the said works shall be completed and the water shall be beneficially used prior to the 31st day of December 2007. Thereafter, the licensee shall continue to make regular beneficial use of the water in the manner authorized herein.
- (j) The dam authorized under clause (h) is subject to the Dam Safety Regulations and shall be designed, constructed and maintained to the satisfaction of a Dam Safety Officer under the Water Act and in accordance with the Canadian Dam Association Guidelines.
- (k) The construction and/or reconstruction of the works shall not commence until plans prepared by professional engineer registered in British Columbia have been submitted to and written leave to commence construction granted by the Engineer under the Water Act.
- (l) Any water diverted and used pursuant to this licence during the period from 1st April to 30th September, must be taken from storage provided in the reservoir authorized under C111679, or any licence issued in substitution thereof.

- (m) This licence is issued pursuant to the provisions of the Water Act to ensure compliance with that statute, which makes it an offence to divert or use water from a stream in British Columbia without proper authorization. It is the responsibility of the licensee to ensure that all activities conducted under this authorization are carried out with regard to the rights of third parties, and comply with other applicable legislation that may be in force.



Don I. McKee, P.Eng.
Assistant Regional Water Manager
Southern Service Region – Kamloops Service Centre
Land & Water Management Division

Date Issued: March 17, 2004

File: 8002508

CONDITIONAL LICENCE: 111679

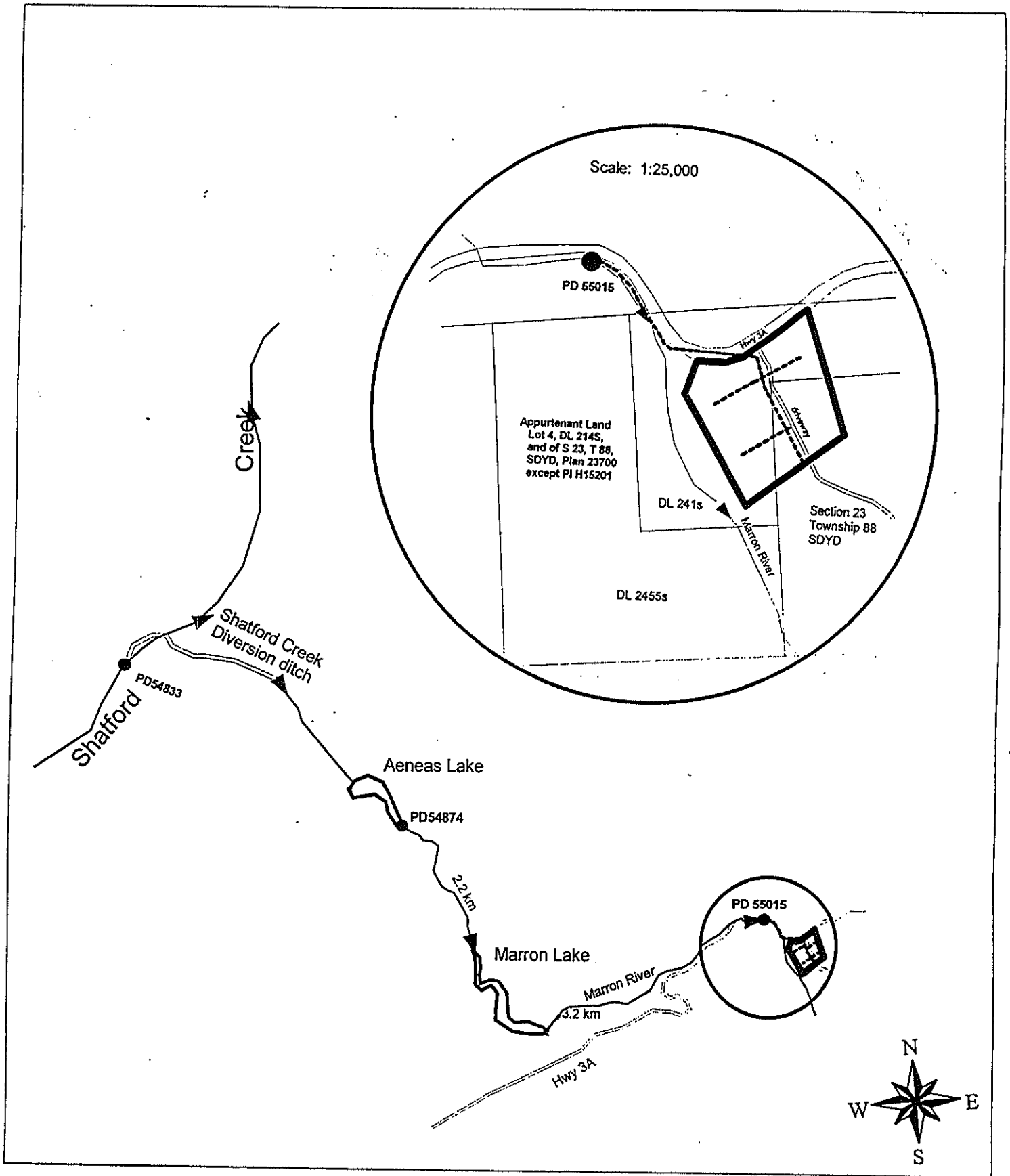

WATER DISTRICT:
PRECINCT:
LAND DISTRICT:

PENTICTON
PENTICTON
SIMILKAMEEN DIV YALE DIST

Signature: _____

Date: _____

MAR 17 2004

LEGEND:

Scale:

1:68,000

Point of Diversion:



Map Number:

82. E. 032. 4. 4

Pipe:



C.L. 111679
File 8002508

The boundaries of the land to which this licence is appurtenant are shown thus: 