

Province of British Columbia

Water Act

CONDITIONAL WATER LICENCE

The holder of the placer tenure to which this licence is appurtenant is hereby authorized to divert and use water as follows:

- a) The stream on which the rights are granted is Pine Creek.
- b) The point of diversion is located as shown on the attached plan wining Placer Tenure PC 568945.
- c) The date from which this licence shall have precedence is March 30, 2010.
- d) The purpose for which this licence is issued is mining (placer).
- e) The maximum quantity of water which may be diverted is 0.014 cubic metres per second (0.5 c.f.s.).
- f) The period of the year during which the water may be used is March 1 to November 30.
- g) The land upon which the water is to be used and to which this licence is appurtenant is Placer Tenure PC 568945.
- h) The authorized works are a diversion structure, screened intake, pump, pipe, wash plant, and settling ponds, which shall be located approximately as shown on the attached plan.
- i) The construction of the said works has been completed and the water is being used. The licensee shall continue to make regular beneficial use of the water in a manner authorized herein.
- j) The works authorized in clause (h) hereof shall be constructed and used in accordance with the approved "Notice of Work".
- k) All waste water generated from the washing of gravels must be directed through a settling pond system to remove suspended solids before being returned to the stream.
- l) All mined or otherwise disturbed ground surfaces including cut banks and fill slopes shall be stabilized to prevent tailings, forest cover, top soil and debris from entering into water courses.
- m) The riparian (vegetation) zone adjacent to Pine Creek shall be protected from all activities associated with placer mining. Placer operations within those aforementioned placer tenured properties shall be prohibited within 10 meters of the high water mark measured from both sides of the stream, including the bed and banks of the stream.
- n) The diversion of water authorized under this licence may be restricted or prohibited at any time by an Order, in writing, of the Engineer or Manager under the Water Act, in order to maintain a minimum flow in the stream for the preservation of fish life.

Province of British Columbia

Water Act

- o) This licence will be valid from the date of issue until November 30, 2012. Prior to the termination date, you may apply to the Comptroller of Water Rights or the Regional Water Manger in accordance with the provisions of the Water Act to amend this licence to extend its term which will allow Water Stewardship Division staff to review the conditions or the licence with respect to the proposed activities.



Robert M Piccini
Assistant Regional Water Manager

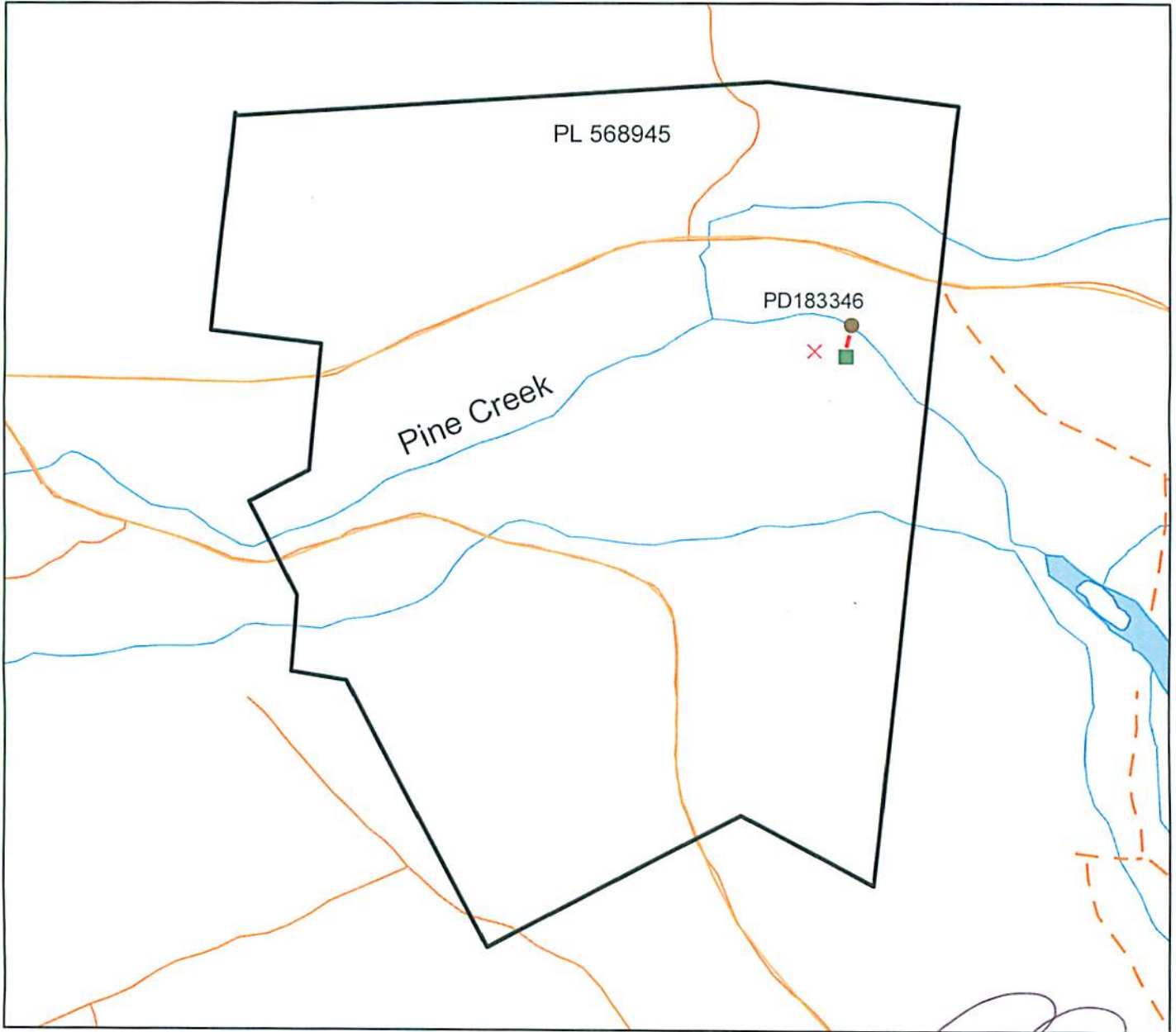

WATER DISTRICT: Atlin
 PRECINCT: N/A
 LAND DISTRICT: Cassiar



Signature: 

LEGEND:
 Scale: 1:6,000
 Point of Diversion: ●
 Map Number: 104N052
 Pipeline: - - - - -
 Wash Plant: ■
 Settling Ponds: X

Date: JUL 08 2010
 C.L.: C125682
 File: 6001313
 P.C.L.: N/A

The boundaries of the land to which this licence is appurtenant are shown thus: 