



Province of British Columbia

Water Act

CONDITIONAL WATER LICENCE

The holder of Placer Tenure 367264 to which this licence is appurtenant is hereby authorized to divert and use water as follows:

- a) The stream on which the rights are granted is Birch Creek.
- b) The point of diversion is located as shown on the attached plan.
- c) The date from which this licence shall have precedence is March 19, 2010.
- d) The purpose for which this licence is issued is Mining (placer).
- e) The maximum quantity of water which may be diverted for Mining (placer) is 0.014 cubic metres per second (0.5 cubic feet per second).
- f) The period of the year during which the water may be used is March 1 to November 30.
- g) The land upon which the water is to be used and to which this licence is appurtenant is Tenure LPM 367264 Atlin Mining Division.
- h) The authorized works are a screened intake, pipe, pump, wash plant and settling ponds which are located approximately as shown on the attached plan.
- i) The construction of the said works has been completed and the water is being used. The licensee shall continue to make regular beneficial use of the water in a manner authorized herein.
- j) The works authorized under clause (h) hereof shall be constructed and used in accordance with the approved "Notice of Work".
- k) All waste water generated from washing of gravels must be directed through a settling pond system to remove suspended solids before returning to the stream.



Ministry of
Environment

Province of British Columbia

Water Act

- l) All mined or otherwise disturbed ground surfaces including cut banks, and fill slopes shall be stabilized to prevent tailings, forest cover, top soil and debris from entering water courses.

- m) The diversion of water authorized under this licence may be restricted or prohibited at any time by an order in writing of an Engineer under the Water Act, in order to maintain minimum flow in the stream for preservation of fish life.

- n) This licence terminates on November 30, 2012. Prior to the termination date, the licensee may apply to the Comptroller of Water Rights or the Regional Water Manager in accordance with the provisions of the Water Act to amend this licence to extend its term.



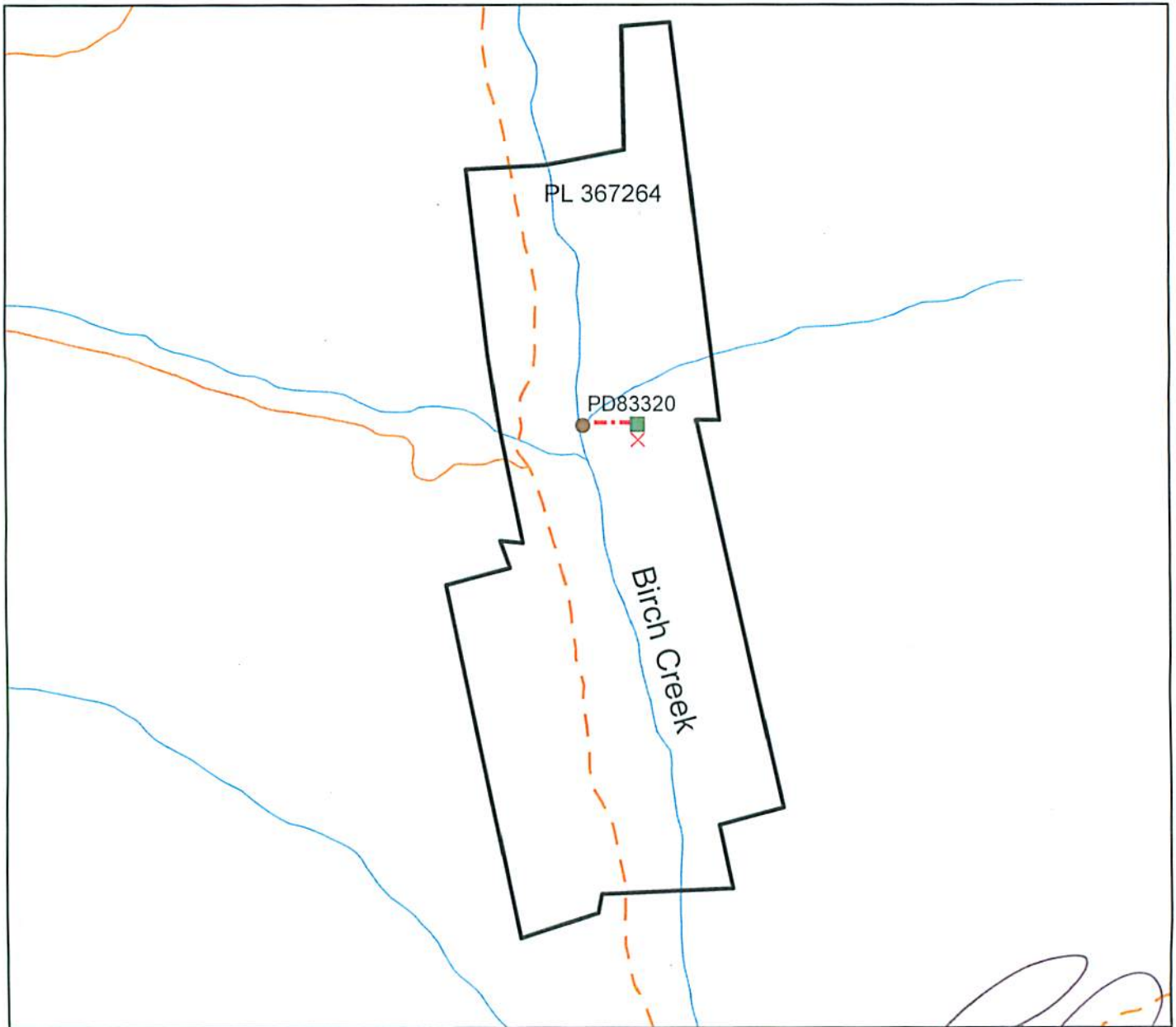

Robert M Piccini
Assistant Regional Water Manager



WATER DISTRICT: Atlin
 PRECINCT: N/A
 LAND DISTRICT: Cassiar



Signature: 

LEGEND:
 Scale: 1:14,000
 Point of Diversion: 
 Map Number: 104N063
 Pipeline: 
 Wash Plant: 
 Settling Ponds: 

Date: JUL 26 2010
 C.L. C125712
 File: 6001210
 P.C.L.: N/A

The boundaries of the land to which this licence is appurtenant are shown thus: 