

Province of British Columbia

Water Act

CONDITIONAL WATER LICENCE

The owner of the land to which this licence is appurtenant is hereby authorized to divert/use water as follows:

- a) The stream on which the rights are granted is Chaliapin Creek.
- b) The point of diversion is located as shown on the attached plan.
- c) The date from which this licence shall have precedence is December 07, 2009.
- d) The purpose for which this licence is issued is Power (residential).
- e) The maximum quantity of water which may be diverted and used under this licence is 0.000789 cubic meters (.02876 cubic feet) per second, subject to maintaining minimum flows of 0.00284 cubic meters per second, measured immediately downstream of the diversion point.
- f) The period during which the water may be used is November 1 to April 30.
- g) The land upon which water is to be used and in which a powerhouse is situated, is described as that parcel or tract of land within Block A (Reference Plan 4268), District Lot 4326, Group 1, New Westminster District (PID: 015-857-093).
- h) The works authorized are diversion, intake structure, pipe, powerhouse and tailrace, which shall be located approximately as shown on the attached plan.
- i) The construction of the diversion and intake structure has been completed. The construction of the pipe, powerhouse and tailrace, shall be completed and the water beneficially used prior to December 31, 2013. Thereafter, the licensee shall continue to make regular beneficial use of water in the manner authorized herein.
- j) The diversion of water authorized under this licence may be regulated at any time by an order of an Engineer under the Water Act, in order to maintain flow in the stream for the preservation of aquatic life. Regulation includes allowing, commencing, stopping, limiting, opening, shutting and prohibiting the diversion of water.
- k) The diversion structure must be screened in accordance with Fisheries and Oceans Guidelines. Please refer to the Fisheries and Oceans Canada website for further information at: www.dfo-mpo.gc.ca/.
- l) The in-stream works i.e., diversion and intake structure, constructed in accordance with the Ministry of Environment's "Standards and Best Practices for In-stream Works" and the appropriate Fisheries and Oceans Canada guidelines.
- m) This licence is issued for a term of forty (40) years from the date of issuance of this licence.



Timothy Bennett, P.Eng.
Assistant Regional Water Manager

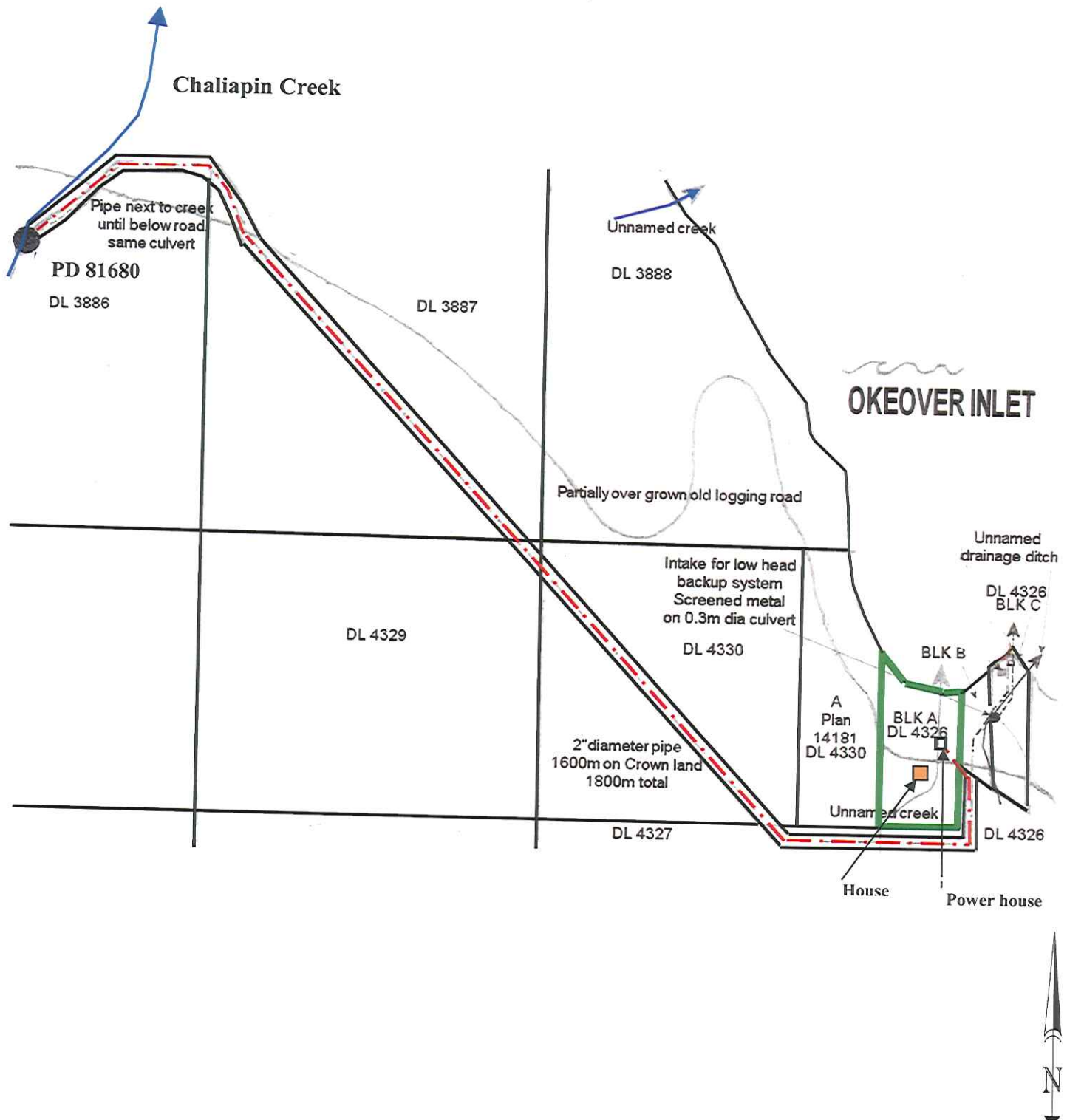

Scale: 1 to 7500

WATER DISTRICT: Vancouver
 PRECINCT: 29D - Jervis
 LAND DISTRICT: New Westminster
 MAP NUMBER: 92.F.097.4.1
 PD NUMBER: 81680

Signature: TTB

Date: July 22, 2010

LEGEND

Point of Diversion: ●
 Pipe: - - - - -
 Dwelling: ■
 Source: ~~~~~
 PCL: = = = = =

C.L.: 125715

File: 2003183

The boundaries of the land to which this license is appurtenant are shown thus: —————