

## WATER LICENCE DISPOSITION RECORD

File #: 1002887 Water Licence #: C126430

Stream Name: Seedtree Creek

Date of Disposition: Jul 21, 2014

☐ Abandoned

☐ Cancelled

☐ Refused

☒ Superseded by Licence #/s: C131601  
\_\_\_\_\_  
\_\_\_\_\_  
\_\_\_\_\_  
\_\_\_\_\_

Close File? ☐ Yes ☒ No

Noted by: JR Date: Dec 5, 2014  
(Financial Services Branch Representative)



# Province of British Columbia

## *Water Act*

### CONDITIONAL WATER LICENCE

The owner(s) of the land to which this licence is appurtenant is/are hereby authorized to divert, use and store water as follows:

- a) The stream on which the rights are granted is Seedtree Creek and storage is in a dugout reservoir.
- b) The point of diversion is located approximately as shown on the attached plan.
- c) The date from which this licence shall have precedence is October 25, 2010.
- d) The purposes for which this licence is issued are Storage and Fire Protection.
- e) The maximum quantity of water which may be diverted to fill the reservoir is 27.2765 cubic metres per year which may be used for fire protection subject to the water being available from storage.
- f) The period of the year during which water may be diverted into storage is November 1 to April 30, and the stored water may be used for Fire Protection during the whole year.
- g) The land upon which the water is to be used and to which this licence is appurtenant is Section 85, Sooke District, except parcel A (DD 76267I) and except part in plan VIP86564.
- h) The authorized works are dugout, pipe, and sump which shall be located approximately as shown on the attached plan.
- i) The construction of the said works shall be completed and the water shall be beneficially used prior to December 31, 2014. Thereafter, the licensee shall continue to make regular beneficial use of the water in the manner authorized herein.

Paul Marquis  
Assistant Regional Water Manager

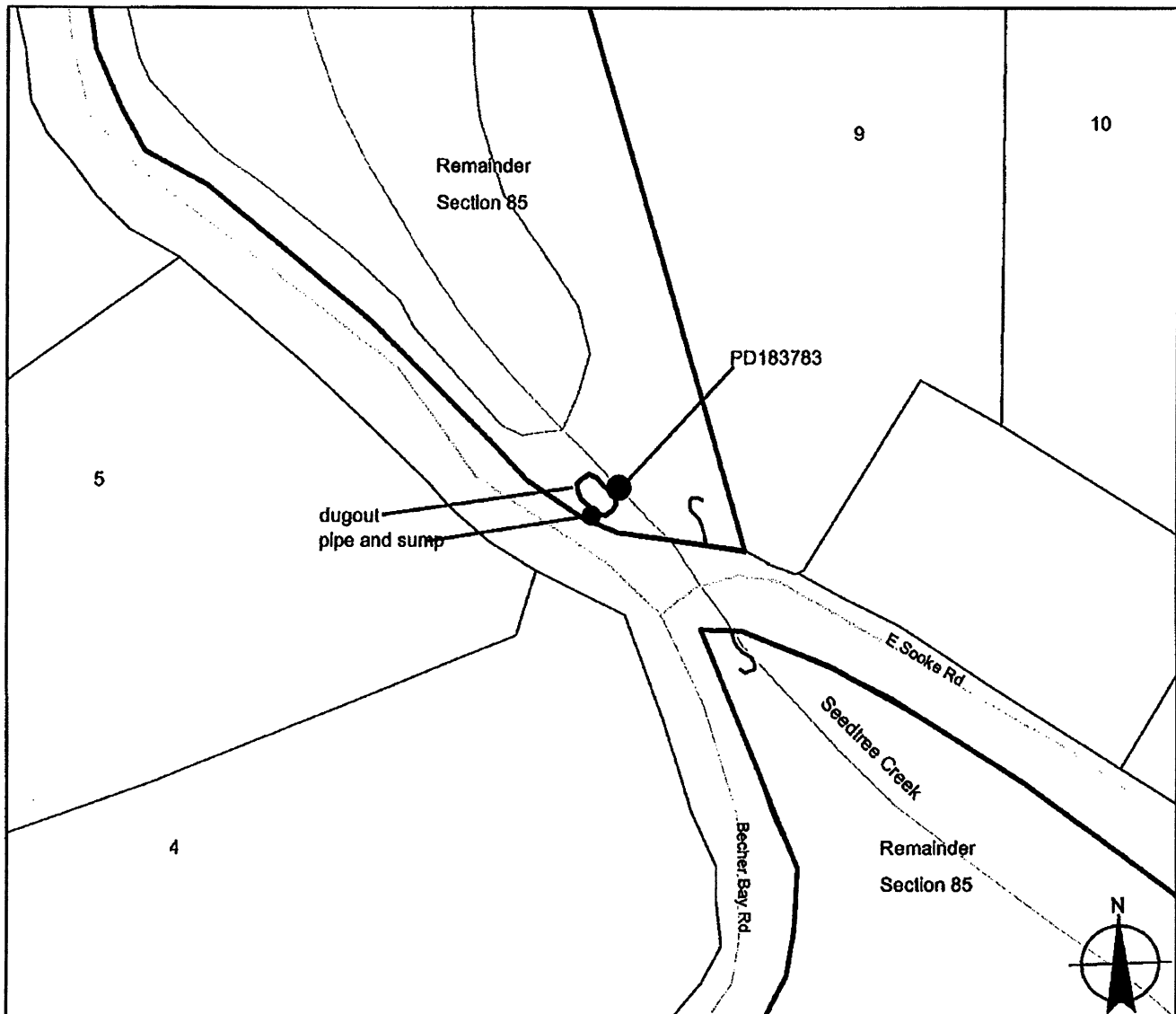

**WATER DISTRICT:** Victoria  
**PRECINCT:** Victoria  
**LAND DISTRICT:** Sooke

**Signature:**   
**Date:** MAY 27 2011

**LEGEND:**  
 Scale: 1:1,819  
 Point of Diversion:   
 Map Number: 92B.032.2.4  
 Pipe: - - - - -

C.L. C126430  
 File 1002887