

Province of British Columbia

Water Act

CONDITIONAL WATER LICENCE

The owner of the land to which this licence is appurtenant is hereby authorized to divert and use water as follows:

- a) The stream on which the rights are granted is Chou Creek.
- b) The point of diversion is located as shown on the attached plan.
- c) The date from which this licence shall have precedence is October 1st, 1976.
- d) The purpose for which this licence is issued is domestic.
- e) The maximum quantity of water which may be diverted is 2.273 cubic metres per day.
- f) The period of the year during which the water may be used is the whole year.
- g) The land upon which the water is to be used and to which this licence is appurtenant is Lot A, District Lot 8254, Kootenay District, Plan NEP88098.
- h) The authorized works are diversion structure, tanks, and pipe which shall be located approximately as shown on the attached plan.
- i) The construction of the said works shall be completed and the water shall be beneficially used prior to Decemeber 31, 2014. Thereafter, the licensee shall continue to make regular beneficial use of the water in the manner authorized herein.
- j) This licence is issued pursuant to the provisions of the Water Act to ensure compliance with that statute, which makes it an offence to divert or use water from a stream in British Columbia without proper authorization. It is the responsibility of the licensee to ensure that all activities conducted under this authorization are carried out with regard to the rights of third parties, and comply with other applicable legislation that may be in force.
- k) This licence authorizes the use of water for domestic purpose in one dwelling and one shop located approximately as shown on the attached plan.
- l) This Licence is issued in substitution of Conditional Water Licence 61271 in part.

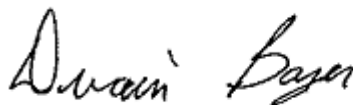

D. Boyer P.Eng.
Assistant Regional Water Manager,

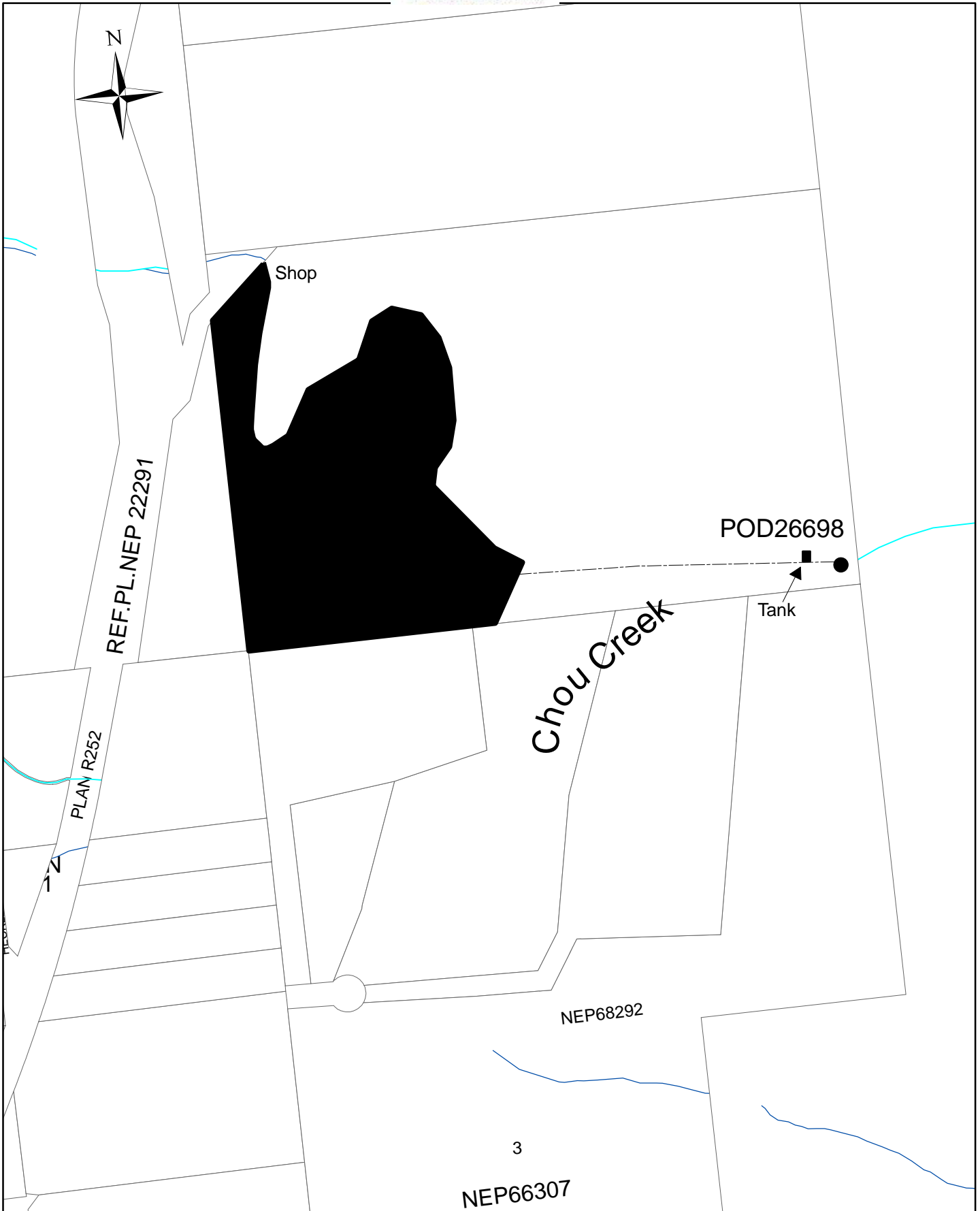

WATER DISTRICT: NELSON
 PRECINCT: LITTLE SLOCAN
 LAND DISTRICT: KOOTENAY
 LEGEND:
 Scale: 1:5,000
 Point of Diversion: ●
 Map Number: 82.F.063.4.3
 Pipe: -----



Signature:

Date: July 27, 2011

C.L.: 126561 for C.L. 61271 in part

FILE: 4006043

The boundaries of the land to which this licence is appurtenant are shown thus: 

WATER LICENCE DISPOSITION RECORD

File #: 4006043 Water Licence #: C126561

Stream Name: Chou Creek

Date of Disposition: Jan 27, 2015

Abandoned

Cancelled

Refused

Superseded by Licence #/s: C131727 _____

Close File? Yes No

Noted by: JR Date: Feb 3, 2015
(Financial Services Branch Representative)