



Province of British Columbia

Water Act

CONDITIONAL WATER LICENCE

The owners of the land to which this licence is appurtenant are hereby authorized to divert and use water as follows:

- a) The stream on which the rights are granted is Sandy Creek.
- b) The point of diversion is located as shown on the attached plan.
- c) The date from which this licence shall have precedence is September 20, 1930.
- d) The purposes for which this licence is issued are irrigation and domestic.
- e) The maximum quantity of water which may be diverted for irrigation purpose is 1927 cubic metres per year and for domestic purpose is 2.273 cubic metres per day.
- f) The period of the year during which the water may be used for irrigation purpose is April 1 to September 30 and for domestic purpose is the whole year.
- g) The land upon which the water is to be used and to which this licence is appurtenant is Lot A, District Lot 2548, Kootenay District, Plan NEP90034 of which 0.506 hectares may be irrigated.
- h) The authorized works are diversion structure, ditch, tank, pipe and sprinkler system which shall be located approximately as shown on the attached plan.
- i) The construction of the said works has been completed and the water is being used. The licensee shall continue to make regular beneficial use of the water in a manner authorized herein.
- j) This licence is issued pursuant to the provisions of the Water Act to ensure compliance with that statute, which makes it an offence to divert or use water from a stream in British Columbia without proper authorization. It is the responsibility of the licensee to ensure that all activities conducted under this authorization are carried out with regard to the rights of third parties, and comply with other applicable legislation that may be in force.
- k) This licence authorizes the use of water for domestic purpose in one dwelling located approximately as shown on the attached plan.
- l) This Licence is issued in substitution of Conditional Water Licence 112766, in part.

John R. Bochard
Assistant Regional Water Manager

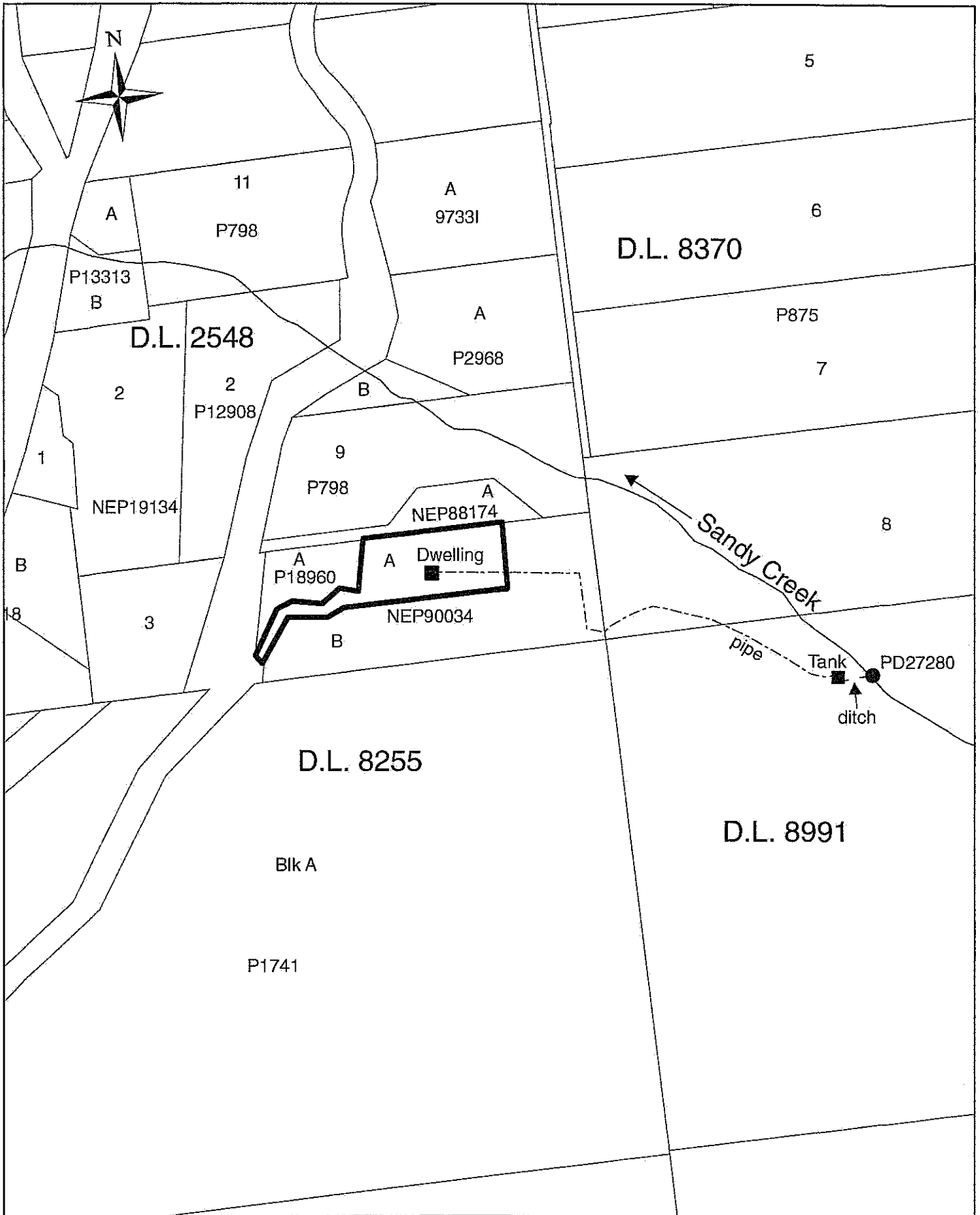

WATER DISTRICT: NELSON
 PRECINCT: NELSON
 LAND DISTRICT: KOOTENAY
 LEGEND:
 Scale: 1:4,000
 Point of Diversion: ●
 Map Number: 82.F.044.3.3.2
 Pipe: -----

Signature:

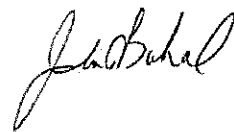

Date: January 20, 2012

C.L. 127064 for C.L. 112766, in part

File: 4006086