



Province of British Columbia

Water Act

CONDITIONAL WATER LICENCE

The owner(s) of the land to which this licence is appurtenant are hereby authorized to divert and use water as follows:

- a) The source on which the rights are granted is Gun Lake.
- b) The points of diversion are located as shown on the attached plan.
- c) The date from which this licence shall have precedence is June 17, 2013.
- d) The purpose for which this licence is issued is domestic.
- e) The maximum quantity of water which may be diverted is 4.5461 cubic meters (1000 gallons) per day.
- f) The period of the year during which the water may be used is the whole year.
- g) The land upon which the water is to be used and to which this licence is appurtenant is Lot A District Lot 4823 Lillooet District Plan KAP58098.
- h) The authorized works are two screened intakes, two submersible pumps, and two pipelines which shall be located approximately as shown on the attached plan.
- i) The construction of the said works shall be completed and the water shall be beneficially used prior to December 31, 2016. Thereafter, the licensee shall continue to make regular beneficial use of the water in the manner authorized herein.
- j) This licence is issued under the *Water Act* (the Act). The exercise of rights under the licence is subject to the Act and its regulations, the terms and conditions of the licence, orders under the Act and the rights of licensees whose rights have precedence on the stream. The licensee must comply with all such requirements, as well as the provisions of all other applicable enactments. In exercising rights under the licence, the licensee must exercise reasonable care to avoid damaging land, works, trees or other property, and must make full compensation to the owners for damage or loss resulting from construction, maintenance, use, operation or failure of the works.
- k) The diversion of water authorized under this licence may be restricted or prohibited at any

time by an Order in writing of an Engineer under the *Water Act*, in order to maintain a minimum level in the source.

- l) This licence authorizes the use of water for domestic purpose in two dwellings located approximately as shown on the attached plan.

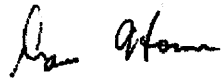
A handwritten signature in black ink, appearing to read "Dave Horne". The signature is written in a cursive, flowing style.

Dave Horne
Assistant Regional Water Manager

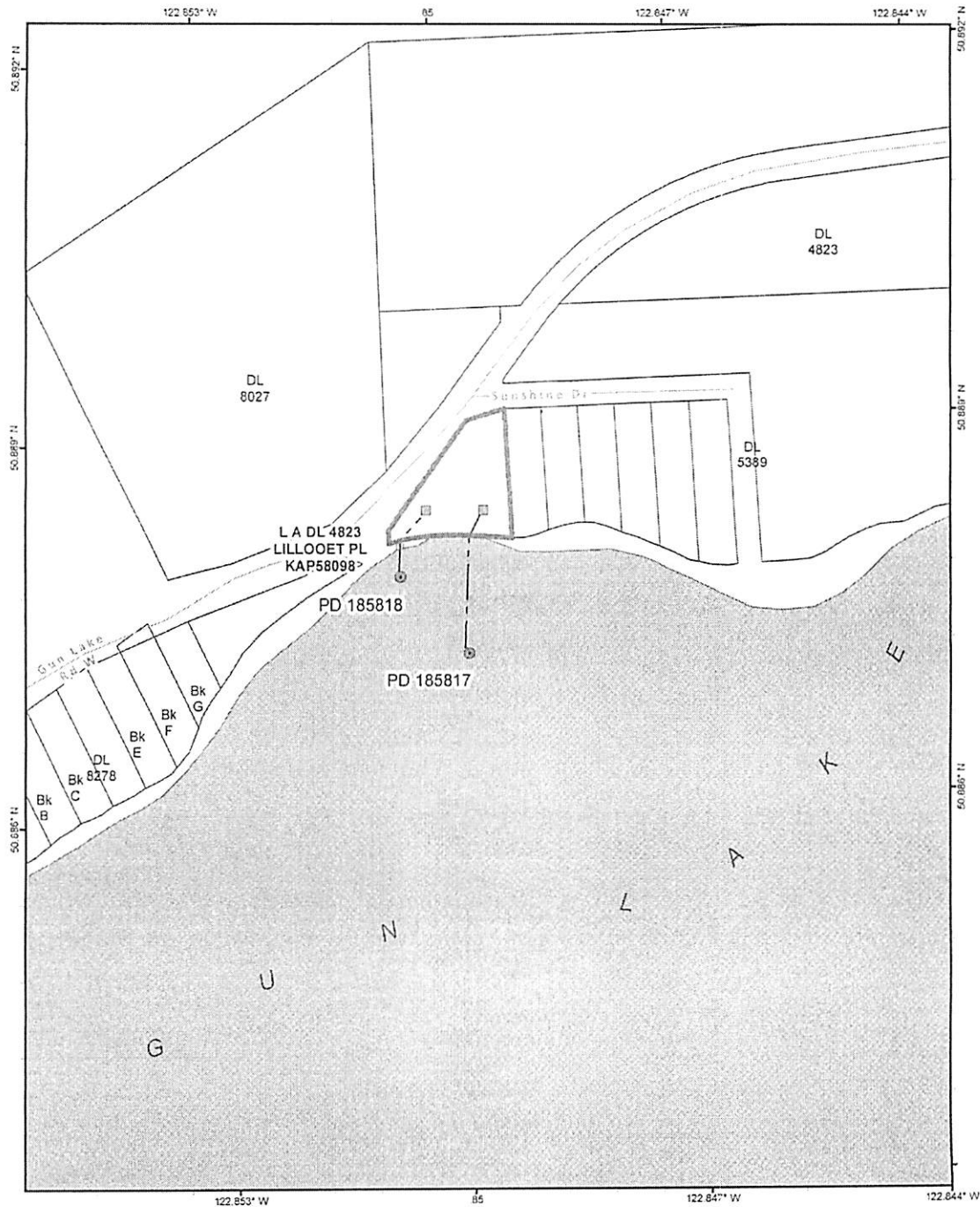

Scale: 1:4,000



Point of Diversion:

Pipeline:

Dwelling:

Permit Over Crown Land:

The boundaries of the land to which this licence is appurtenant are shown thus:

Mapsheet: 92.J.086.4.3

Land District: LILLOOET DISTRICT

Water District: Ashcroft

Precinct: Bridge River

Signature:

Date: November 19, 2013



Licence: C130848

File: 3005341

PCL#: 27725