



Province of British Columbia

Water Act

CONDITIONAL WATER LICENCE

The owner(s) of the land to which this licence is appurtenant is/are hereby authorized to divert and use water as follows:

- a) The stream on which the rights are granted is Siwash Creek.
- b) The point of diversion is located as shown on the attached plan.
- c) The date from which this licence shall have precedence is August 24, 1981.
- d) The purpose for which this licence is issued is domestic.
- e) The maximum quantity of water which may be diverted for domestic purposes is 2.27305 cubic metres (500 gallons) per day.
- f) The period of the year during which the water may be used is the whole year.
- g) The land upon which the water is to be used and to which this licence is appurtenant is That Part of Fractional West ½ of Legal Subdivision 1 Section 24 Township 13 Range 27 West of the 6th Meridian Kamloops Division Yale District, As Shown on the Plan of the Northeast 1/4 of Said Township Dated at Ottawa, 5th of October 1915; Lying South and West of the Southwesterly Boundary and the Southeasterly Boundary and the Northeasterly Production of the said Southeasterly Boundary of District Lot 6, Group 1, Lytton Division Yale District; and Except Part Covered by the Right-of-Way of the Canadian Pacific Railway as Shown on Plan A526 and Except Plan KAP85399.
- h) The authorized works are a screened intake, ditch, pipe, flow measuring device and sprinklers which shall be located approximately as shown on the attached plan.
- i) The construction of the said works shall be completed and the water shall be beneficially used prior to December 31, 2016. Thereafter, the licensee shall continue to make regular beneficial use of the water in the manner authorized herein.
- j) This licence is issued under the *Water Act* (the Act). The exercise of rights under the licence is subject to the Act and its regulations, the terms and conditions of the licence, orders under the Act and the rights of licensees whose rights have precedence on the stream. The licensee must comply with all such requirements, as well as the provisions of

all other applicable enactments. In exercising rights under the licence, the licensee must exercise reasonable care to avoid damaging land, works, trees or other property, and must make full compensation to the owners for damage or loss resulting from construction, maintenance, use, operation or failure of the works.

- k) This licence authorizes the use of water for domestic purpose in one dwelling located approximately as shown on the attached plan.
- l) The licensee shall install a flow measuring device to the satisfaction of an Engineer under the *Water Act*.
- m) The licensee shall retain flow meter records for inspection upon request by an Engineer under the *Water Act*.
- n) This Licence is issued in substitution of Conditional Water Licence C059310, in part.



Peter Stroes R.P.F.
Assistant Regional Water Manager

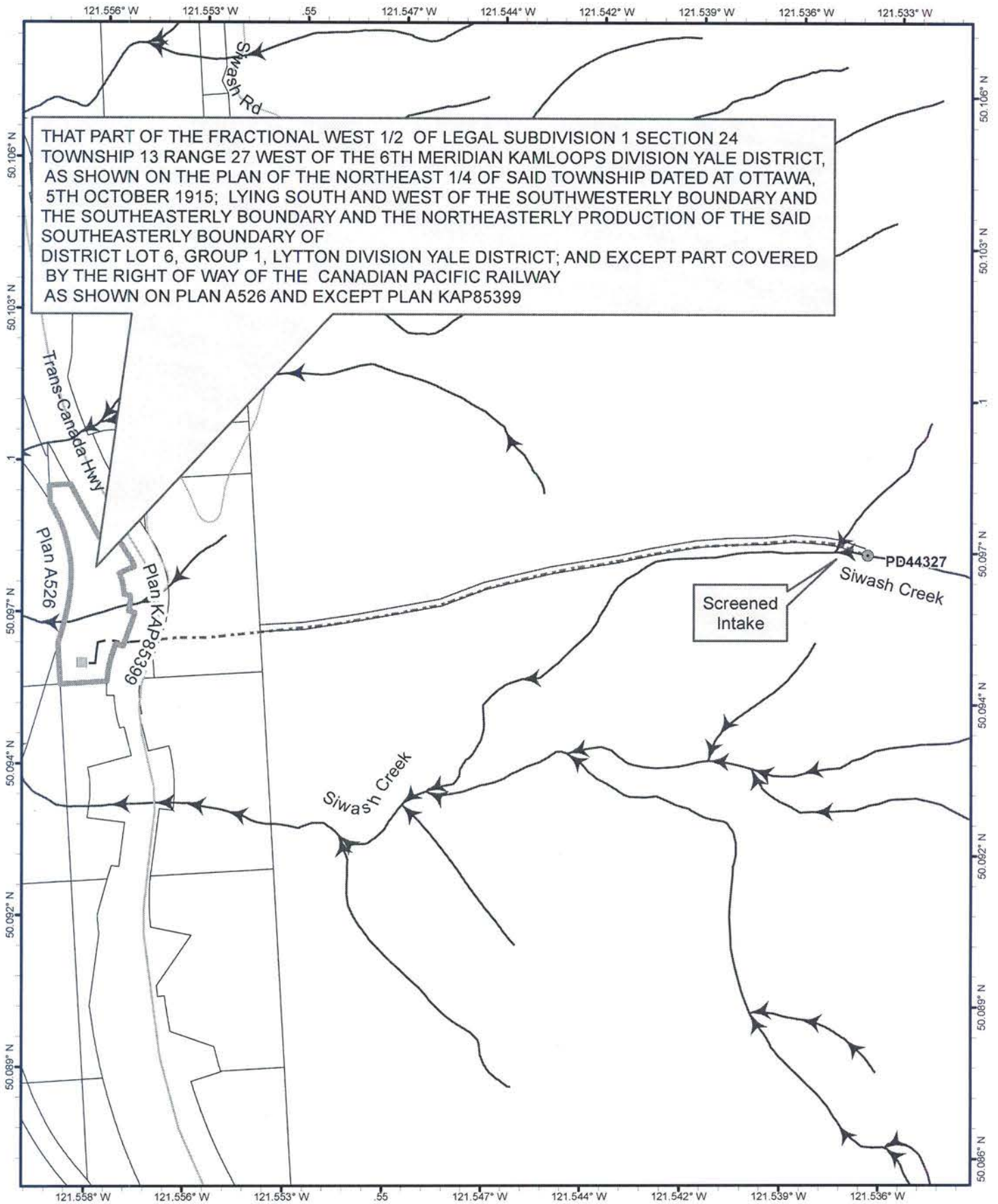

Scale: 1:10,000



Point of Diversion: ●
 Works points: ■ Dwelling
 Ditch: - - - - -
 Pipeline: - · - · - ·

Direction of Flow: →

Permit Over Crown Land: = = = = =

The boundaries of the land to which this licence is appurtenant are shown thus: ————

Mapsheet : 0921003

Land District : KDYD

Water District: Ashcroft

Precinct: Lytton

Signature: *[Signature]*

Date: *March 18, 2015*



Licence: C130939 for C059310 in part
 File: 0369064
 PCL#: 28083