



Province of British Columbia

Water Act

CONDITIONAL WATER LICENCE

The owner(s) of the land to which this licence is appurtenant is/are hereby authorized to divert and use water as follows:

- a) The stream on which the rights are granted is Texas Creek.
- b) The point of diversion is located as shown on the attached plan.
- c) The date from which this licence shall have precedence is November 5, 2013.
- d) The purpose for which this licence is issued is irrigation.
- e) The maximum quantity of water which may be diverted is 99,912.02904 cubic metres (81 acre feet) per year.
- f) The period of the year during which the water may be used is April 1 to September 30.
- g) The land upon which the water is to be used and to which this licence is appurtenant is District Lot 4707 Lillooet District Except Plans 31916 and KAP56985 and District Lot 2977A Lillooet District Except Plan KAP56985 of which 10.92651 hectares (27 acres) may be irrigated.
- h) The authorized works are screened intake, pond, pumphouse, flow measuring device, pipe, and irrigation system which shall be located approximately as shown on the attached plan.
- i) The construction of the said works shall be completed and the water shall be beneficially used prior to December 31, 2017. Thereafter, the licensee shall continue to make regular beneficial use of the water in the manner authorized herein.
- j) This licence is issued under the *Water Act* (the Act). The exercise of rights under the licence is subject to the Act and its regulations, the terms and conditions of the licence, orders under the Act and the rights of licensees whose rights have precedence on the stream. The licensee must comply with all such requirements, as well as the provisions of all other applicable enactments. In exercising rights under the licence, the licensee must exercise reasonable care to avoid damaging land, works, trees or other property, and must make full compensation to the owners for damage or loss resulting from construction, maintenance, use, operation or failure of the works.

- k) The diversion of water authorized under this licence may be restricted or prohibited at any time by an Order in writing of an Engineer under the *Water Act*, in order to maintain a minimum flow in the stream for the preservation of fish and other aquatic life.
- l) The licensee shall install a flow measuring device to the satisfaction of an Engineer under the *Water Act*.
- m) The licensee shall retain flow meter records for inspection upon request by an Engineer under the *Water Act*.

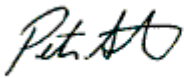

Peter Stroes R.P.F.
Assistant Regional Water Manager

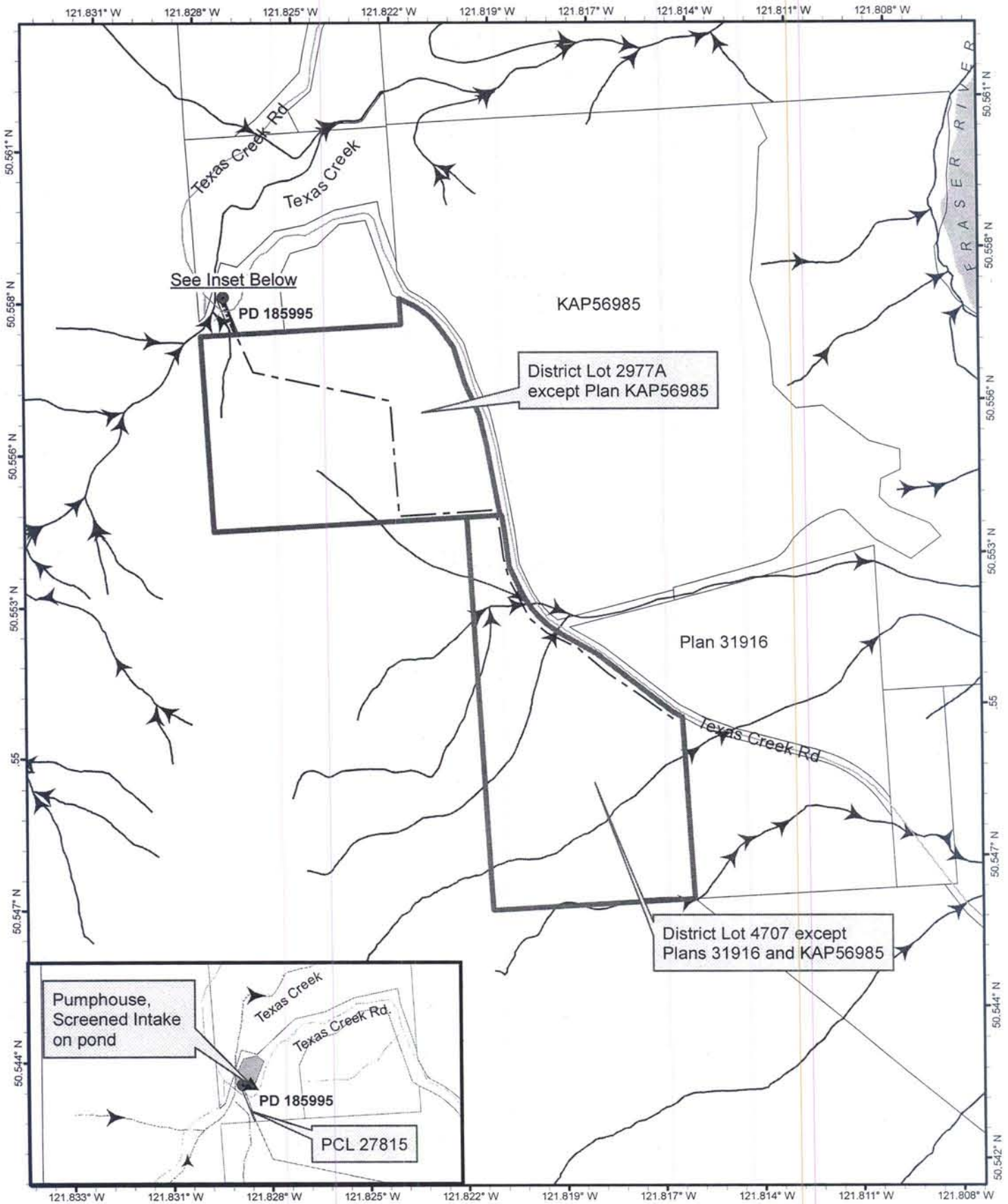

Scale: 1:10,000

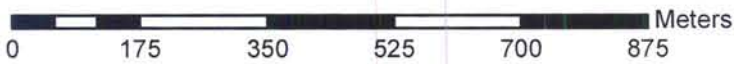

Point of Diversion: ●
Works point ▲ Pumphouse, Screened intake and Pond

Pipeline: — — — — —

Direction of Flow: →

Permit Over Crown Land: — — — — —

The boundaries of the land to which this licence is appurtenant are shown thus: — — — — —

Mapsheet : 092 I.051

Land District : LILLOOET DISTRICT

Water District: Ashcroft

Precinct: Bridge River

Signature: *[Signature]*

Date: November 19, 2014



Licence: C131151

File: 3005394

PCL#: 27815