

**WATER LICENCE DISPOSITION RECORD**

File #: 6001205 Water Licence #: C131223

Stream Name: Otter Creek

Date of Disposition: Dec 1, 2014

Recorded as Abandoned

Recorded as Cancelled

Superseded by Licence #/s: C131833  
\_\_\_\_\_  
\_\_\_\_\_  
\_\_\_\_\_

Close File?  Yes  No

Noted by: EB Date: Dec 15, 2014  
*(Financial Services Branch Representative)*



# Province of British Columbia

## *Water Act*

### CONDITIONAL WATER LICENCE

The holder(s) of Placer Lease 636503 to which this licence is appurtenant is/are hereby authorized to divert and use water as follows:

- a) The stream on which the rights are granted is Otter Creek.
- b) The point of diversion is located as shown on the attached plan.
- c) The date from which this licence shall have precedence is February 12, 2010.
- d) The purpose for which this licence is issued is placer mining and dewatering.
- e) The maximum quantity of water which may be diverted for placer mining purposes is 0.057 cubic metres per second (2.0 c.f.s.).
- f) The period of the year during which the water may be used for placer mining is May 1 to November 30. The period of the year during which water may be used for dewatering purposes is the whole year.
- g) The land upon which the water is to be used and to which this licence is appurtenant is Placer Tenure #636503, Atlin Mining Division.
- h) The authorized works are diversion channel, diversion structure, screened intake, pump, pipe, wash plant and settling ponds which shall be located approximately as shown on the attached plan.
- i) The construction of the said works has been completed and the water is being used. The licensee shall continue to make regular beneficial use of the water in a manner authorized herein.
- j) The works authorized under clause (h) hereof shall be constructed and used in accordance with the approved Notice of Work. Any changes to the authorized works must be approved prior to their completion.
- k) All waste water generated from the washing of gravels must be directed through a settling pond system to remove suspended solids before being returned to the stream.

- l) All mined or otherwise disturbed ground surfaces including cut banks and fill slopes shall be stabilized to prevent tailings, forest cover, top soil and debris from entering into water courses.
- m) The riparian (vegetation) zone adjacent to sections of Otter Creek not authorized for dewatering shall be protected from all activities associated with placer mining. Placer operations are prohibited within 10 metres of the high water mark measured from both sides of the stream, including the bed and banks of the stream.
- n) This licence authorizes the dewatering of a 900 metre long section of Otter Creek for the purpose of placer mining as indicated on the attached plan. Subsequent diversions must be approved through the amendment of this licence prior to the commencement of construction activities. The Approval of subsequent diversions will be subject to compliance with the *Water Act* and the terms and conditions outlined by an operational Water Management Plan. This Management Plan shall address all current and future water use on the subject property and is to be approved by the Regional Water Manager by November 30th, 2014.
- o) The diversion of water authorized under this licence may be restricted or prohibited at any time by an order in writing of an Engineer under the *Water Act*, in order to maintain a minimum flow in the stream or to ensure compliance with the conditions of this licence.
- p) Water may only be used for placer mining purposes so long as mines Permit No. P-1-707 is in good standing. Prior to the termination date of said permit, you may apply to the Comptroller of Water Rights or the Regional Water Manager in accordance with the provisions of the *Water Act* to amend this licence to incorporate the terms and conditions of subsequent mines permits.
- q) This Licence is issued in substitution of Conditional Licence 130105.



Robert Love  
Regional Water Manager

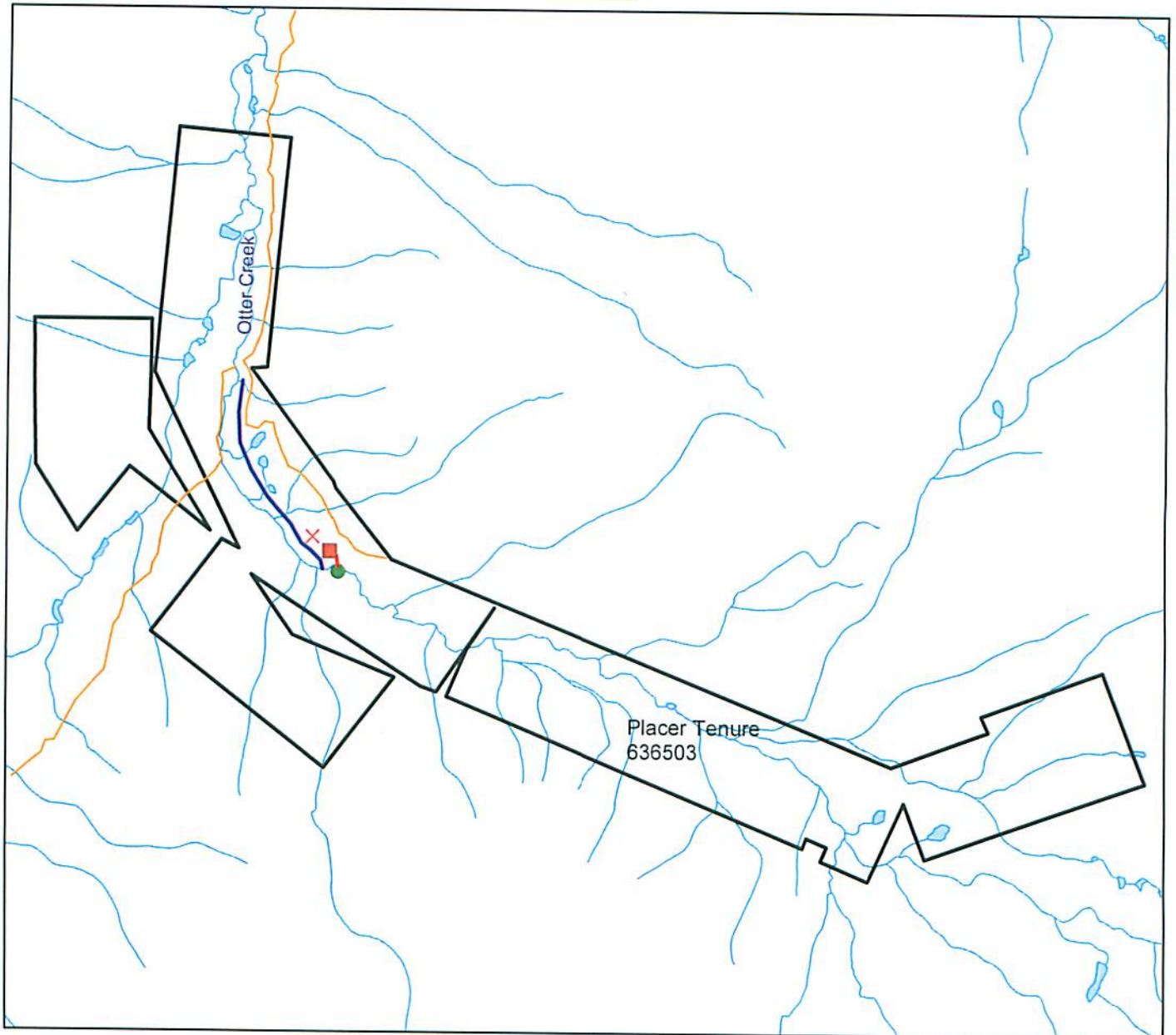

WATER DISTRICT: Atlin  
 PRECINCT: Atlin  
 LAND DISTRICT: Cassiar



Signature: *[Handwritten Signature]*  
 Date: FEB 26 2014

LEGEND:  
 Scale: 1:26,000  
 Point of Diversion: ● PD83257  
 Map Number: 104N054  
 Pipeline: - - - - -  
 Wash Plant: ■  
 Settling Ponds: X  
 Diversion Channel: ————  
 Roads: ————

C.L. C131223  
 File: 6001205  
 P.C.L.: N/A

The boundaries of the land to which this licence is appurtenant are shown thus: \_\_\_\_\_