



# Province of British Columbia

## *Water Act*

### CONDITIONAL WATER LICENCE

The owner(s) of the land to which this licence is appurtenant is/are hereby authorized to divert and use water as follows:

- a) The stream on which the rights are granted is Apple Creek.
- b) The point of diversion is located as shown on the attached plan.
- c) The date from which this licence shall have precedence is December 27, 2013.
- d) The purpose for which this licence is issued is placer mining.
- e) The maximum quantity of water which may be diverted for placer mining purposes is 0.0283 cubic metres per second (1.0 c.f.s).
- f) The period of the year during which the water may be used is May 1 to November 30.
- g) The land upon which the water is to be used and to which this licence is appurtenant is Placer Lease #567546, Atlin Mining Division.
- h) The authorized works are screened intake, pump, pipe, washplant and settling ponds which shall be located approximately as shown on the attached plan.
- i) The construction of the said works has been completed and the water is being used. The licensee shall continue to make regular beneficial use of the water in a manner authorized herein.
- j) The works authorized under clause (h) hereof shall be constructed and used in accordance with the approved Notice of Work. Any changes to the authorized works must be approved prior to their completion.
- k) All waste water generated from the washing of gravels must be directed through an approved settling pond system to remove suspended solids before being returned to the stream.
- l) All mined or otherwise disturbed ground surfaces including cut banks and fill slopes shall be stabilized to prevent tailings, forest cover, top soil and debris from entering into water

courses.

- m) The riparian (vegetation) zone adjacent to Apple Creek shall be protected from all activities associated with placer mining. Placer operations within those aforementioned placer tenured properties shall be prohibited within 10 metres of the high water mark measured from both sides of the stream, including the bed and banks of the stream.
- n) The diversion of water authorized under this licence may be restricted or prohibited at any time by an order in writing of an Engineer under the Water Act, in order to maintain a minimum flow in the stream or to ensure compliance with the conditions of this licence.
- o) Water may only be used for placer mining purposes so long as mines Permit No. P-1-751 is in good standing. Prior to the termination date of said permit, you may apply to the Comptroller of Water Rights or the Regional Water Manager in accordance with the provisions of the Water Act to amend this licence to incorporate the terms and conditions of subsequent mines permits.

A handwritten signature in black ink, appearing to read "Robert Love". The signature is written in a cursive, flowing style.

Robert Love  
Regional Water Manager

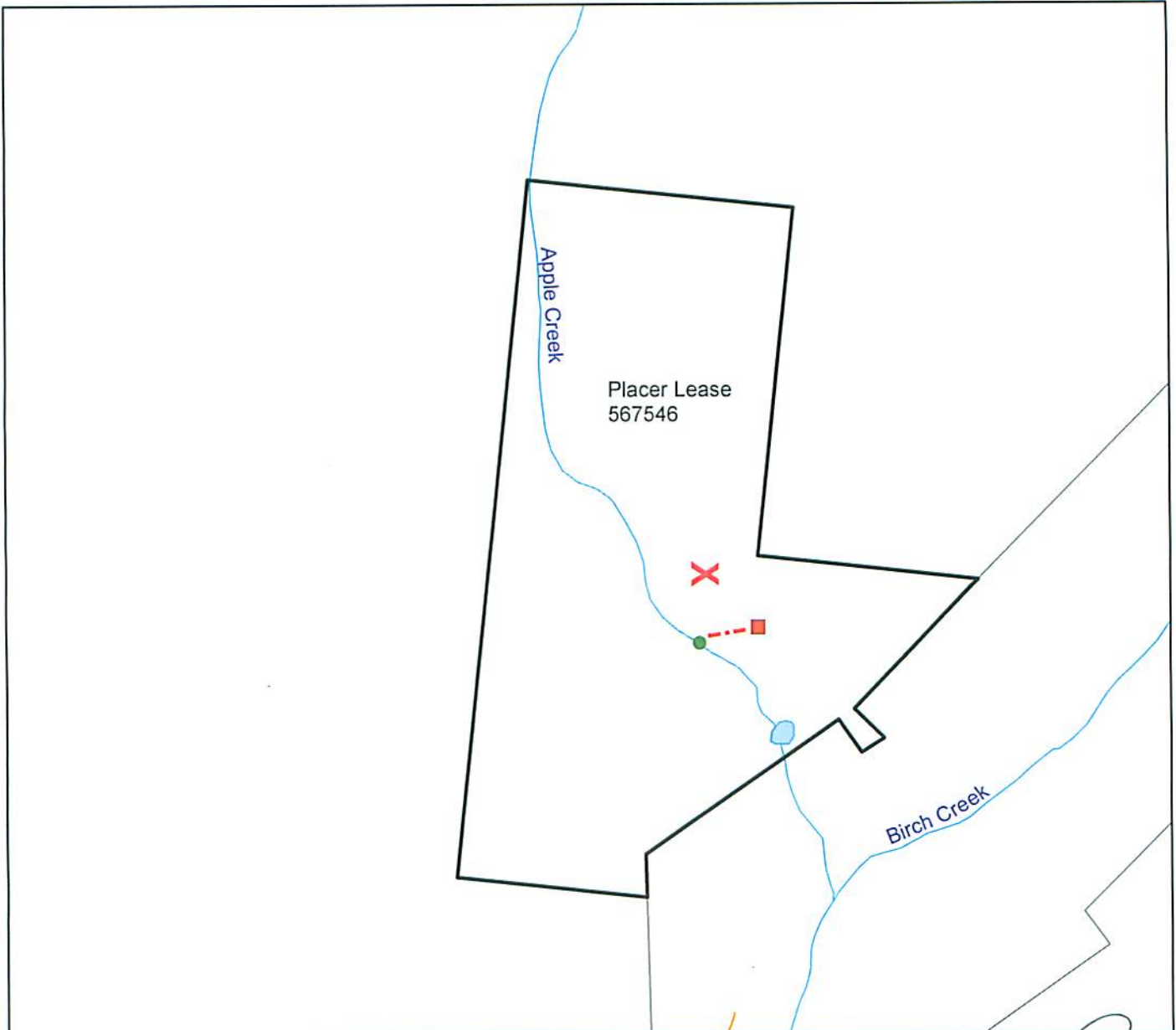

WATER DISTRICT:  
PRECINCT:  
LAND DISTRICT:

Atlin  
Atlin  
Cassiar



Signature: \_\_\_\_\_

Date: \_\_\_\_\_

MAR 12 2014

LEGEND:

Scale:

1:8,000

Point of Diversion:

● PD 186123

Map Number:

104N063

Pipeline



Wash Plant



Settling Ponds



C.L. C131382

File: 6001441

P.C.L.: N/A

The boundaries of the land to which this licence is appurtenant are shown thus: \_\_\_\_\_