



Province of British Columbia

Water Act

CONDITIONAL WATER LICENCE

The owner(s) of the land to which this licence is appurtenant are hereby authorized to divert and use water as follows:

- a) The stream on which the rights are granted is Fontanne Brook.
- b) The point of diversion is located as shown on the attached plan.
- c) The date from which this licence shall have precedence is May 29, 1979.
- d) The purpose for which this licence is issued is domestic.
- e) The maximum quantity of water which may be diverted is 2.273 (500 gallons) a day.
- f) The period of the year during which the water may be used is the whole year.
- g) The land upon which the water is to be used and to which this licence is appurtenant is Lot 2, District Lot 5415, Group 1, New Westminster District, Plan EPP34635.
- h) The authorized works are screened intake, pipe, pump and tank, which shall be located approximately as shown on the attached plan.
- i) The construction of the said works has been completed and the water is being used. The licensee shall continue to make regular beneficial use of the water in a manner authorized herein.
- j) This licence authorizes the use of water for domestic purpose in one dwelling, located approximately as shown on the attached plan.
- k) This licence is issued in substitution of part of Conditional Water Licence C114664.

Remko Rosenboom, M.Sc., A.Ag.
Assistant Regional Water Manager

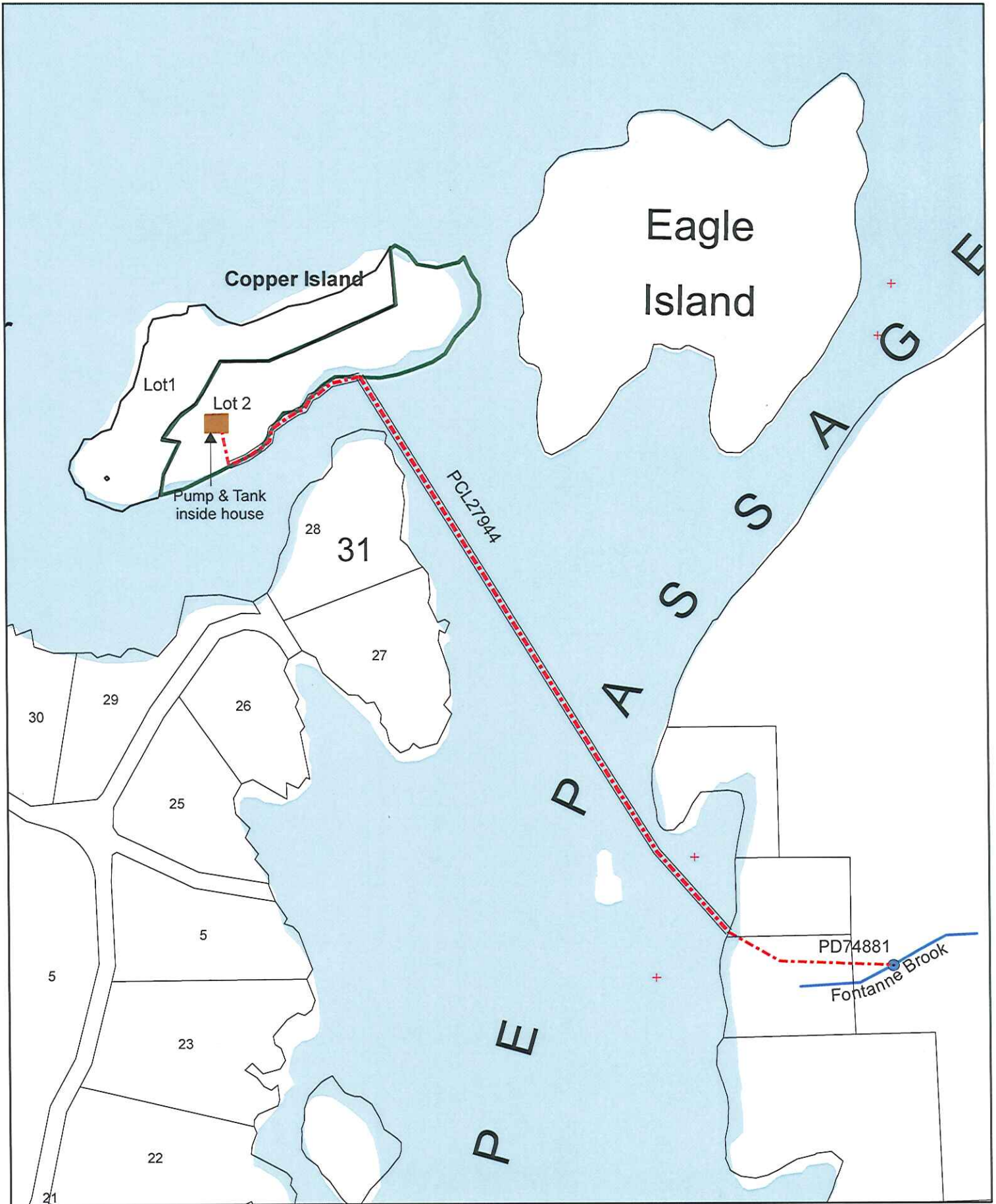





Map Number: 92F.080.1.4

Scale: 1:5,998



Water District:
Precinct:
Point of Diversion:
Structure/Dwelling:
Works:
Permit over Crown Land

Vancouver
Howe Sound



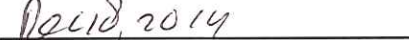

Signature: 

Date: 

The boundaries of the land to which this licence is appurtenant are shown thus: 

C.L. : C131522 in part for C114664
File: 2003643
PCL: 27944 for 23166