



Province of British Columbia

Water Act

CONDITIONAL WATER LICENCE

The owner(s) of the land to which this licence is appurtenant is/are hereby authorized to divert and use water as follows:

- a) The stream on which the rights are granted is Basely Creek.
- b) The point of diversion is located as shown on the attached plan.
- c) The date from which this licence shall have precedence is June 30, 1948.
- d) The purpose for which this licence is issued is irrigation.
- e) The maximum quantity of water which may be diverted for irrigation is 7400.89103 cubic metres (6 acre feet) per year.
- f) The period of the year during which the water may be used is April 1 to September 30.
- g) The land upon which the water is to be used and to which this licence is appurtenant is Lot B District Lot 404 Similkameen Division Yale District Plan KAP49285 except Plan KAP71798 of which 1.214 hectares (3 acres) may be irrigated.
- h) The authorized works are a flow measuring device, pump, pipe and sprinkler system which shall be located approximately as shown on the attached plan.
- i) The construction of the said works shall be completed and the water shall be beneficially used prior to December 31, 2016. Thereafter, the licensee shall continue to make regular beneficial use of the water in the manner authorized herein.
- j) This licence is issued under the *Water Act* (the Act). The exercise of rights under the licence is subject to the Act and its regulations, the terms and conditions of the licence, orders under the Act and the rights of licensees whose rights have precedence on the stream. The licensee must comply with all such requirements, as well as the provisions of all other applicable enactments. In exercising rights under the licence, the licensee must exercise reasonable care to avoid damaging land, works, trees or other property, and must make full compensation to the owners for damage or loss resulting from construction, maintenance, use, operation or failure of the works.

- k) The licensee shall install a flow measuring device to the satisfaction of an Engineer under the *Water Act*.
- l) The licensee shall retain flow meter records for inspection upon request by an Engineer under the *Water Act*.
- m) This Licence is issued in substitution of Conditional Water Licence C018709, in part.



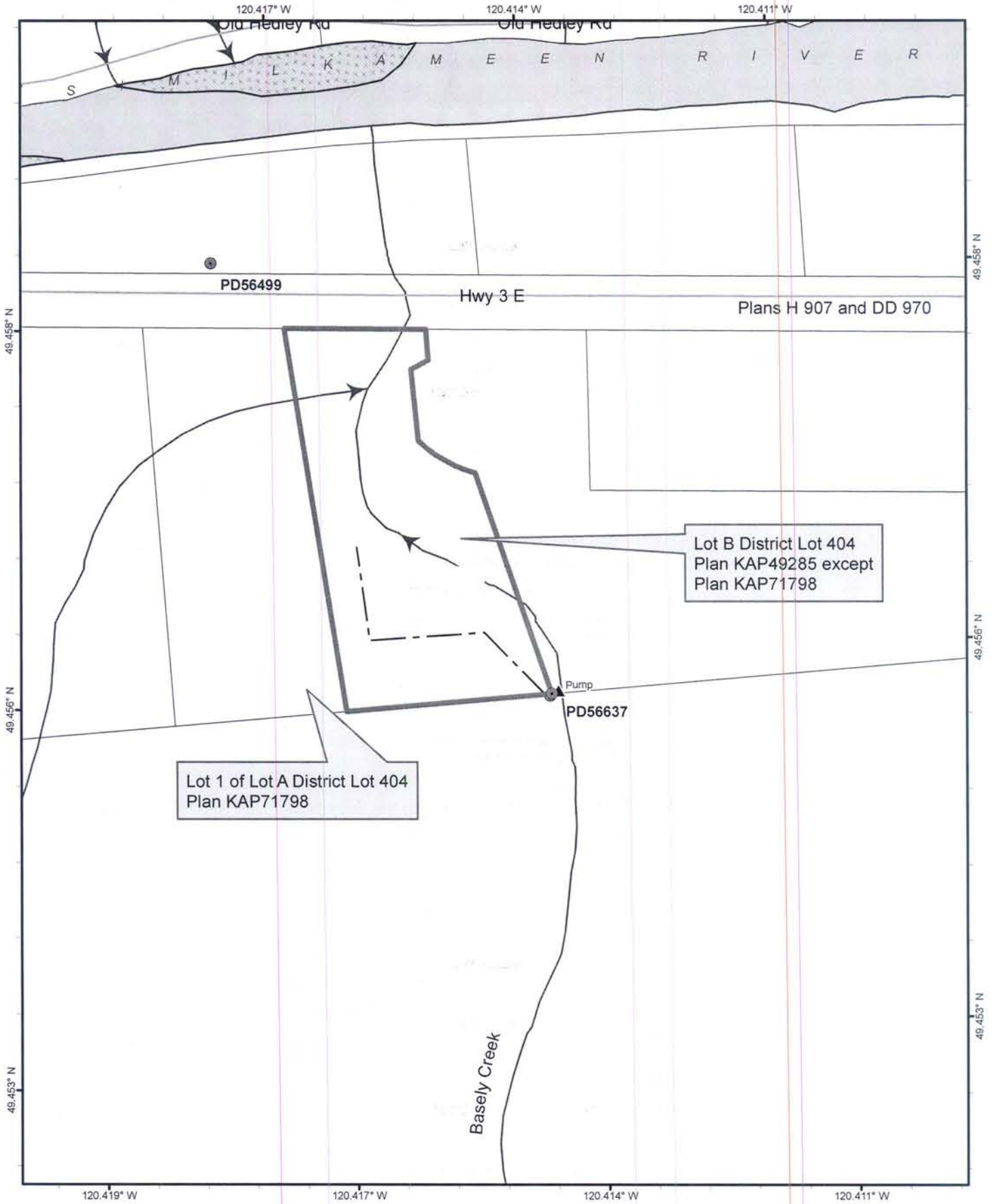

A handwritten signature in black ink, appearing to read "Peter Stroes".

Peter Stroes R.P.F.
Assistant Regional Water Manager
Cascades Forest District

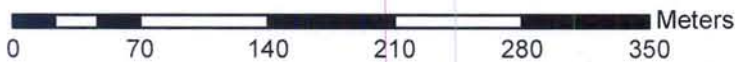

Scale: 1:4,000



- Point of Diversion: 
- Works points:  Pump
- Pipeline: 
- Direction of Flow: 

The boundaries of the land to which this licence is appurtenant are shown thus: 

Mapsheet : **092H048**

Land District : Similkameen Division Yale District

Water District: Princeton

Precinct: Princeton

Signature: 

Date: November 5, 2014

Licence: C131613 For C018709 in Part
File: 0174288
PCL#: N/A

