



Province of British Columbia

Water Act

CONDITIONAL WATER LICENCE

The owners of the land to which this licence is appurtenant are hereby authorized to divert and use water as follows:

- a) The stream on which the rights are granted is Leblanc Marsh and storage is in a dugout.
- b) The point of diversion is located as shown on the attached plan.
- c) The date from which this licence shall have precedence is June 09, 1995.
- d) The purpose for which this licence is issued is industrial (stock watering).
- e) The maximum quantity of water which may be diverted is 11.36 cubic meters per day.
- f) The period of the year during which the water may be used is the whole year.
- g) The land upon which the water is to be used and to which this licence is appurtenant is Parcel A District Lots 8276 and 8277 Cariboo District Plan PGP42110.
- h) The authorized works are diversion structure, ditch and dugout which shall be located approximately as shown on the attached plan.
- i) The construction of the said works shall be completed and the water shall be beneficially used prior to December 31, 2018. Thereafter, the licensee shall continue to make regular beneficial use of the water in the manner authorized herein.
- j) This licence is issued under the Water Act (the Act). The exercise of rights under the licence is subject to the Act and its regulations, the terms and conditions of the licence, orders under the Act and the rights of licensees whose rights have precedence on the stream. The licensee must comply with all such requirements, as well as the provisions of all other applicable enactments. In exercising rights under the licence, the licensee must exercise reasonable care to avoid damaging land, works, trees or other property, and must make full compensation to the owners for damage or loss resulting from construction, maintenance, use, operation or failure of the works.

k) This Licence is issued in substitution of Conditional Licence 110204, in part.

DJW

David J. Weir
Assistant Regional Water Manager

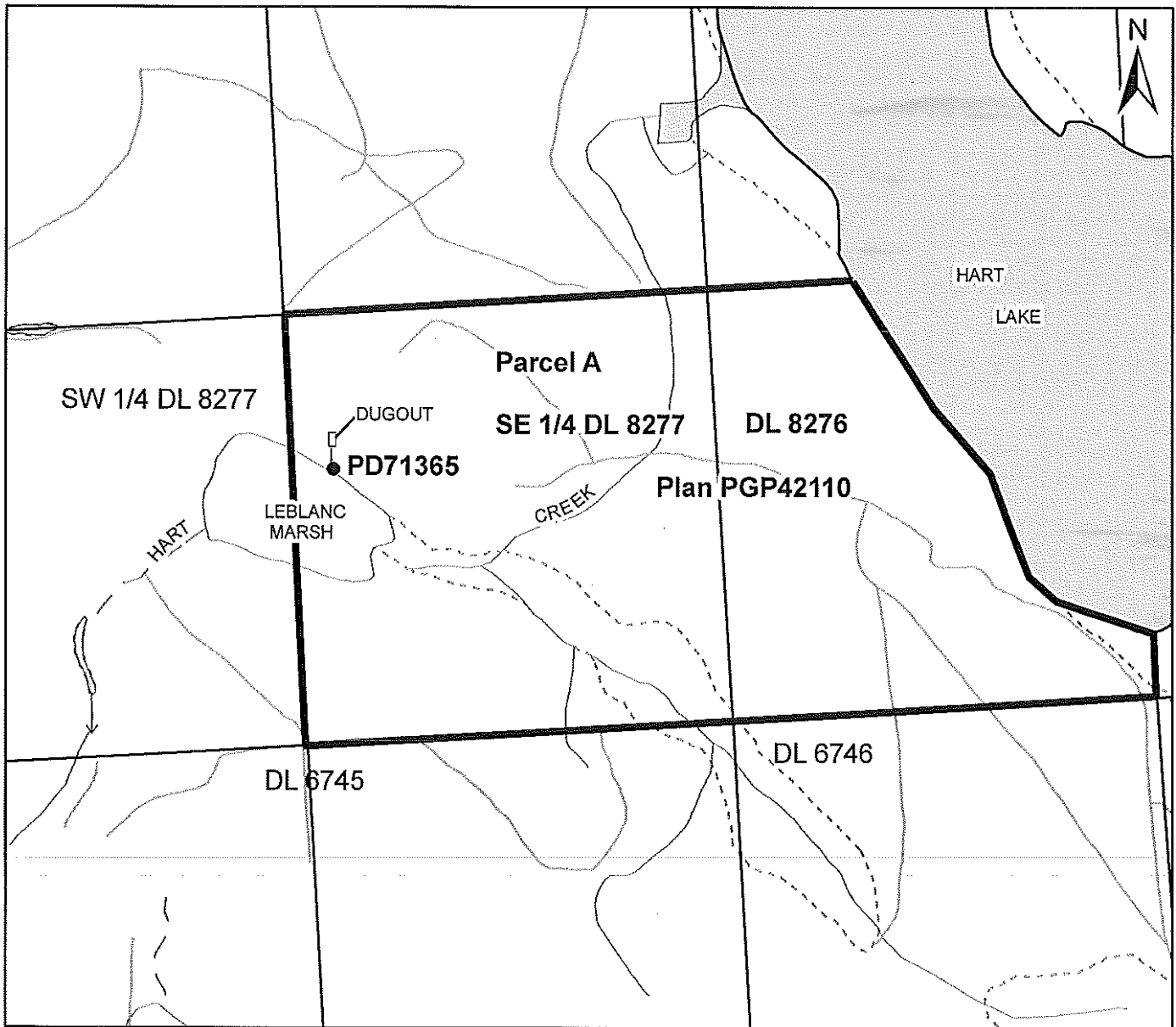

Legend

Scale: 1:12,000

Map Number: 93.A.041

Point of Diversion: ● PD71365

Ditch: - - - - -

The boundaries of the land to which this licence is appurtenant are shown thus: **—————**

Water District: CARIBOO

Precinct: QUESNEL RIVER

Land District: CARIBOO

Signature: *MK*

Date: February 23, 2015

C.L.: 131720 for C.L. 110204, in part

File: 5002407