



Province of British Columbia

Water Act

CONDITIONAL WATER LICENCE

The owner(s) of the land to which this licence is appurtenant is/are hereby authorized to store water as follows:

- a) The stream on which the rights are granted is Summers Creek and storage is in the reservoir Missezula Lake.
- b) The storage site is located as shown on the attached plan.
- c) The date from which this licence shall have precedence is April 1, 1921.
- d) The purpose for which this licence is issued is storage.
- e) The maximum quantity of water which may be diverted to fill the reservoir is 6,167 cubic metres (5 acre feet) per year.
- f) The period of the year during which water may be diverted into storage is October 1 to June 15.
- g) The land upon which the water is to be used and to which this licence is appurtenant is Lot 4 District Lot 3345 Kamloops Division Yale District Plan KAP85381.
- h) The authorized works are dam which shall be located approximately as shown on the attached plan.
- i) The construction of the said works has been completed and the water is being used. The licensee shall continue to make regular beneficial use of the water in a manner authorized herein.
- j) This licence is issued under the *Water Act* (the Act). The exercise of rights under the licence is subject to the Act and its regulations, the terms and conditions of the licence, orders under the Act and the rights of licensees whose rights have precedence on the stream. The licensee must comply with all such requirements, as well as the provisions of all other applicable enactments. In exercising rights under the licence, the licensee must exercise reasonable care to avoid damaging land, works, trees or other property, and must make full compensation to the owners for damage or loss resulting from construction, maintenance, use, operation or failure of the works.

k) This Licence is issued in substitution of Final Water Licence F006471, in part.

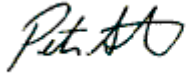
A handwritten signature in black ink, appearing to read "Peter Stroes". The signature is cursive and somewhat stylized, with a large initial "P" and a distinct "S" at the end.

Peter Stroes R.P.F.
Assistant Regional Water Manager

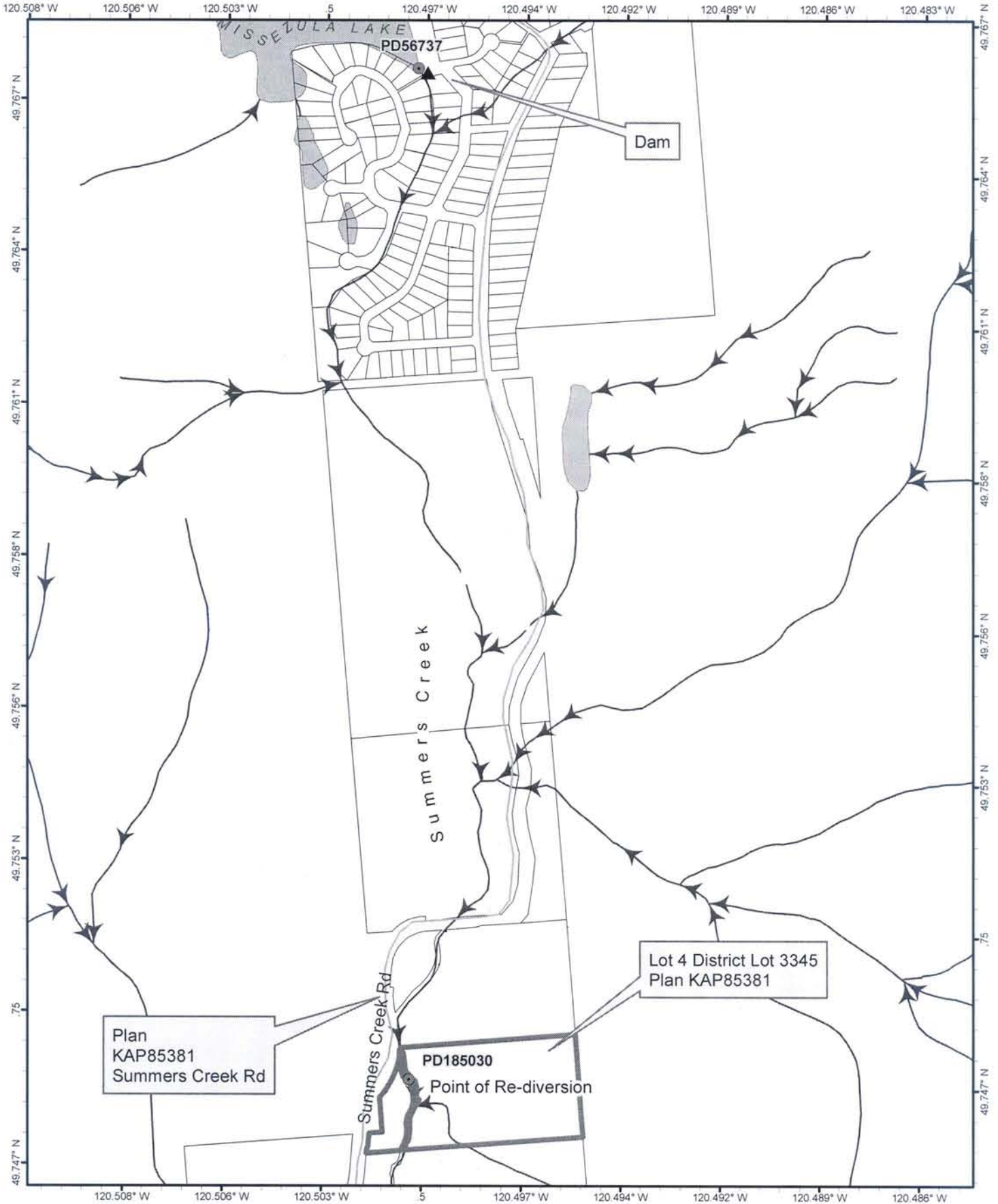

Scale: 1:10,000



Point of Diversion: ●
Works points ▲ Dam

Direction of Flow: →

The boundaries of the land to which this licence is appurtenant are shown thus: ———

Mapsheets : **092H058**

Land District : Kamloops Division Yale District

Water District: Princeton

Precinct: Princeton

Signature: *Rob A*

Date: Dec. 18, 2014



Licence: C131823 For F006471, in part
File: 0030069
PCL#: N/A