



Province of British Columbia

Water Act

CONDITIONAL WATER LICENCE

The owners of the land to which this licence is appurtenant is/are hereby authorized to divert and use water as follows:

- a) The stream on which the rights are granted is Joslin Spring.
- b) The point of diversion is located as shown on the attached plan.
- c) The date from which this licence shall have precedence is May 24, 1977.
- d) The purpose for which this licence is issued is domestic.
- e) The maximum quantity of water which may be diverted for domestic use is 2.27305 cubic metres (500 gallons) per day.
- f) The period of the year during which the water may be used is the whole year.
- g) The land upon which the water is to be used and to which this licence is appurtenant is District Lot 985, Yale Division Yale District Except Plans H17683 and KAP54888.
- h) The authorized works is a diversion structure which shall be located approximately as shown on the attached plan.
- i) The construction of the said works has been completed and the water is being used. The licensee shall continue to make regular beneficial use of the water in a manner authorized herein.
- j) This licence is issued under the *Water Act* (the Act). The exercise of rights under the licence is subject to the Act and its regulations, the terms and conditions of the licence, orders under the Act and the rights of licensees whose rights have precedence on the stream. The licensee must comply with all such requirements, as well as the provisions of all other applicable enactments. In exercising rights under the licence, the licensee must exercise reasonable care to avoid damaging land, works, trees or other property, and must make full compensation to the owners for damage or loss resulting from construction, maintenance, use, operation or failure of the works.

- k) This Licence is issued in substitution of Conditional Water Licence Number C131434, in part.

A handwritten signature in black ink, appearing to read "Peter Stroes". The signature is written in a cursive, flowing style.

Peter Stroes R.P.F.
Assistant Regional Water Manager

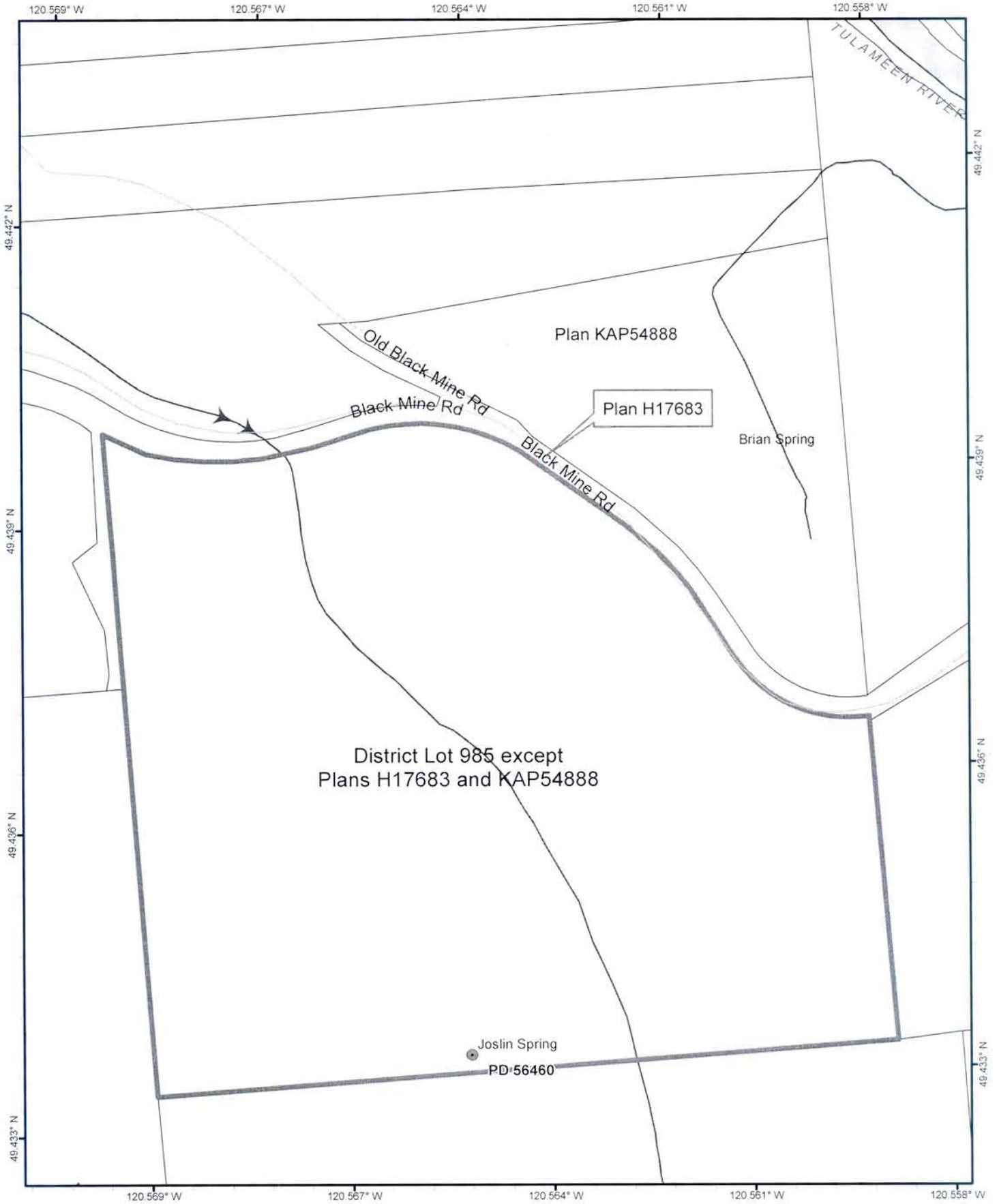

Scale: 1:5,000



Point of Diversion: 

Direction of Flow: 

The boundaries of the land
to which this licence is appurtenant
are shown thus: 

Mapsheet : **092H048**

Land District : Yale Division Yale District

Water District: Princeton

Precinct: Princeton

Signature: 

Date: Dec. 12, 2014



Licence: C131909 For C131434 in Part
File: 0341309
PCL#: N/A