



Province of British Columbia

Water Act

CONDITIONAL WATER LICENCE

The owner(s) of the land to which this licence is appurtenant is/are hereby authorized to divert and use water as follows:

- a) The stream(s) on which the rights are granted is Little Bridge Creek.
- b) The points of diversion are located as shown on the attached plan.
- c) The date from which this licence shall have precedence is March 1st, 1984.
- d) The purpose for which this licence is issued is irrigation.
- e) The maximum quantity of water which may be diverted for irrigation is 143,084.84 cubic metres (116 acre feet) per annum.
- f) The period of the year during which the water may be used is from April 1st to September 30th.
- g) The land upon which the water is to be used and to which this licence is appurtenant is District Lot 33, except Plans 9438, 13469, 153259, 17172, 24290, 29292, 29785, H889, H16641, 37734, KAP55350, KAP57210, H123, H927 and H949; District Lot 4174, except Plans B9051, B13360, H927, H16641, KAP47643 and KAP87724; and District Lot 4175, except Plans 9072, 9585, 15127, 15359, 16505, 17172, 19437, B9051, 22294, 22429, 24290, 29292, 32999, H889, H16641, KAP55350, H123, H927 and H949, all Lillooet District of which 23.47 hectares (58 acres) may be irrigated.
- h) The authorized works are screened intake, pump, pipe and sprinkler system which shall be located approximately as shown on the attached plan.
- i) The construction of the said works has been completed and the water is being used. The licensee shall continue to make regular beneficial use of the water in a manner authorized herein.
- j) The water authorized to be diverted and used under this licence must be taken from storage provided in Exeter Lake under Conditional Water Licence No. 131915, or any licence issued in substitution thereof.

- k) The rights granted herein are exercisable only during such time as the works under Conditional Water Licence No. 131915, or any licence issued in substitution thereof, are being maintained and operated to the satisfaction of an Engineer under the Water Act.
- l) This licence is issued under the Water Act (the Act). The exercise of rights under the licence is subject to the Act and its regulations, the terms and conditions of the licence, orders under the Act and the rights of licensees whose rights have precedence on the stream. The licensee must comply with all such requirements, as well as the provisions of all other applicable enactments. In exercising rights under the licence, the licensee must exercise reasonable care to avoid damaging land, works, trees or other property, and must make full compensation to the owners for damage or loss resulting from construction, maintenance, use, operation or failure of the works.
- m) This Licence is issued in substitution of Conditional Water Licence No. 063264, in part.

DSW

David J. Weir
Assistant Regional Water Manager

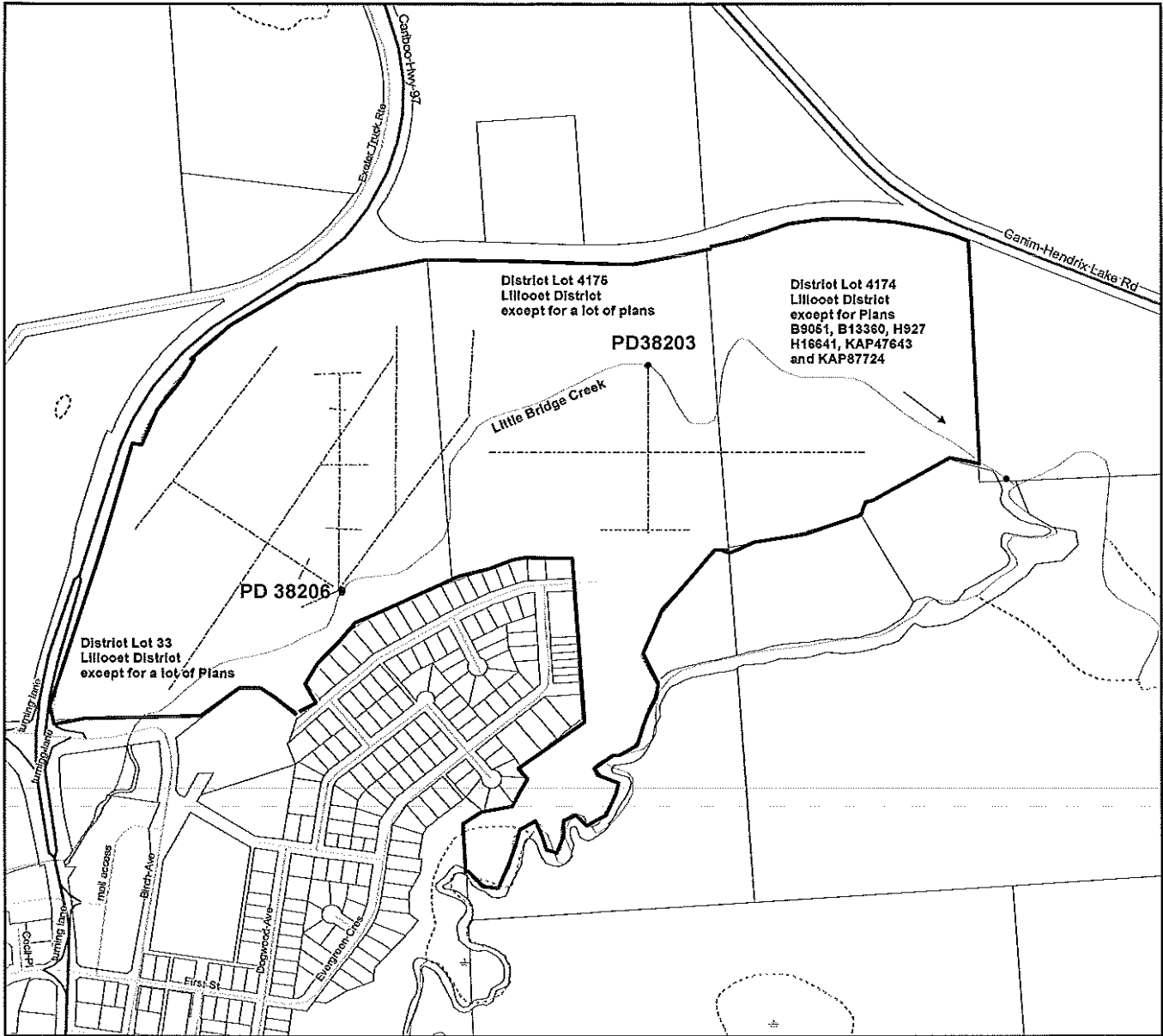

WATER DISTRICT: CARIBOO
PRECINCT: Clearwater
LAND DISTRICT: Lillooet

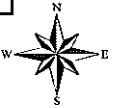

LEGEND:
 Scale: 1:10,000
 Map Number: 92.P.064
 Point of Diversion: ●
 Pipe: -----

Signature: *[Handwritten Signature]*
 Date: December 3rd 2014

C.L. 131912 for C.L. 063264, in part
 File: 5002425

The boundaries of the land to which this licence is appurtenant are shown thus: **—————**