



Province of British Columbia

Water Act

CONDITIONAL WATER LICENCE

The owner of the land to which this licence is appurtenant is hereby authorized to divert and use water as follows:

- a) The stream on which the rights are granted is Acland Spring.
- b) The point of diversion is located as shown on the attached plan.
- c) The date from which this licence shall have precedence is October 17, 1952.
- d) The purpose for which this licence is issued is domestic.
- e) The maximum quantity of water which may be diverted for domestic purpose is 2.27 cubic metres per day.
- f) The period of the year during which the water may be used is the whole year.
- g) The land upon which the water is to be used and to which this licence is appurtenant is Lot 2, Section 6, Range 1 West, North Saltspring Island, Cowichan District, Plan EPP2308.
- h) The authorized works are dugout, intake, pump and pipe which shall be located approximately as shown on the attached plan.
- i) The construction of the said works has been completed and the water is being used. The licensee shall continue to make regular beneficial use of the water in a manner authorized herein.
- j) This licence authorizes the use of water for domestic purpose in one dwelling located approximately as shown on the attached plan.
- k) This licence is issued in substitution of Conditional Water Licence C118246.

Darryl Slater
Assistant Regional Water Manager



BRITISH COLUMBIA

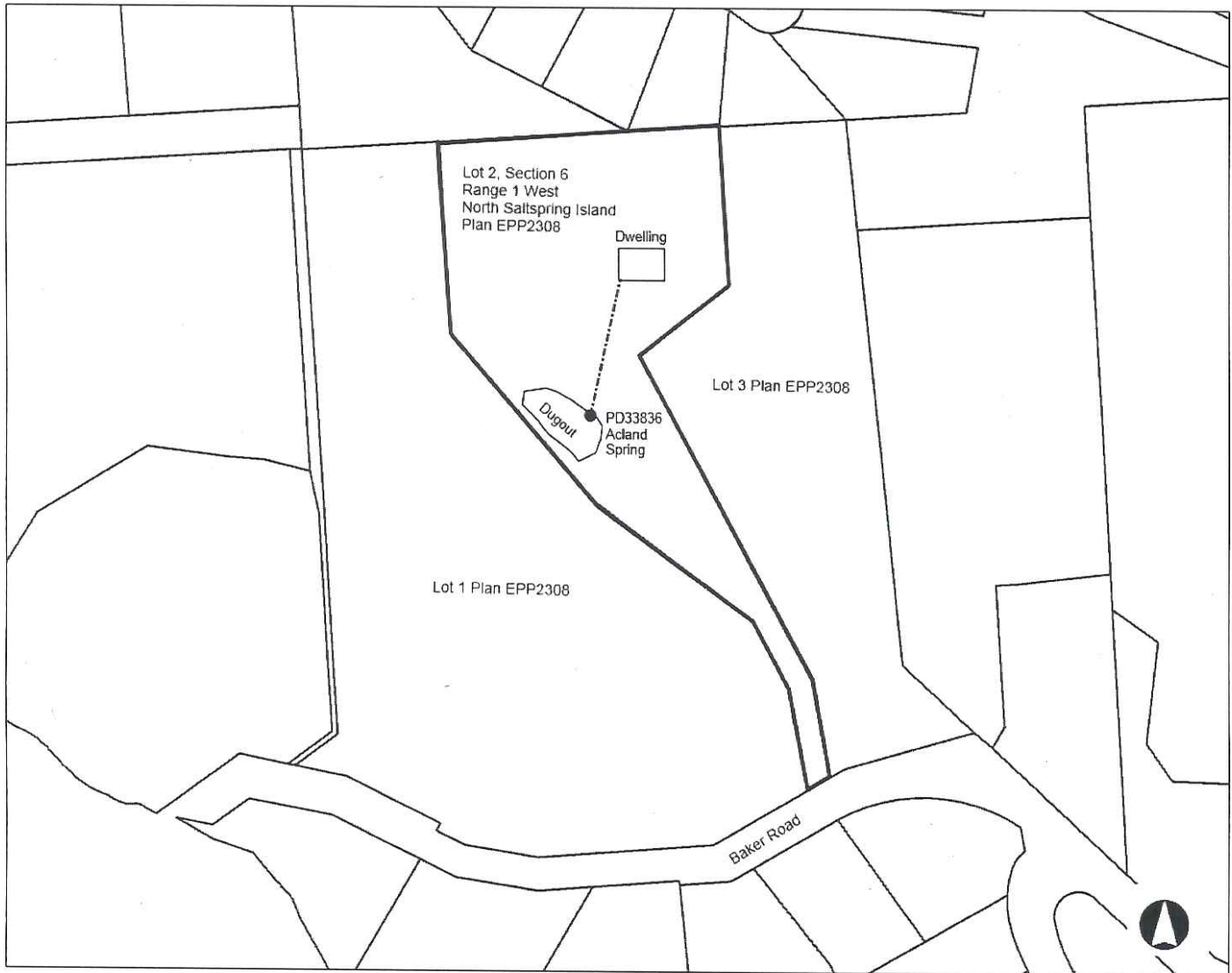

WATER DISTRICT: Victoria
 PRECINCT: Shawnigan
 LAND DISTRICT: Cowichan

Signature: 

Date: DEC 15 2014

LEGEND:

Scale: 1: 3,000

Point of Division: 

Map Number: 92B.083.3.2

Pipe: 

Amended C.L. C131913

File 0197051

P.C.L. Not Applicable

Supercedes Conditional Water Licence C118246.

The boundaries of the land to which this licence is appurtenant are shown thus: 