



Province of British Columbia

Water Act

CONDITIONAL WATER LICENCE

The owner(s) of the land to which this licence is appurtenant is/are hereby authorized to store water as follows:

- a) The stream on which the rights are granted is Little Bridge Creek and the reservoir is Little Bridge Creek.
- b) The storage site is located as shown on the attached plan.
- c) The date from which this licence shall have precedence is March 6th, 1922.
- d) The purpose for which this licence is issued is as set out in Conditional Water Licences 063257 and 063261.
- e) The maximum quantity of water which may be stored is 13,568.39 cubic metres (11 acre feet) per annum.
- f) The period of the year during which the water may be stored is October 1st to June 15th.
- ~~g) The land upon which the water is to be used and to which this licence is appurtenant is as set out in Conditional Water Licences 063257 and 063261.~~
- h) The authorized works is a dam which shall be located approximately as shown on the attached plan.
- i) The construction of the said works has been completed and the water is being used. The licensee shall continue to make regular beneficial use of the water in a manner authorized herein.
- j) The dam authorized under clause (h) is subject to the Dam Safety Regulations and shall be designed, constructed and maintained to the satisfaction of a Dam Safety Officer under the Water Act and in accordance with the Canadian Dam Association Guidelines.

- k) This licence is issued under the Water Act (the Act). The exercise of rights under the licence is subject to the Act and its regulations, the terms and conditions of the licence, orders under the Act and the rights of licensees whose rights have precedence on the stream. The licensee must comply with all such requirements, as well as the provisions of all other applicable enactments. In exercising rights under the licence, the licensee must exercise reasonable care to avoid damaging land, works, trees or other property, and must make full compensation to the owners for damage or loss resulting from construction, maintenance, use, operation or failure of the works.
- l) This Licence is issued in substitution of Conditional Water Licence No. 063266, in part.

DJW

David J. Weir
Assistant Regional Water Manager

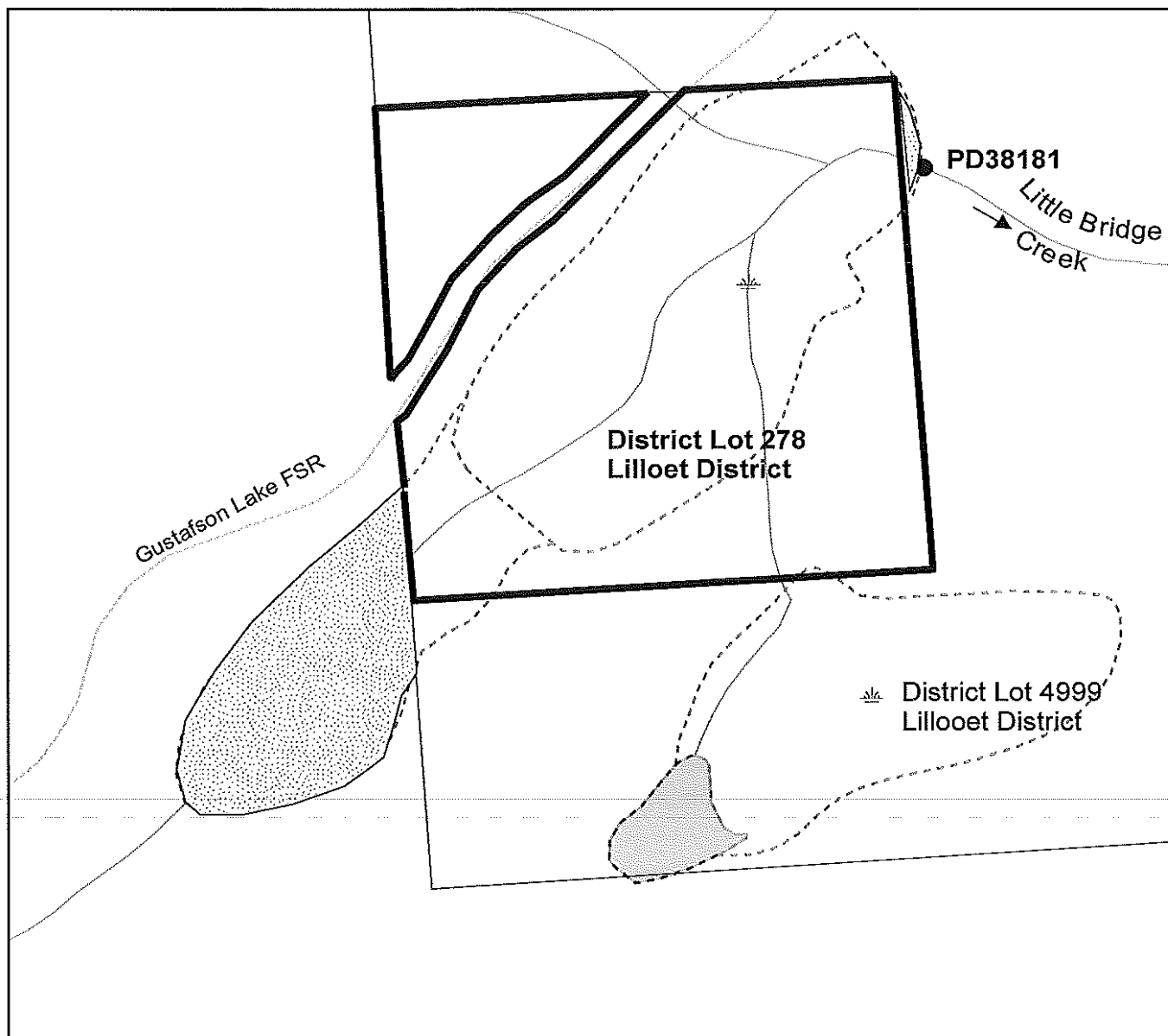

WATER DISTRICT: CARIBOO

PRECINCT: Clearwater

LAND DISTRICT: Lillooet

LEGEND:

Scale: 1:5,000

Map Number: 92.P.063 G

Dam: ●

Permit over Crown Land: 

Signature: 

Date: December 3rd 2014

C.L. 131946 for C.L. 063266, in part

PCL No.: 28045

File: 5002432

For Diversion See C.L.'s 063257
& 063261

The boundaries of the land to which this licence is appurtenant are shown thus: 



Province of British Columbia

Water Act

PERMIT AUTHORIZING THE OCCUPATION OF CROWN LAND

The holder of Conditional Water Licence C131946 whose licence authorizes the storage of water from Little Bridge Creek is hereby authorized to occupy Crown land by constructing, maintaining and operating thereon the works authorized under the said licence.

- (a) The Crown land which is authorized to be occupied under this permit is a portion of that fractional portion of Lot 4999 and unsurveyed Crown Land to the West of Lot 4999, all of Lillooet District, the location of which is shown approximately on the plan attached to the said water licence.
- (b) The approximate dimensions of the Crown Land authorized to be occupied under this permit, are for: Flooding (an area of 4.45154 hectares), Dam Site (an area of .40469 hectares), and having a total area of 4.85623 hectares.
- (c) Prior to cutting, destroying or clearing of any timber necessary to construct, maintain and operate the said works or the clearing of the said lands which may be flooded, the permittee shall apply for and obtain a licence to cut timber from the Ministry of Forests, Lands and Natural Resource Operations, District Manager. The amount of stumpage, royalty and/or compensation payable to the Crown in respect of trees, including merchantable or young growth, cut, removed, damaged, or destroyed by the permittee, shall be the sum or sums fixed by the Ministry of Forests, Lands and Natural Resource Operations.
- (d) This permit is appurtenant to the land, mine, or undertaking to which the aforesaid water licence is appurtenant.
- (e) This permit shall become void if the water licence with respect to which the permit is issued should terminate, be abandoned or cancelled, or amended so as to render this permit unnecessary.
- (f) This permit is issued and accepted on the understanding that the permittee shall indemnify and save harmless the Government of the Province of British Columbia for all loss, damage to works, cost or expense suffered by the permittee by reason of the Crown land or any portion thereof being submerged or damaged by erosion or otherwise affected by flooding.

- (g) The holder of this permit shall not be entitled to compensation if the Crown grants permits to other persons to occupy the land affected by this permit.
- (h) In the event of a dispute at any time with respect to the area or boundaries of the land affected by this permit, the holder shall, at his own expense, have the said land surveyed by a duly authorized surveyor.
- (i) This Permit replaces Permit No.15250

DSW

David J. Weir
Assistant Regional Water Manager