



Province of British Columbia

Water Act

CONDITIONAL WATER LICENCE

The owner of the land to which this licence is appurtenant is hereby authorized to divert, use and store water as follows:

- a) The stream on which the rights are granted is the Fraser River.
- b) The point of diversion is located as shown on the attached plan.
- c) The date from which this licence shall have precedence is February 25, 2014.
- d) The purpose for which this licence is issued is domestic.
- e) The maximum quantity of water which may be diverted 2.270 cubic meters (500 gallons) per day.
- f) The water may be used throughout the whole year.
- g) The land upon which the water is to be used and to which this licence is appurtenant is Block A of District Lot 6178 Cariboo District, except the Southerly 20 Chains.
- h) The authorized works are pump, cistern and pipe with a screened intake which shall be located approximately as shown on the attached plan.
- i) The construction of the said works shall be completed and the water shall be beneficially used prior to December 31, 2018. Thereafter, the licensee shall continue to make regular beneficial use of the water in the manner authorized herein.

- j) This licence is issued under the Water Act (the Act). The exercise of rights under the licence is subject to the Act and its regulations, the terms and conditions of the licence, orders under the Act and the rights of licensees whose rights have precedence on the stream. The licensee must comply with all such requirements, as well as the provisions of all other applicable enactments. In exercising rights under the licence, the licensee must exercise reasonable care to avoid damaging land, works, trees or other property, and must make full compensation to the owners for damage or loss resulting from construction, maintenance, use, operation or failure of the works.



David J. Weir
Assistant Regional Water Manager

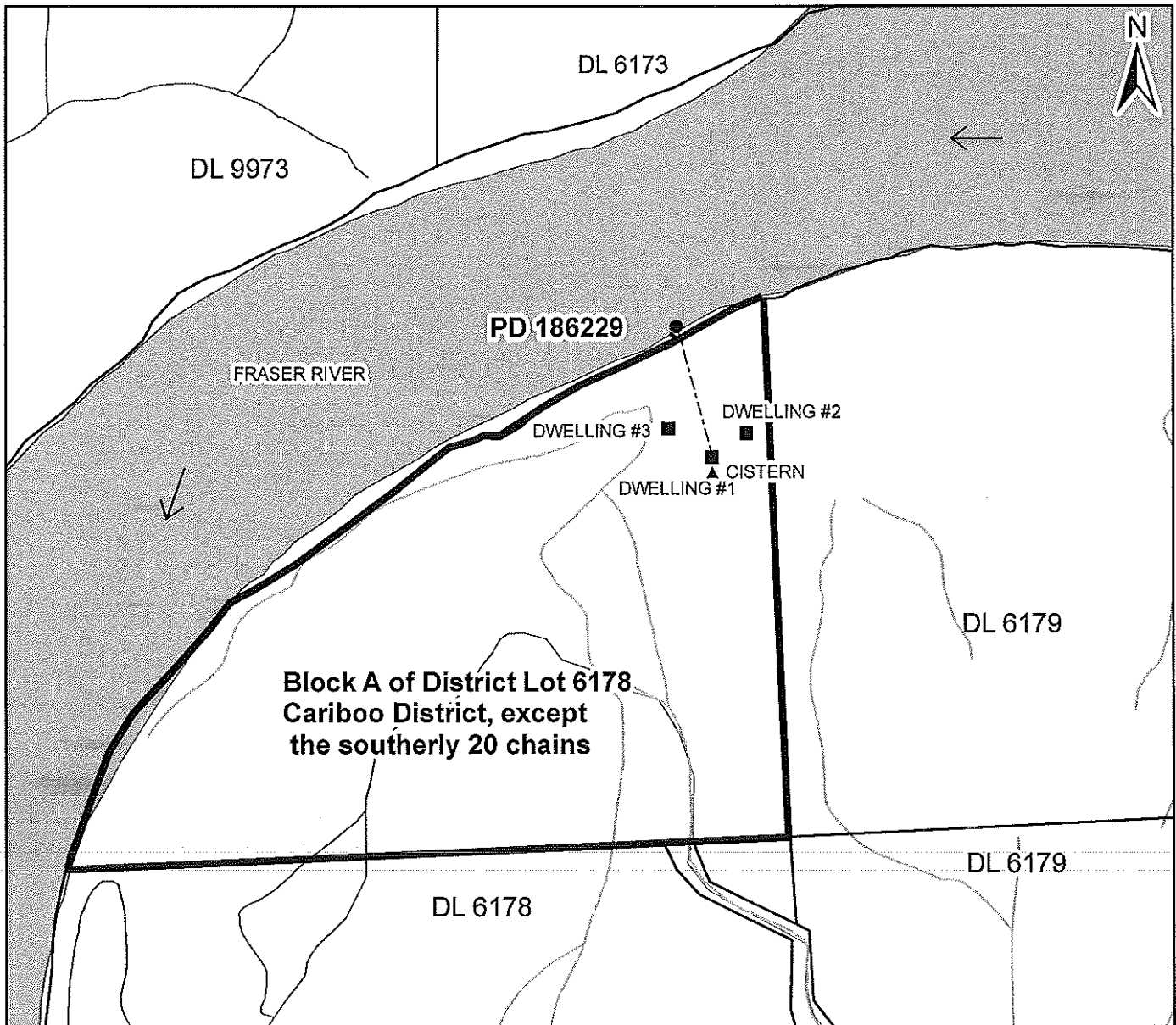

Legend

- Scale: 1:8,000
- Map Number: 93.G.008.3.3
- Point of Diversion: ● PD 186229
- Resident Dwelling: ■
- Cistern: ▲
- Pipe: -----

The boundaries of the land to which this licence is appurtenant are shown thus: **—————**

Water District: QUESNEL
Precinct: COTTONWOOD
Land District: CARIBOO

Signature: *NU*

Date: January 16, 2015

CL: 131972

File: 5002394