



Province of British Columbia

Water Act

CONDITIONAL WATER LICENCE

The owner(s) of the land to which this licence is appurtenant are hereby authorized to divert and use water as follows:

- a) The stream on which the rights are granted is Trott Gulch.
- b) The point of diversion is located as shown on the attached plan.
- c) The date from which this licence shall have precedence is 19th December, 2005.
- d) The purposes for which this licence is issued are domestic and industrial (stock watering).
- e) The maximum quantity of water which may be diverted for domestic is 2.27305 cubic metres (500 gallons) per day and the maximum quantity which may be used for industrial (stock watering) is 2.27305 cubic metres (500 gallons) per day.
- f) The period of the year during which the water may be used is the Whole year.
- g) The land upon which the water is to be used and to which this licence is appurtenant is District Lot 2186, Kamloops Division Yale District except Plan 41636.
- h) The authorized works are diversion structure, pipe and trough which shall be located approximately as shown on the attached plan.
- i) The construction of the said works shall be completed and the water shall be beneficially used prior to December 31, 2017. Thereafter, the licensee shall continue to make regular beneficial use of the water in the manner authorized herein.
- j) This licence authorizes the use of water for domestic purpose in one (1) dwelling located approximately as shown on the attached plan.
- k) The industrial stock watering purpose authorized by this licence is for use outside the wetted perimeter of the source in a trough located approximately as shown on the attached plan.
- l) The rights granted under this licence are subject to a water reserve established by Order in Council No. 1511 dated November 12, 1919.

- m) This licence is issued under the Water Act (the Act). The exercise of rights under the licence is subject to the Act and its regulations, the terms and conditions of the licence, orders under the Act and the rights of licensees whose rights have precedence on the stream. The licensee must comply with all such requirements, as well as the provisions of all other applicable enactments. In exercising rights under the licence, the licensee must exercise reasonable care to avoid damaging land, works, trees or other property, and must make full compensation to the owners for damage or loss resulting from construction, maintenance, use, operation or failure of the works.
- n) This Licence is issued in substitution of Conditional Water Licence 121541.



Rick Sommer
Assistant Regional Water Manager/District Manager

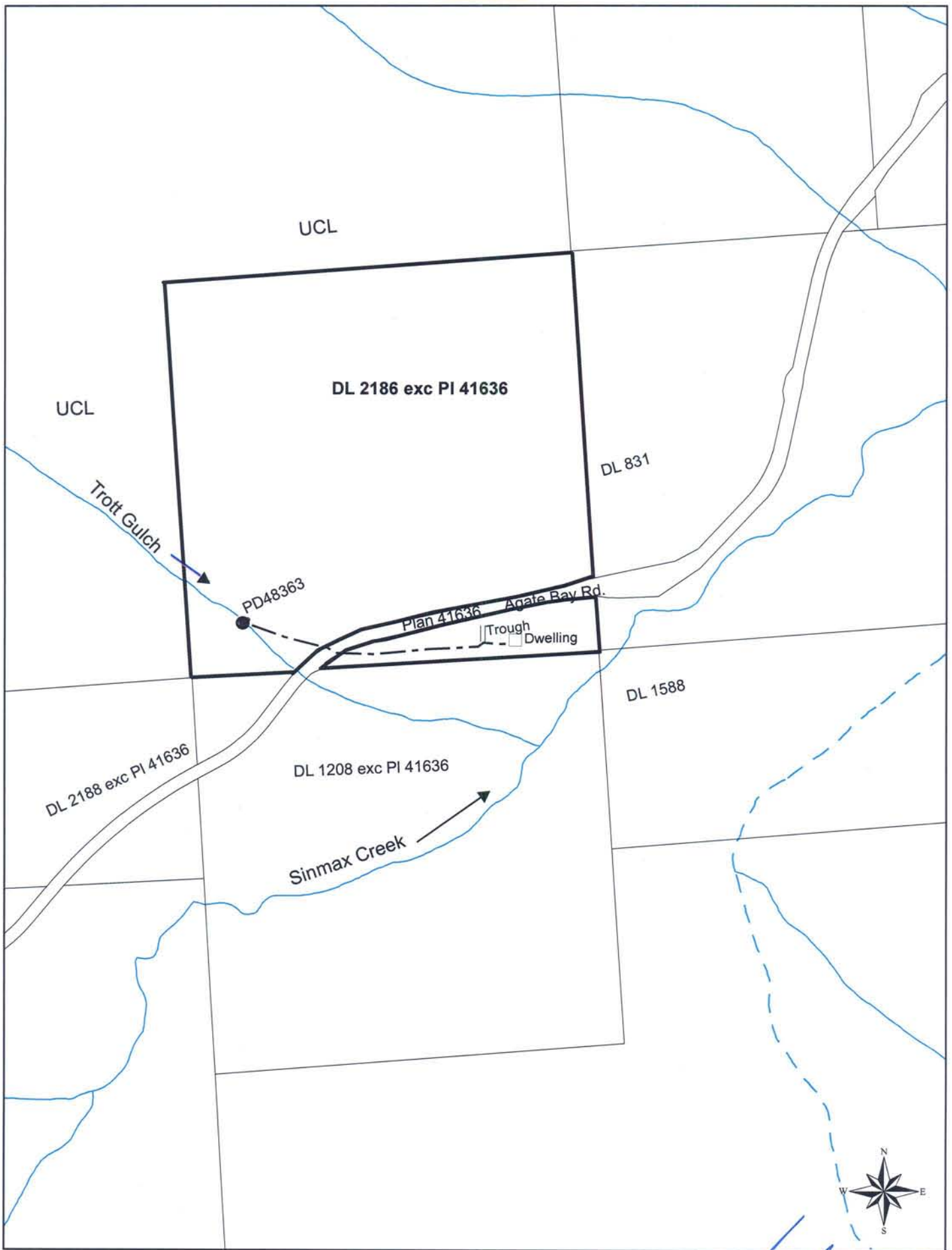

WATER DISTRICT: Kamloops
PRECINCT: Adams River
LAND DISTRICT: Kamloops Division Yale District

Signature: 
 Date: Dec 17/14

LEGEND:
 Scale: 1:10,000
 Point of Diversion: ●
 Map Number: WR 3608 (82M.011)
 Pipe: - - - -

C.L. 131989 for C.L. 121541
 File: 3004571

The boundaries of the land to which this licence is appurtenant are shown thus: 