



Province of British Columbia *Water Act*

CONDITIONAL WATER LICENCE

The owners of the land to which this licence is appurtenant are hereby authorized to divert and use water as follows:

- a) The stream on which the rights are granted is Cliff Creek.
- b) The point of diversion is located as shown on the attached plan.
- c) The date from which this licence shall have precedence is July 7, 1970.
- d) The purpose for which this licence is issued is waterworks.
- e) The maximum quantity of water which may be diverted is 45.46 cubic metres per day for waterworks purpose.
- f) The period of the year during which the water may be used is the whole year.
- g) The land upon which the water is to be used and to which this licence is appurtenant is the Fractional South East 1/4 of District Lot 5339, Cariboo District except Parcel A (N42430) and Plans 20852, 21079 and PGP38823.
- h) The authorized works are screened intake, diversion structure, tanks, pipe and distribution system which shall be located approximately as shown on the attached plan.
- i) The construction of the said works has been completed and the water is being used. The licensee shall continue to make regular beneficial use of the water in a manner authorized herein.
- j) This Licence is issued in substitution of Conditional Water licence C062719.

Robert M Piccini
Assistant Regional Water Manager



BRITISH
COLUMBIA

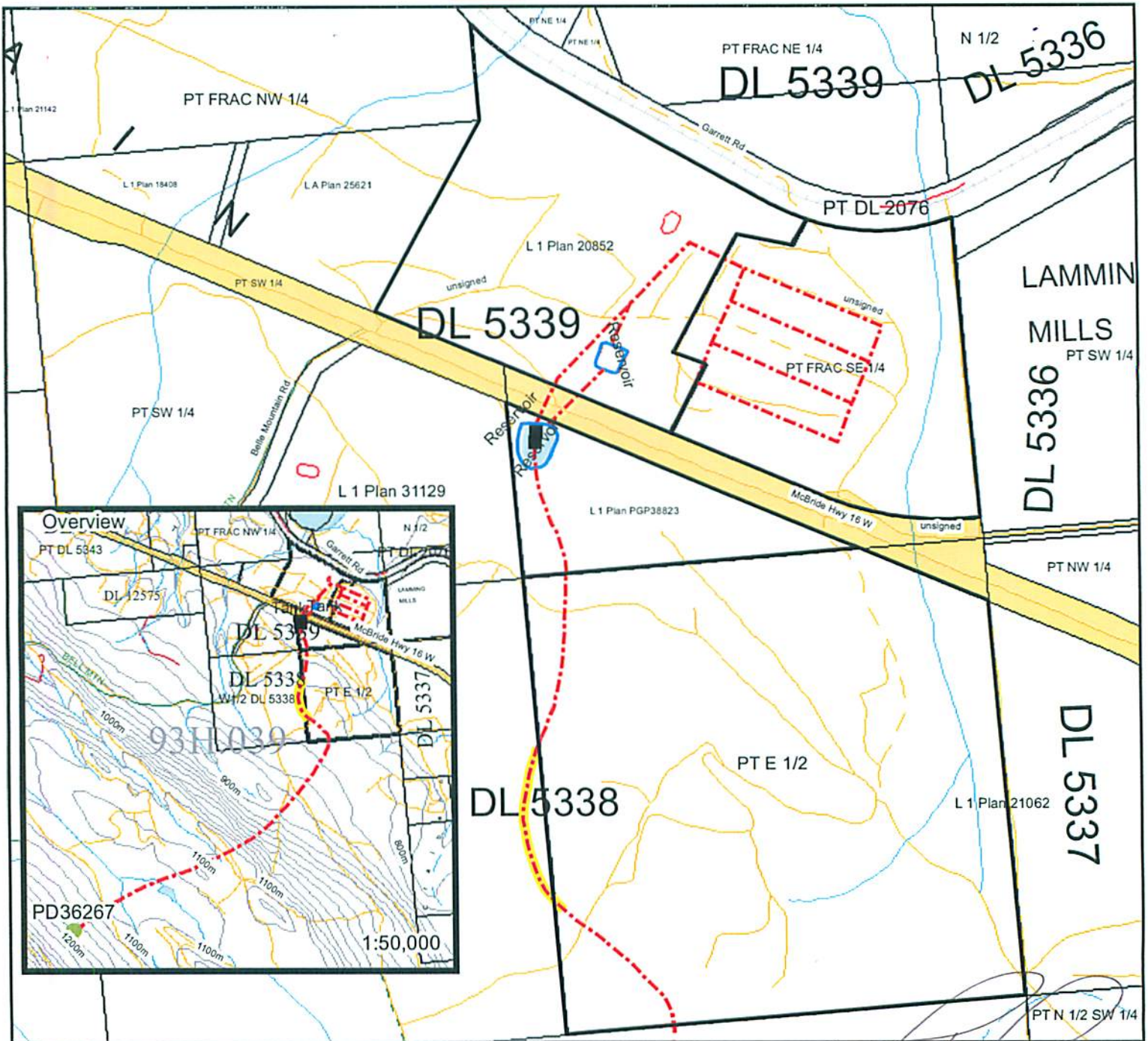

WATER DISTRICT:

PRECINCT:

LAND DISTRICT:

LEGEND:

Scale:

Point of Diversion:

Map Number:

Pipe

Permit over Crown Land

The boundaries of the land to which this licence
is appurtenant are shown thus:

Prince George

McBride

Cariboo

1:10,000

93H039

PD36267

Signature:

Date:

MAR 17 2015

C.L. C132111

File: 0296769

P.C.L. 28109