



# Province of British Columbia

## *Water Act*

### CONDITIONAL WATER LICENCE

The owner(s) of the land to which this licence is appurtenant is/are hereby authorized to divert and use water as follows:

- a) The stream on which the rights are granted is Deka Lake.
- b) The point of diversion is located as shown on the attached plan.
- c) The date from which this licence shall have precedence is September 9, 2014.
- d) The purpose for which this licence is issued is domestic.
- e) The maximum quantity of water which may be diverted for domestic use is 2.273 cubic metres (500 gallons) per day.
- f) The period of the year during which the water may be used is the whole year.
- g) The land upon which the water is to be used and to which this licence is appurtenant is Lot 13, District Lot 3723, Lillooet District, Plan 21643.
- h) The authorized works are screened intake, pump and pipe which shall be located approximately as shown on the attached plan.
- i) The construction of the said works shall be completed and the water shall be beneficially used prior to December 31, 2018. Thereafter, the licensee shall continue to make regular beneficial use of the water in the manner authorized herein.
- j) This licence authorizes the use of water for domestic purpose in one dwelling located approximately as shown on the attached plan.

- k) This licence is issued under the Water Act (the Act). The exercise of rights under the licence is subject to the Act and its regulations, the terms and conditions of the licence, orders under the Act and the rights of licensees whose rights have precedence on the stream. The licensee must comply with all such requirements, as well as the provisions of all other applicable enactments. In exercising rights under the licence, the licensee must exercise reasonable care to avoid damaging land, works, trees or other property, and must make full compensation to the owners for damage or loss resulting from construction, maintenance, use, operation or failure of the works.

*DJW*

David J. Weir  
Assistant Regional Water Manager

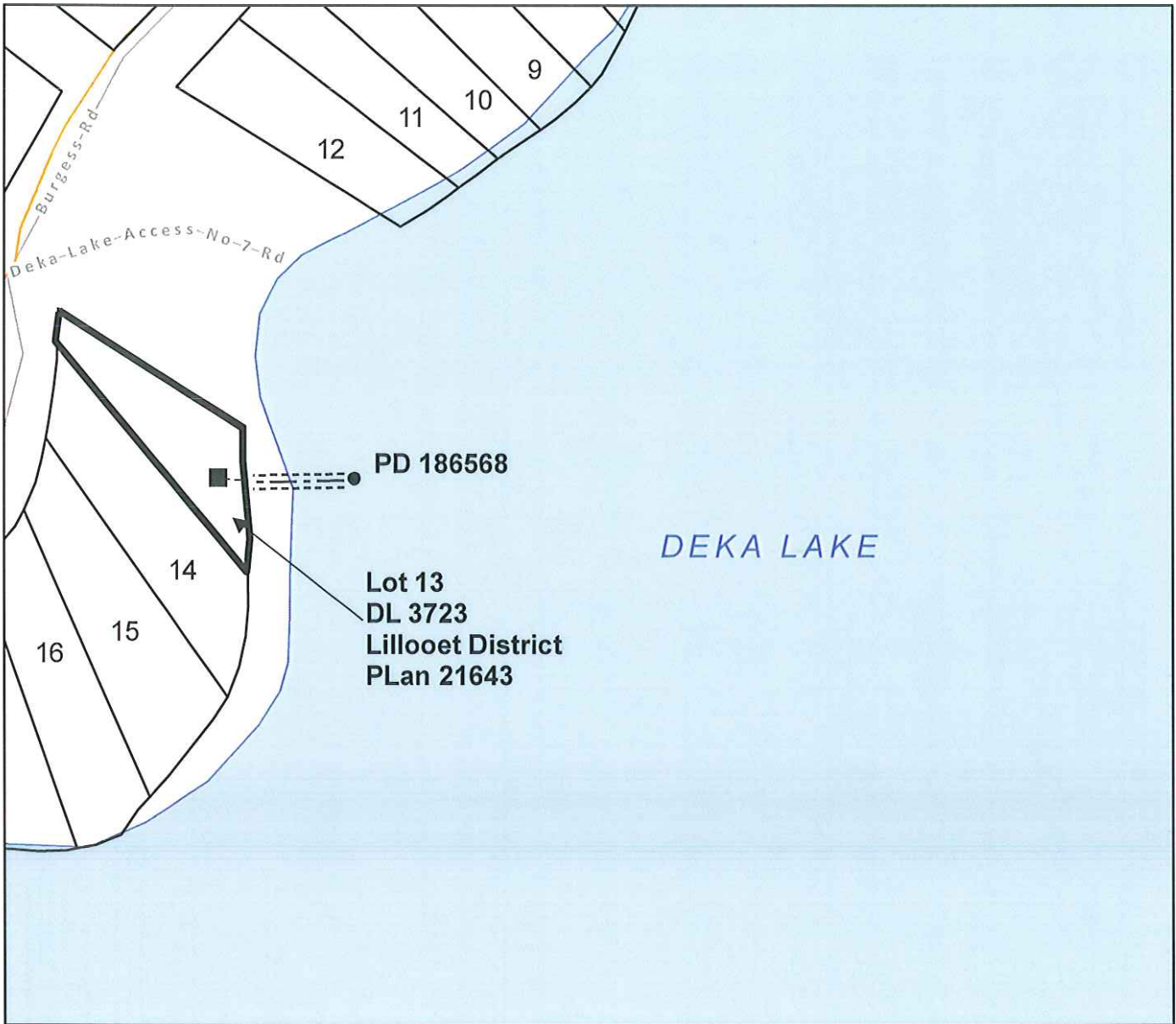

**Water District:** Cariboo  
**Precinct:** Clearwater  
**Land District:** Lillooet

Scale: 1:2,000  
 Map Number: 92P/NE(10-f)

Pipe: -----  
 Permit over Crown Land: =====  
 Point of Diversion: ●  
 Dwelling: ■

Signature: *[Handwritten Signature]*  
 Date: May 14<sup>th</sup> 2015

CL: 132274  
 PCL No.: 28178  
 File: 5002420

The boundaries of the land to which this licence is appurtenant are shown thus: **—————**



# Province of British Columbia

## *Water Act*

### PERMIT AUTHORIZING THE OCCUPATION OF CROWN LAND

The holder of Conditional Water Licence C132274 whose licence authorizes the diversion and use of water from Deka Lake is hereby authorized to occupy Crown land by constructing, maintaining and operating thereon the works authorized under the said licence.

- (a) The Crown land which is authorized to be occupied under this permit is a portion of unsurveyed foreshore and land within Lillooet District covered by waters of Deka Lake, the location of which is shown approximately on the plan attached to the said water licence.
- (b) The approximate dimensions of the Crown Land authorized to be occupied under this permit, are for: Works 30.5 metres in length by 5 metres in width, having an area of .01525 hectares.
- (c) Prior to cutting, destroying or clearing of any timber necessary to construct, maintain and operate the said works or the clearing of the said lands which may be flooded, the permittee shall apply for and obtain a licence to cut timber from the Ministry of Forests, Lands and Natural Resource Operations, District Manager. The amount of stumpage, royalty and/or compensation payable to the Crown in respect of trees, including merchantable or young growth, cut, removed, damaged, or destroyed by the permittee, shall be the sum or sums fixed by the Ministry of Forests, Lands and Natural Resource Operations.
- (d) This permit is appurtenant to the land, mine, or undertaking to which the aforesaid water licence is appurtenant.
- (e) This permit shall become void if the water licence with respect to which the permit is issued should terminate, be abandoned or cancelled, or amended so as to render this permit unnecessary.
- (f) This permit is issued and accepted on the understanding that the permittee shall indemnify and save harmless the Government of the Province of British Columbia for all loss, damage to works, cost or expense suffered by the permittee by reason of the Crown land or any portion thereof being submerged or damaged by erosion or otherwise affected by flooding.

- (g) The holder of this permit shall not be entitled to compensation if the Crown grants permits to other persons to occupy the land affected by this permit.
- (h) In the event of a dispute at any time with respect to the area or boundaries of the land affected by this permit, the holder shall, at his own expense, have the said land surveyed by a duly authorized surveyor.

*DSW*

David J. Weir  
Assistant Regional Water Manager