



Province of British Columbia

Water Act

CONDITIONAL WATER LICENCE

The owner of the land to which this licence is appurtenant is hereby authorized to divert and use water as follows:

- a) The stream on which the rights are granted is Mare Creek.
- b) The points of diversion are located as shown on the attached plan.
- c) The date from which this licence shall have precedence is April 5, 2014.
- d) The purpose for which this licence is issued is industrial (stock watering).
- e) The maximum quantity of water which may be diverted for industrial (stock watering) is 2.268 cubic meters (500 gallons) per day.
- f) The period of the year during which the water may be used is the whole year.
- g) The land upon which the water is to be used and to which this licence is appurtenant is District Lot 222 Range 2 Coast District and the Southeast 1/4 of the Northeast 1/4 of District Lot 366 Range 2 Coast District.
- h) The authorized works are diversion structure and pipe with screened intake which shall be located approximately as shown on the attached plan.
- i) The construction of the said works shall be completed and the water shall be beneficially used prior to December 31, 2018. Thereafter, the licensee shall continue to make regular beneficial use of the water in the manner authorized herein.

- j) This licence is issued under the Water Act (the Act). The exercise of rights under the licence is subject to the Act and its regulations, the terms and conditions of the licence, orders under the Act and the rights of licensees whose rights have precedence on the stream. The licensee must comply with all such requirements, as well as the provisions of all other applicable enactments. In exercising rights under the licence, the licensee must exercise reasonable care to avoid damaging land, works, trees or other property, and must make full compensation to the owners for damage or loss resulting from construction, maintenance, use, operation or failure of the works.

DJW

David J. Weir
Assistant Regional Water Manager

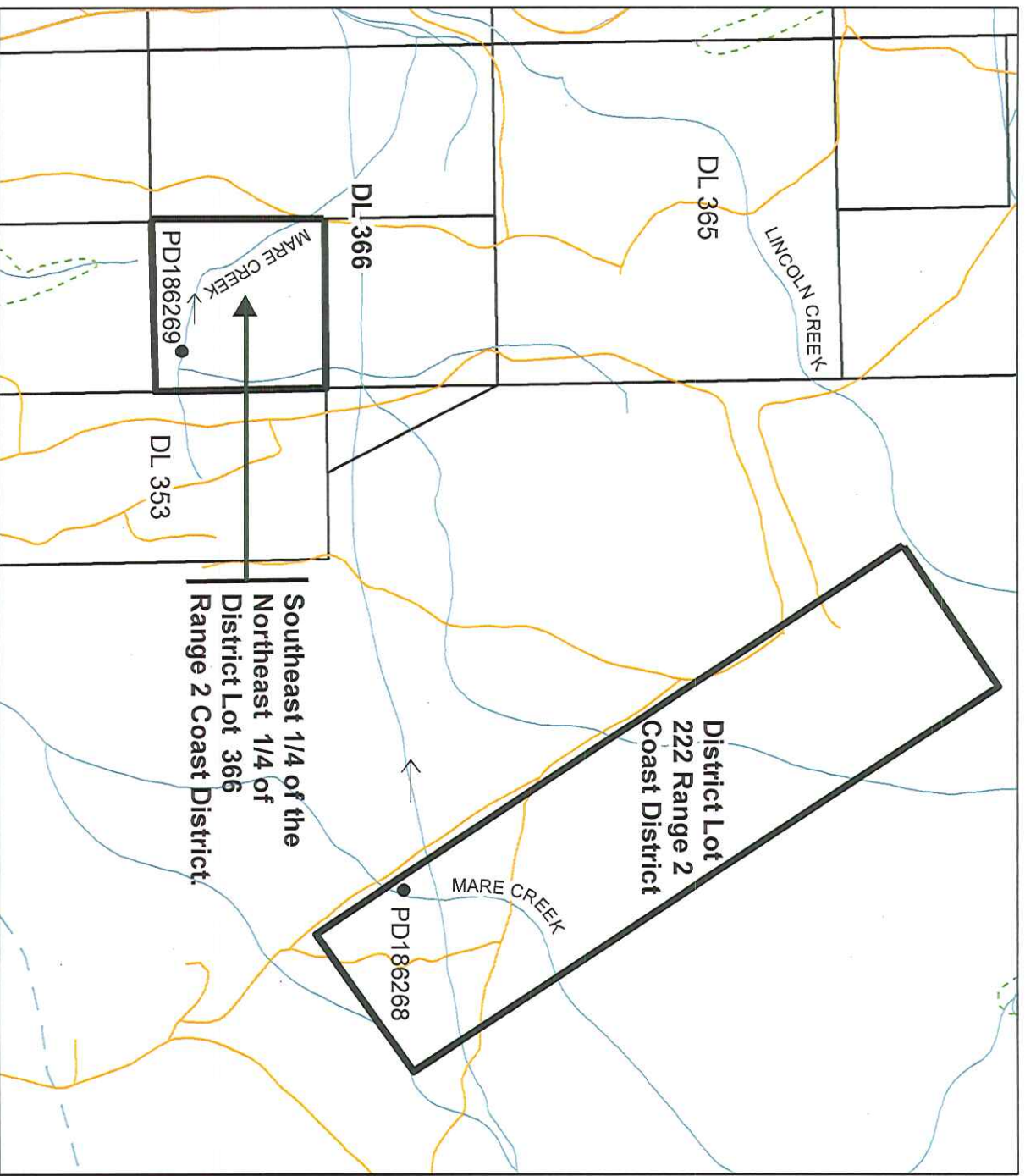

Legend

Scale: 1:15,000

Map Number: 92.N.069

Point of Diversion: ●

The boundaries of the
land to which this licence
is apurtenant are
shown thus: ———

Water District: CARIBOO

Precinct: CHILCOTIN

Land District RANGE 2, COAST

Signature: 

Date: April 21st 2015

CL: 132145

File: 5002397

