



Province of British Columbia

Water Act

CONDITIONAL WATER LICENCE

The owner(s) of the land to which this licence is appurtenant is/are hereby authorized to divert and use water as follows:

- (a) The stream on which the rights are granted is Botanie Creek.
- (b) The point of diversion is located as shown on the attached plan.
- (c) The date from which this licence shall have precedence is July 27, 1877.
- (d) The purpose for which this licence is issued is irrigation.
- (e) The maximum quantity of water which may be diverted for irrigation is 128,689.16037 cubic metres (104.33 acre feet) per year.
- (f) The period of the year during which the water may be used is April 1 to September 30.
- (g) The land upon which the water is to be used and to which this licence is appurtenant is District Lot 45 Yale Division Yale District except Plans 39375 and 41525 of which 14.07 hectares (34.78 acres) may be irrigated.
- (h) The authorized works are a screened intake, flow measuring device, diversion structure, pipe, booster pump and sprinklers which shall be located approximately as shown on the attached plan.
- (i) The construction of the said works shall be completed and the water shall be beneficially used prior to December 31, 2016. Thereafter, the licensee shall continue to make regular beneficial use of the water in the manner authorized herein.
- (j) This licence is issued under the *Water Act* (the Act). The exercise of rights under the licence is subject to the Act and its regulations, the terms and conditions of the licence, orders under the Act and the rights of licensees whose rights have precedence on the stream. The licensee must comply with all such requirements, as well as the provisions of all other applicable enactments. In exercising rights under the licence, the licensee must exercise reasonable care to avoid damaging land, works, trees or other property, and must make full compensation to the owners for damage or loss resulting from construction, maintenance, use, operation or failure of the works.

- (k) The licensee shall install a flow measuring device to the satisfaction of an Engineer under the *Water Act*.
- (l) The licensee shall retain flow meter records for inspection upon request by an Engineer under the *Water Act*.
- (m) Any water diverted and used pursuant to this licence during the period from April 1 to September 30, must be taken from storage provided in the reservoir authorized under Conditional Water Licence C115593 or any licence issued in substitution thereof.
- (n) This Licence is issued in substitution of Conditional Water Licence C115591.

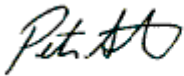

Peter Stroes R.P.F.
Assistant Regional Water Manager

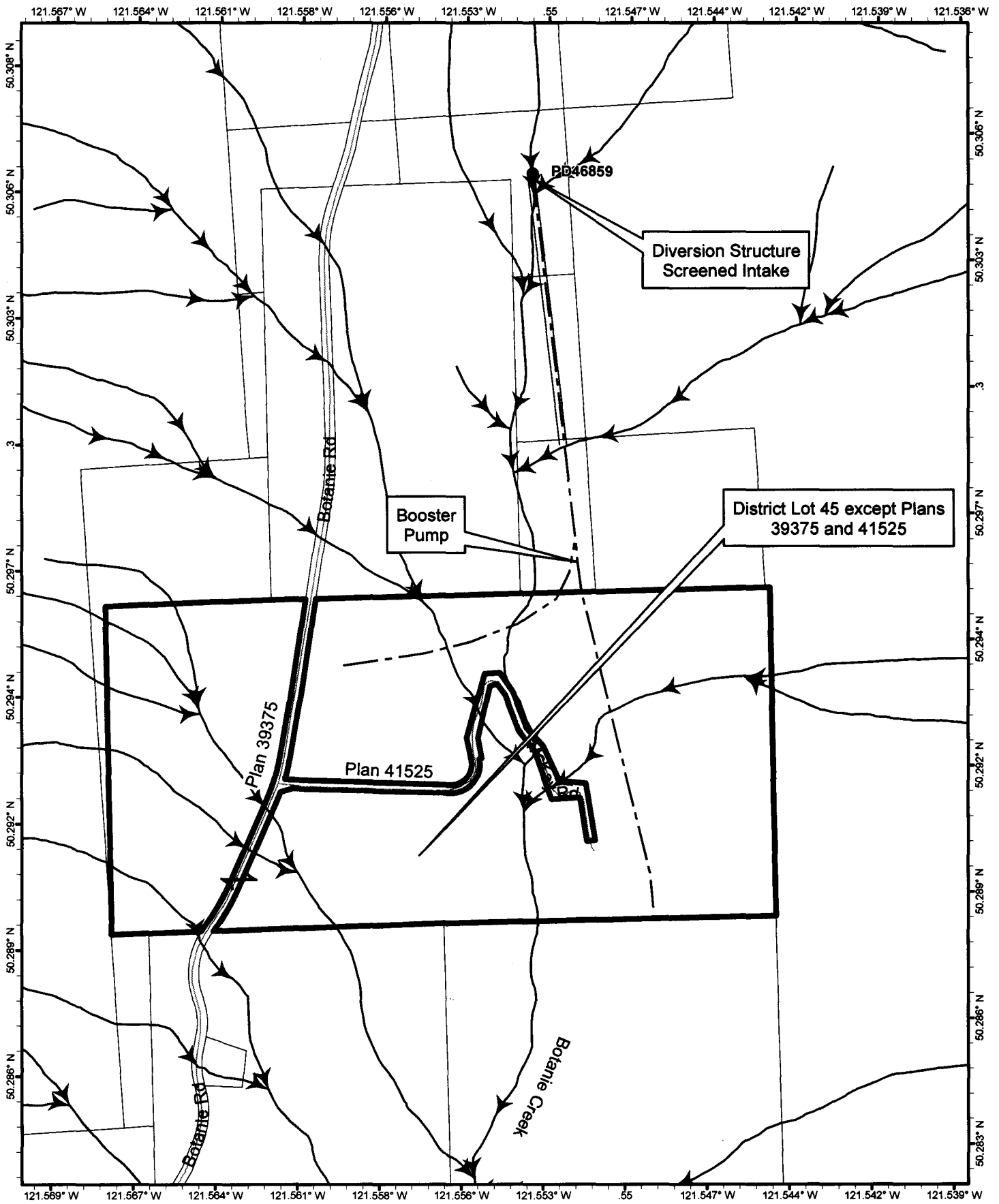

Scale: 1:12,000

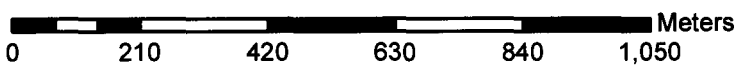

Point of Diversion: ●

Pipeline: - - - -

Direction of Flow: →

Permit Over Crown Land: = = = =

The boundaries of the land to which this licence is appurtenant are shown thus: —————

Mapsheet : 0921023

Land District : YDYG

Water District: Ashcroft

Precinct: Botanie

Signature: *P. K. S.*

Date: *April 22, 2015*



Licence: C132237 for C115591

File: 0241345

PCL#: 23445