



Province of British Columbia

Water Act

CONDITIONAL WATER LICENCE

The owner(s) of the land to which this licence is appurtenant is/are hereby authorized to divert and use water as follows:

- a) The stream on which the rights are granted is Hawkins Lake.
- b) The point of diversion is located as shown on the attached plan.
- c) The date from which this licence shall have precedence is August 5, 2014.
- d) The purpose for which this licence is issued is domestic.
- e) The maximum quantity of water which may be diverted for domestic use is 2.273 cubic metres (500 gallons) per day.
- f) The period of the year during which the water may be used is the whole year.
- g) The land upon which the water is to be used and to which this licence is appurtenant is Lot 17, District Lot 3920, Plan 19186, Lillooet District.
- h) The authorized works are screened intake, pump and pipe which shall be located approximately as shown on the attached plan.
- i) The construction of the said works shall be completed and the water shall be beneficially used prior to December 31, 2018. Thereafter, the licensee shall continue to make regular beneficial use of the water in the manner authorized herein.
- j) This licence authorizes the use of water for domestic purpose in one dwelling located approximately as shown on the attached plan.

k) This licence is issued under the Water Act (the Act). The exercise of rights under the licence is subject to the Act and its regulations, the terms and conditions of the licence, orders under the Act and the rights of licensees whose rights have precedence on the stream. The licensee must comply with all such requirements, as well as the provisions of all other applicable enactments. In exercising rights under the licence, the licensee must exercise reasonable care to avoid damaging land, works, trees or other property, and must make full compensation to the owners for damage or loss resulting from construction, maintenance, use, operation or failure of the works.

DSW

David J. Weir
Assistant Regional Water Manager

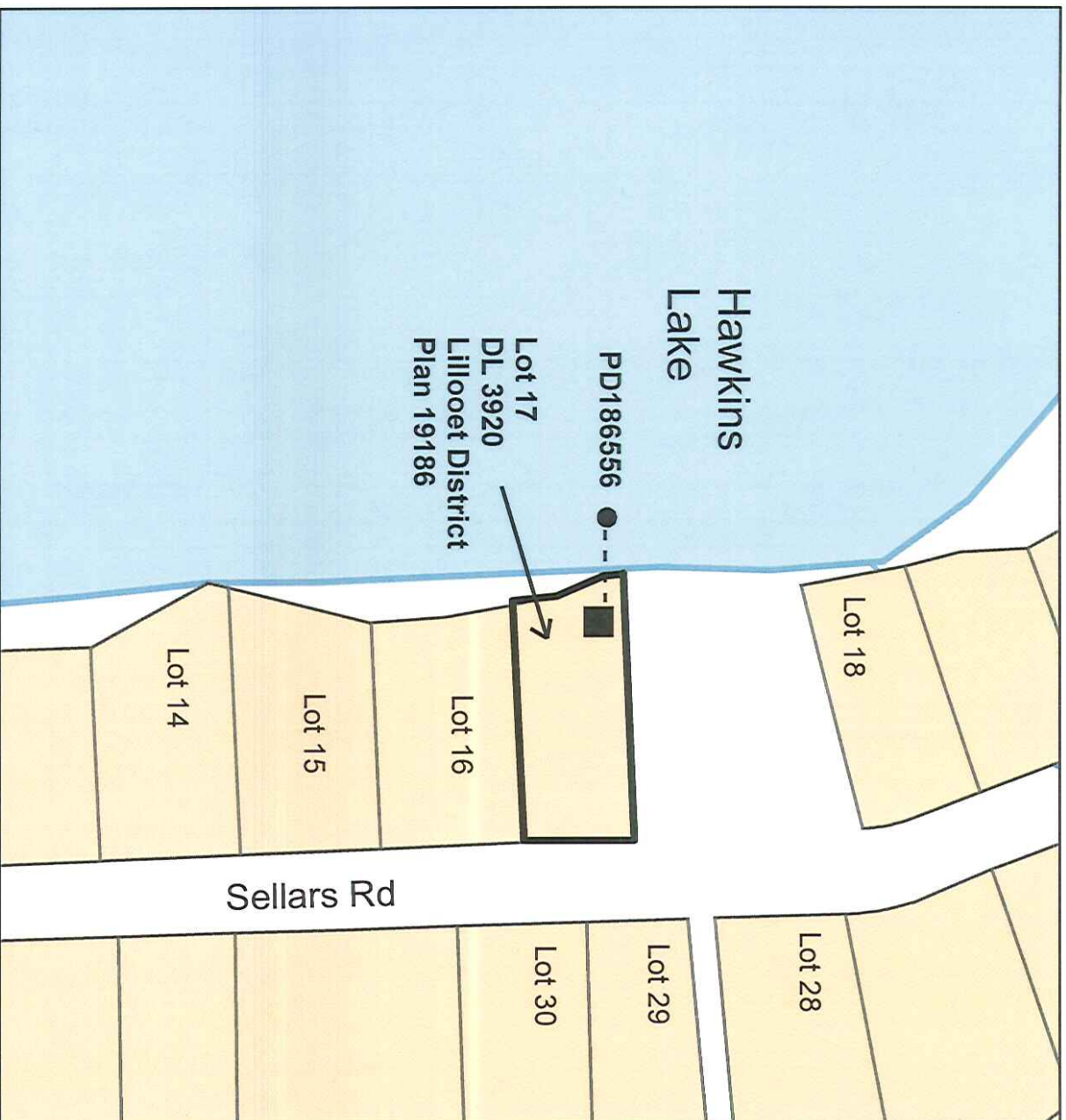

WATER DISTRICT: CARIBOO

PRECINCT: Clearwater

LAND DISTRICT: Lillooet

LEGEND:

Scale: 1:1,500

Map Number: 92.P.086

Point of Diversion: ●

Dwelling: ■

Signature:



Date: May 21, 2015

C.L. 132257

File: 5002413

The boundaries of the land to which this licence is appurtenant are shown thus: 