



# Province of British Columbia

## *Water Act*

### CONDITIONAL WATER LICENCE

The owners of the land to which this licence is appurtenant are hereby authorized to divert and use water as follows:

- a) The stream on which the rights are granted is Big Lake.
- b) The point of diversion is located as shown on the attached plan.
- c) The date from which this licence shall have precedence is February 19, 2015.
- d) The purpose for which this licence is issued is domestic.
- e) The maximum quantity of water which may be diverted is 2.273 cubic meters per day (500 gallons per day).
- f) Water may be used throughout the whole year.
- g) The land upon which the water is to be used and to which this licence is appurtenant is Lot 14 District Lot 170 Cariboo District Plan BCP26474.
- h) The authorized works are diversion structure, screened intake, pipe and pump which shall be located approximately as shown on the attached plan.
- i) The construction of the said works shall be completed and the water shall be beneficially used prior to December 31, 2018. Thereafter, the licensee shall continue to make regular beneficial use of the water in the manner authorized herein.
- j) This licence is issued under the Water Act (the Act). The exercise of rights under the licence is subject to the Act and its regulations, the terms and conditions of the licence, orders under the Act and the rights of licensees whose rights have precedence on the stream. The licensee must comply with all such requirements, as well as the provisions of all other applicable enactments. In exercising rights under the licence, the licensee must exercise reasonable care to avoid damaging land, works, trees or other property, and must make full compensation to the owners for damage or loss resulting from construction, maintenance, use, operation or failure of the works.

- k) This licence authorizes the use of water for domestic purpose in one dwelling located approximately as shown on the attached plan.



David J. Weir  
Assistant Regional Water Manager

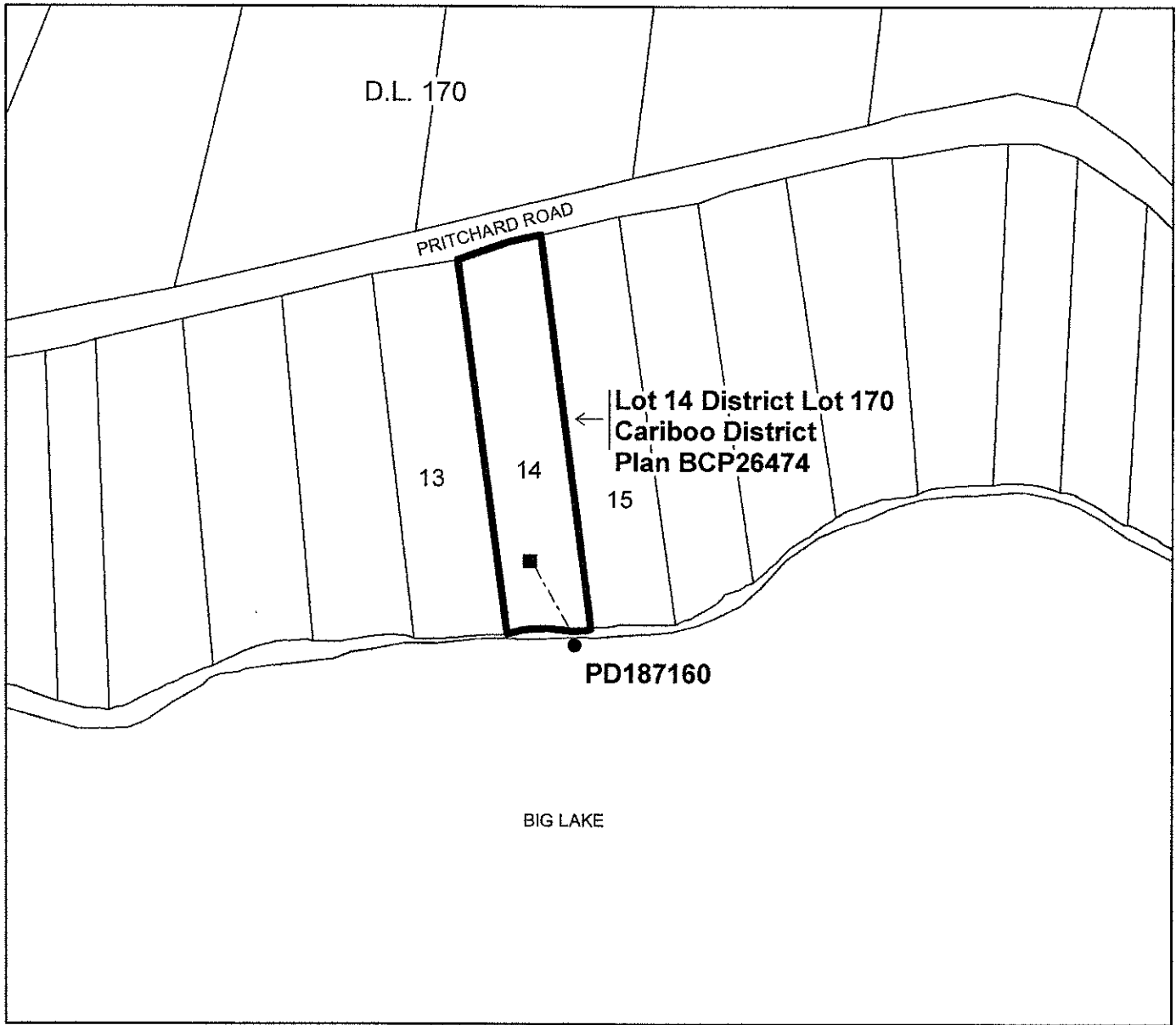

**Legend**

Scale: 1:5,000  
 Map Number: 93.A.032  
 Point of Diversion: ● PD187160  
 Dwelling: ■  
 Pipe: -----

The boundaries of the land to which this licence is appurtenant are shown thus: **—————**

**Water District:** CARIBOO  
**Precinct:** QUESNEL RIVER  
**Land District:** CARIBOO

Signature: *[Handwritten Signature]*  
 Date: November 4<sup>th</sup> 2015

CL: C132398  
 File: 5002453