



Province of British Columbia

Water Act

CONDITIONAL WATER LICENCE

The holder of Placer Lease No. 362505 to which this licence is appurtenant is hereby authorized to divert and use water as follows:

- a) The stream on which the rights are granted is Shepard Creek.
- b) The point of diversion is located as shown on the attached plan.
- c) The date from which this licence shall have precedence is January 8, 2015.
- d) The purpose for which this licence is issued is mining (Placer).
- e) The maximum quantity of water which may be diverted for placer mining is 209,304 cubic metres per year at a rate not to exceed 0.0600 cubic metres per second.
- f) The period of the year during which the water may be used is May 1 to October 15.
- g) The land upon which the water is to be used and to which this licence is appurtenant is Placer Lease No. 362505.
- h) The authorized works are diversion structure with screened intake, pump, and pipe which shall be located within Placer Lease No. 362505, Caribou Mining District.
- i) The construction of the said works shall be completed and the water shall be beneficially used prior to December 31, 2018. Thereafter, the licensee shall continue to make regular beneficial use of the water in the manner authorized herein.
- j) This licence is issued under the Water Act (the Act). The exercise of rights under the licence is subject to the Act and its regulations, the terms and conditions of the licence, orders under the Act and the rights of licensees whose rights have precedence on the stream. The licensee must comply with all such requirements, as well as the provisions of all other applicable enactments. In exercising rights under the licence, the licensee must exercise reasonable care to avoid damaging land, works, trees or other property, and must make full compensation to the owners for damage or loss resulting from construction, maintenance, use, operation or failure of the works.

k) This licence is valid only as long as the Placer Lease No. 362505 is in good standing.

DJW

David J. Weir
Assistant Regional Water Manager

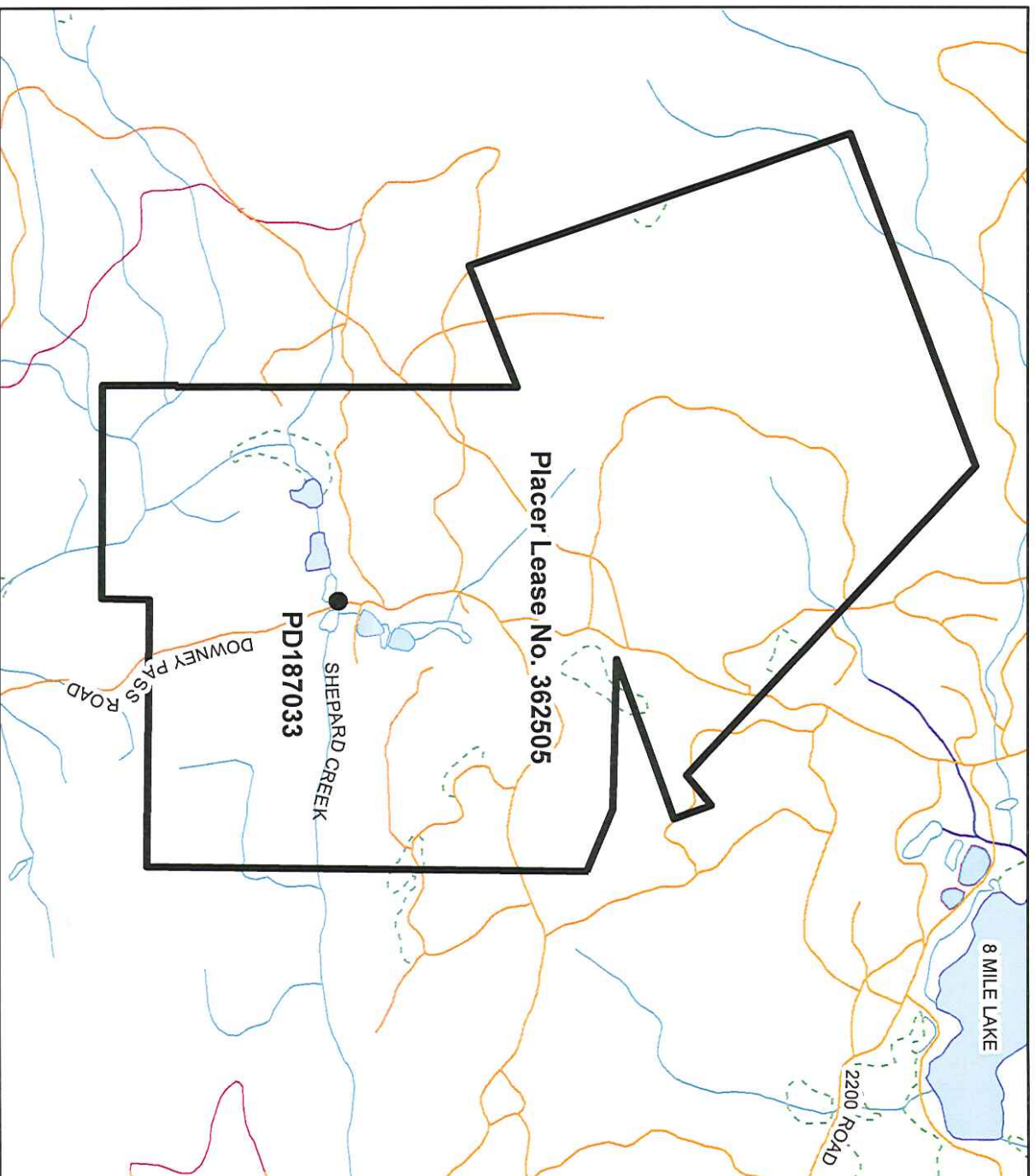

Legend

Scale: 1:12,000

Map Sheet: 93.H.023

Point of Diversion: ● PD187033

The boundaries of the land
to which this licence is appurtenant
are shown thus: 

Water District: QUESNEL

Precinct: COTTONWOOD

Land District: CARIBOO

Signature: 

Date: July 20th 2015

CL: 132418

File: 5002444

