



# Province of British Columbia

## *Water Act*

### CONDITIONAL WATER LICENCE

The owner(s) of the land to which this licence is appurtenant is/are hereby authorized to divert and use water as follows:

- a) The stream on which the rights are granted is Bridge Lake.
- b) The point of diversion is located as shown on the attached plan.
- c) The date from which this licence shall have precedence is March 10th, 1971.
- d) The purpose for which this licence is issued is domestic.
- e) The maximum quantity of water which may be diverted for domestic use is 2.273 cubic metres (500 gallons) per day.
- f) The period of the year during which the water may be used is the whole year.
- g) The land upon which the water is to be used and to which this licence is appurtenant is Lot 6, District Lot 1450, Lillooet District, Plan 34504.
- h) The authorized works are screened intake, pump and pipe which shall be located approximately as shown on the attached plan.
- i) The construction of the said works has been completed and the water is being used. The licensee shall continue to make regular beneficial use of the water in a manner authorized herein.
- j) This licence is issued under the Water Act (the Act). The exercise of rights under the licence is subject to the Act and its regulations, the terms and conditions of the licence, orders under the Act and the rights of licensees whose rights have precedence on the stream. The licensee must comply with all such requirements, as well as the provisions of all other applicable enactments. In exercising rights under the licence, the licensee must exercise reasonable care to avoid damaging land, works, trees or other property, and must make full compensation to the owners for damage or loss resulting from construction, maintenance, use, operation or failure of the works.

- k) This licence authorizes the use of water for domestic purpose in one dwelling located approximately as shown on the attached plan.
- l) This Licence is issued in substitution of Conditional Water Licence No. 70960, in part.

*DJW*

David J. Weir  
Assistant Regional Water Manager

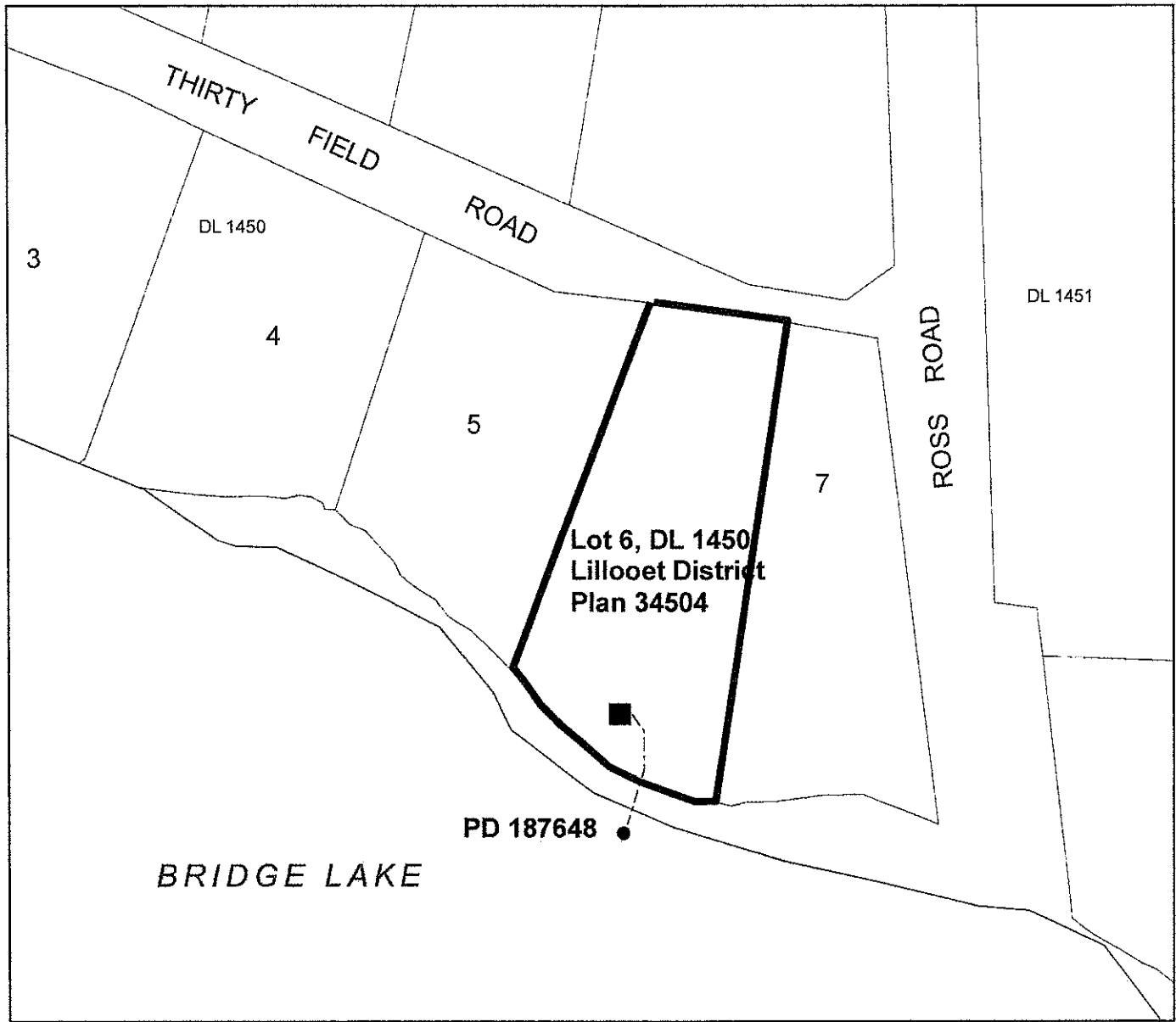

**Water District:** CARIBOO  
**Precinct:** CLEARWATER  
**Land District:** LILLOOET

Signature: *PTU*

Date: Nov 24<sup>th</sup> 2015

Scale: 1:2,000  
Map Number: 92.P.057

CL:132600 for CL 70960, in part  
File: 5002522

Point of Diversion: ●

Pipe: -----

Dwelling: ■

The boundaries of the land to which this licence is appurtenant are shown thus: 